



188a Lichfield Road,  
Sutton Coldfield, B74 2TX

**Offers in the Region Of £200,000**



## Offers in the Region Of £200,000



Located just moments from the vibrant Mere Green Centre—recently transformed with a range of shops, restaurants, and amenities—this stylish second-floor apartment offers a superb opportunity for both first-time buyers and investors.

Excellent transport connections are nearby, including Four Oaks train station and regular bus routes. Set within a well-regarded development, the apartment comes with two allocated parking spaces behind secure entry gates. A communal entrance with intercom access leads to the second floor via staircase.

Once inside, you're welcomed by a hallway with a generous storage cupboard. The heart of the home is an open-plan living and dining area, featuring a Juliet balcony that brings in plenty of natural light, and a modern fitted kitchen with integrated appliances.

The property offers two well-proportioned double bedrooms, with the main bedroom benefitting from built-in wardrobes. A sleek bathroom fitted with a white suite completes the layout.





## Property Specification



### Agent's Note:

Every care has been taken with the preparation of these Sales Particulars but they are for general guidance only and complete accuracy cannot be guaranteed. If there is any point which is of particular importance, professional verification should be sought. The mention of any fixtures, fittings and/or appliances does not imply they are in full efficient working order as they have not been tested. All dimensions are approximate. Photographs are reproduced for general information and it cannot be inferred that any item shown is included in the sale. These Sales Particulars do not constitute a contract or part of a contract.  
Came on the market:

Hall  
6.98m (22'11") x 1.27m (4'2")

Open Plan Living Room/Kitchen  
5.31m (17'5") x 3.73m (12'3")

Bedroom 1  
3.96m (13') x 2.69m (8'10")

Bedroom 2  
3.12m (10'3") x 2.34m (7'8")

Bathroom

Two Allocated Parking Spaces

### Viewer's Note:

Services connected: Gas, Electric, Water, Drainage  
Council tax band: C  
Tenure: 125 years remaining, from 2011  
Ground Rent: £333.12  
Service Charge: £1461.11

# Floor Plan

*This floor plan is not drawn to scale and is for illustration purposes only*

## Energy Efficiency Rating

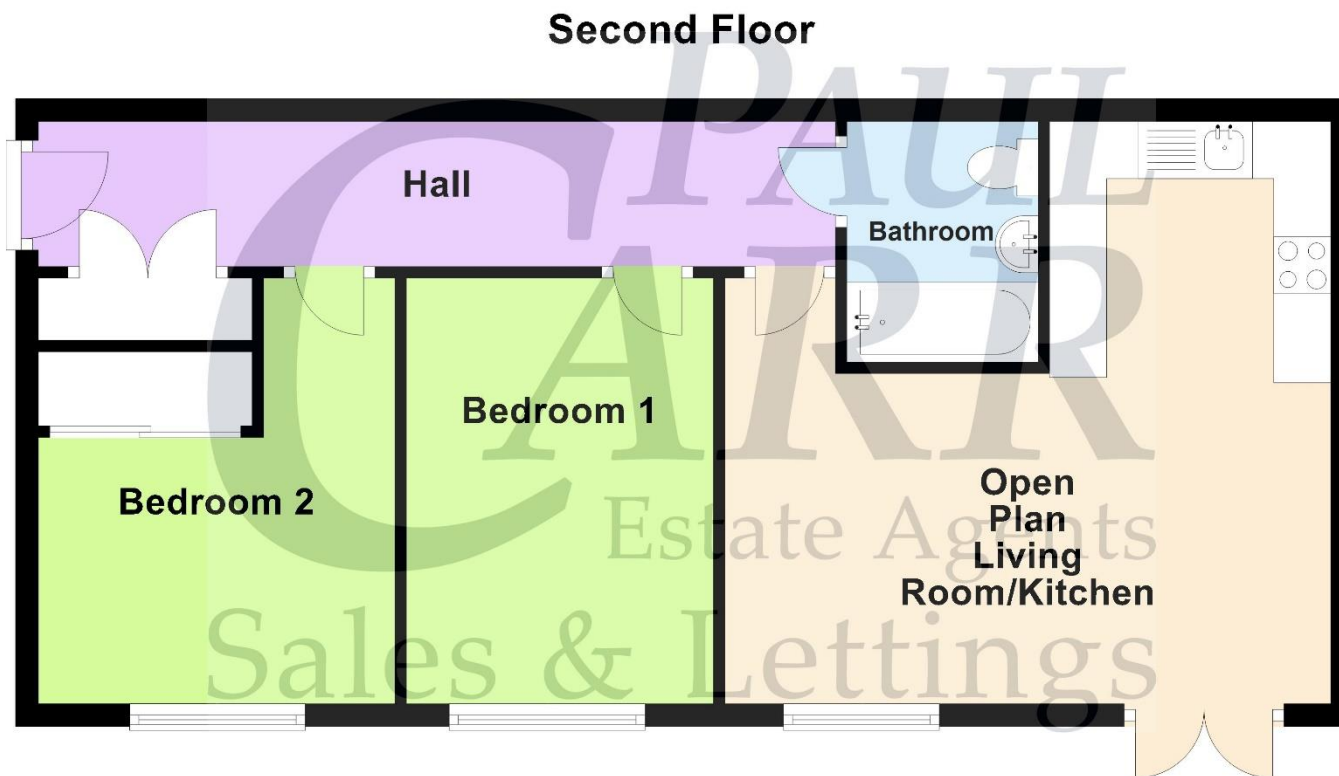

## Map Location

