



RICHMONDS

Adams Close, Grange Park, Southampton, SO30 2NB

OIEO £340,000

A three-bedroom, semi-detached house positioned on an enviable plot in the Grange Park area of Hedge End. This lovely property has been tastefully decorated in a light and modern style throughout.

Features include an entrance hallway, downstairs cloakroom and lounge with Adams style fireplace. In addition, there is a modern kitchen/breakfast room with built-in appliances and a conservatory with access to the attractive garden. Upstairs has three bedrooms and two bathrooms, one of which is en-suite.

The enclosed rear garden has a degree of privacy with shrub borders and a paved seating area. The front of the property has off-road parking as well as a garage.

This is a wonderful family home with well-regarded schools and plenty of green spaces and sports facilities nearby. The property is located close to local shops and the various retail units in the Hedge End area. Transport links are also excellent as Hedge End Railway Station is within walking distance and Junction 7 of the M27 is close by.

Other Information

Tenure: Freehold

Approximate Age: Built circa.1995

Heating: Gas central heating (boiler replaced a few years ago)

Windows: Double glazing

Loft: Partially boarded

Energy Rating: D

Sellers Position: Found a property

Local Information:

Council Tax: D

Local Authority: Eastleigh Borough Council



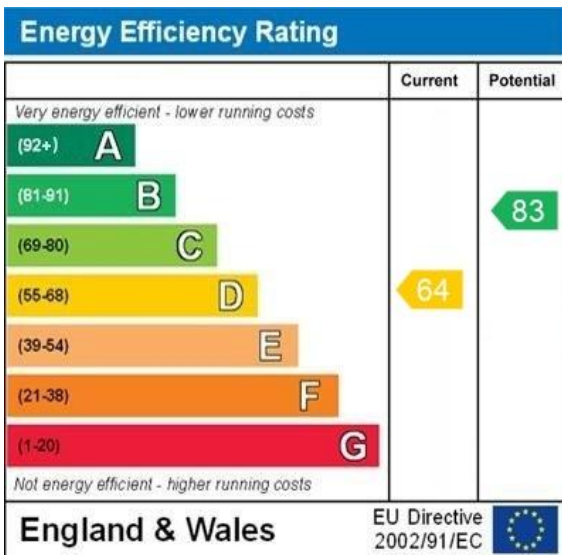

WWW.EPC4U.COM

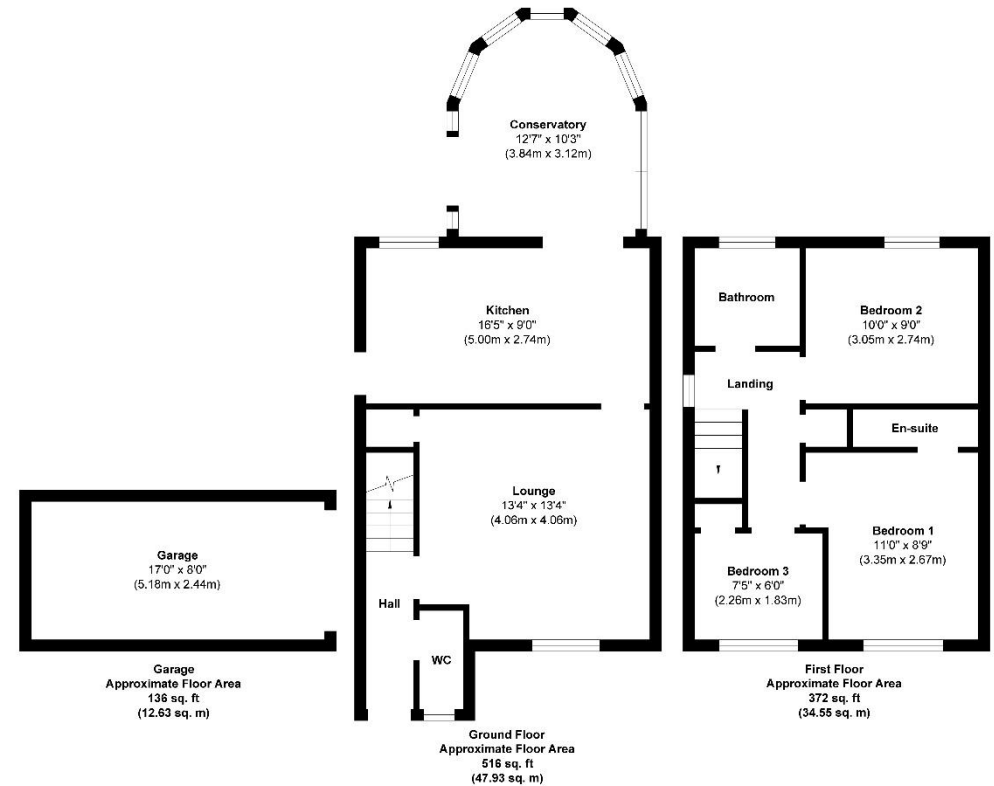

Approx. Gross Internal Floor Area 1024 sq. ft / 95.11 sq. m
 Illustration for identification purposes only, measurements are approximate, not to scale.
 Produced by Elements Property

Agents Note: The sellers of the property have provided the above information to us and we are therefore reliant on them providing the correct information. The floor plan and sizes are to be used as a guide only. Please check room sizes prior to ordering carpets or furniture. If you require confirmation on any particular point for specific purposes please contact our office for further information. If you have other questions about this property, please telephone **01489 789933**

R545 Ravensworth 01670 713330

Lankester House, 1 Freegrounds Road, Hedge End, Southampton SO30 0HG • 01489 789933 • admin@richmondsproperty.co.uk

