



RICHMONDS

Waxwing House, Greenfinch Road, Whiteley, PO15 7RT

Offers Over £200,000

An exceptionally well presented and deceptively spacious one-bedroom apartment situated in the highly desirable Whiteley area. One-bedroom properties of this size and situated within such proximity to the business area of Whiteley are rare, making them a perfect purchase for homeowners and investors alike.

The property comprises a spacious open plan living area offering a generously sized lounge area with Juliette balcony, a designated dining space and an open plan kitchen. The kitchen boasts a range of eye and base level units with integrated appliances. There is a tastefully decorated double bedroom with space for wardrobes and other storage. The bathroom suite is a white finish comprising low level w/c, wash hand basin, bath with shower over and a heated towel rail. Additionally, there is an allocated parking space and plenty of additional on-street parking arrangements.

Externally, there are various communal parkland areas for the benefit of the residents in the area, and transport links to Whiteley shopping outlet and further afield via the M27 motorway.

Other Information

Tenure: Leasehold

Length of Lease: 999 years from new, approximately 997 years remaining

Maintenance Charge of £160 per month and Ground Rent of £12 per year (on all charges, please seek verification from your solicitor)

Heating: Gas central heating

Windows: UPVC double glazed

Parking: Allocated parking space

Energy Rating: B

Sellers Position: Searching for a property

Local Information:

Council Tax: B

Local Authority: Winchester City Council



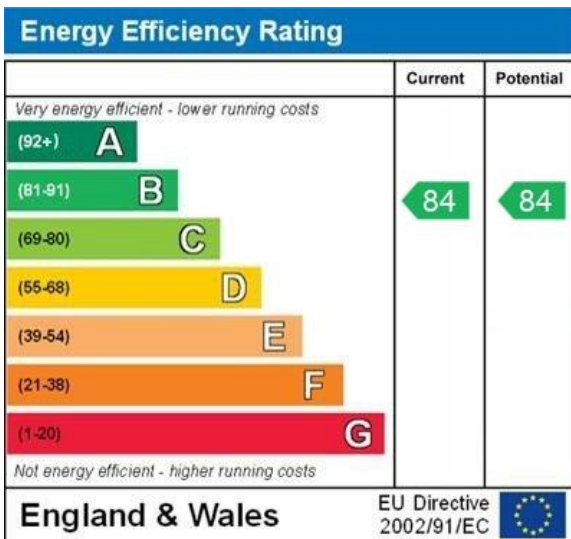

WWW.EPC4U.COM

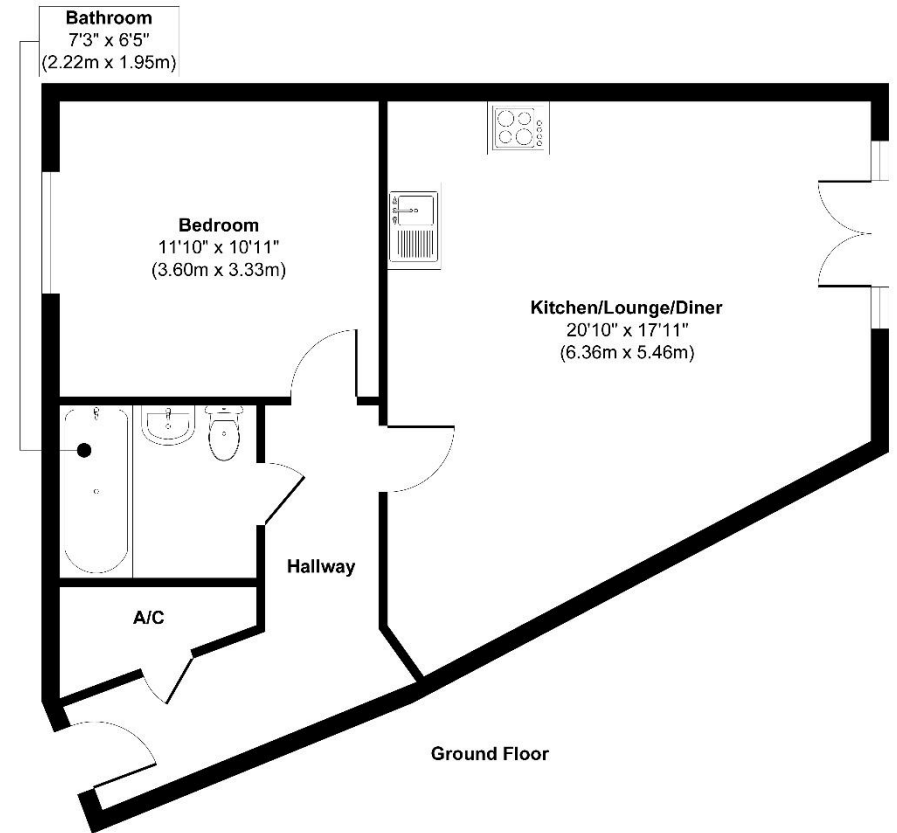

Approx. Gross Internal Floor Area 583 sq. ft / 54.10 sq. m

Illustration for identification purposes only, measurements are approximate, not to scale.

Produced by Elements Property

Agents Note: The sellers of the property have provided the above information to us and we are therefore reliant on them providing the correct information. The floor plan and sizes are to be used as a guide only. Please check room sizes prior to ordering carpets or furniture. If you require confirmation on any particular point for specific purposes please contact our office for further information. If you have other questions about this property, please telephone **01489 789933**

R545 Ravensworth 01670 713330

Lankester House, 1 Freegrounds Road, Hedge End, Southampton SO30 0HG • 01489 789933 • admin@richmondsproperty.co.uk

