



RICHMONDS
FOR SALE

RICHMONDS

39 Shafford Meadows, Hedge End, Southampton, SO30 4SU

£215,000

A 2-bedroom, second floor apartment with open plan living and decorated in a light and natural style throughout.

Features include a family bathroom, en-suite to the master bedroom and modern kitchen with integrated appliances. This lovely apartment also benefits from a balcony off the living area.

Outside, there is one parking space with a permit which comes with the property although visitor parking is also available. There is a communal bin storage/bike shed.



Other Information

Tenure: Leasehold (125 years from 2013)

Charges: Maintenance - £1250.00 per annum Ground Rent - £250.00 per annum TBC by owner (on all charges, please seek verification from your solicitor)

Approximate Age: Built 2013

Loft: Not inspected

Heating: Gas central heating

Windows: Double glazing

Energy Rating: B (previous report) New rating TBC

Sellers Position: Looking for a local property

Local Information:

Council Tax: B

Local Authority: Eastleigh Borough Council



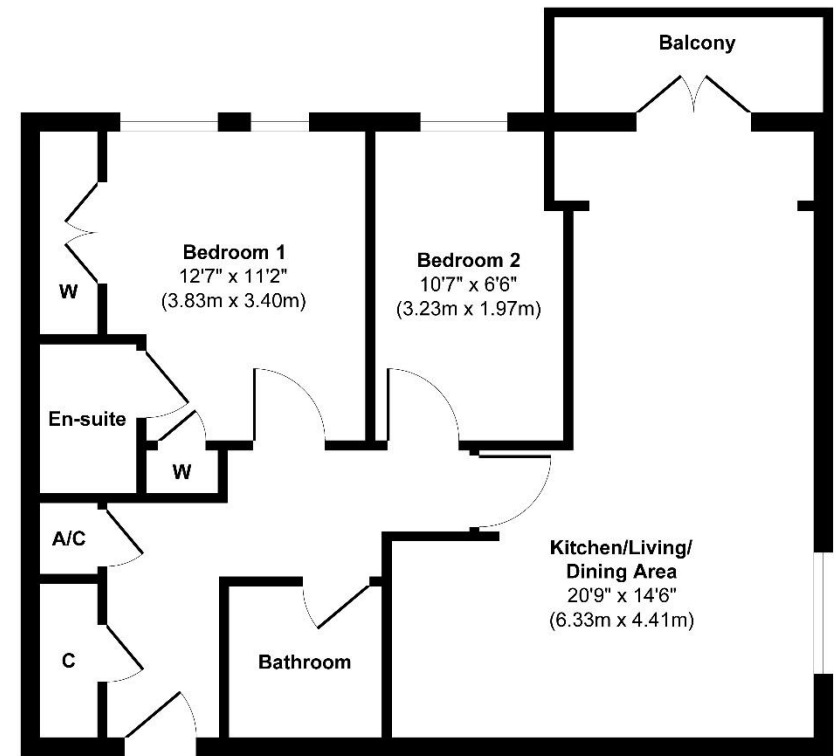

Floor Plan

Approx. Gross Internal Floor Area 550 sq. ft / 51.17 sq. m

Illustration for identification purposes only, measurements are approximate, not to scale.

Produced by Elements Property

Agents Note: The sellers of the property have provided the above information to us and we are therefore reliant on them providing the correct information. The floor plan and sizes are to be used as a guide only. Please check room sizes prior to ordering carpets or furniture. If you require confirmation on any particular point for specific purposes please contact our office for further information. If you have other questions about this property, please telephone **01489 789933**

R545 Ravensworth 01670 713330

Lankester House, 1 Freegrounds Road, Hedge End, Southampton SO30 0HG • 01489 789933 • admin@richmondsproperty.co.uk

