



20

GIVE WAY

RICHMONDS

Mayfield View, Weston Lane, Southampton, SO19 9HL

£190,000

A modern ground floor apartment with private garden located in Weston close to local shops and park. There is a large open plan living area which incorporates a lounge/dining area and a modern kitchen with integrated appliances.

In addition, there are two bedrooms, both with built-in wardrobes and an en-suite to the main bedroom. There is also a further bathroom.

This lovely apartment has been tastefully decorated throughout in a light and neutral style. Other benefits include double glazing, gas central heating, and no forward chain.

Other Information

Tenure: Leasehold

Length of Lease: Originally 125 years with approx. 112 years remaining

Maintenance Charge: Approx. £2400 per annum

Ground rent: Approx. £250 per annum (on all charges, please seek verification from your solicitor)

Approximate Age: Built 2011

Heating: Gas central heating

Windows: Double glazing

Energy Rating: TBC

Sellers Position: No forward chain

Local Information:

Council Tax: B

Local Authority: Southampton City Council



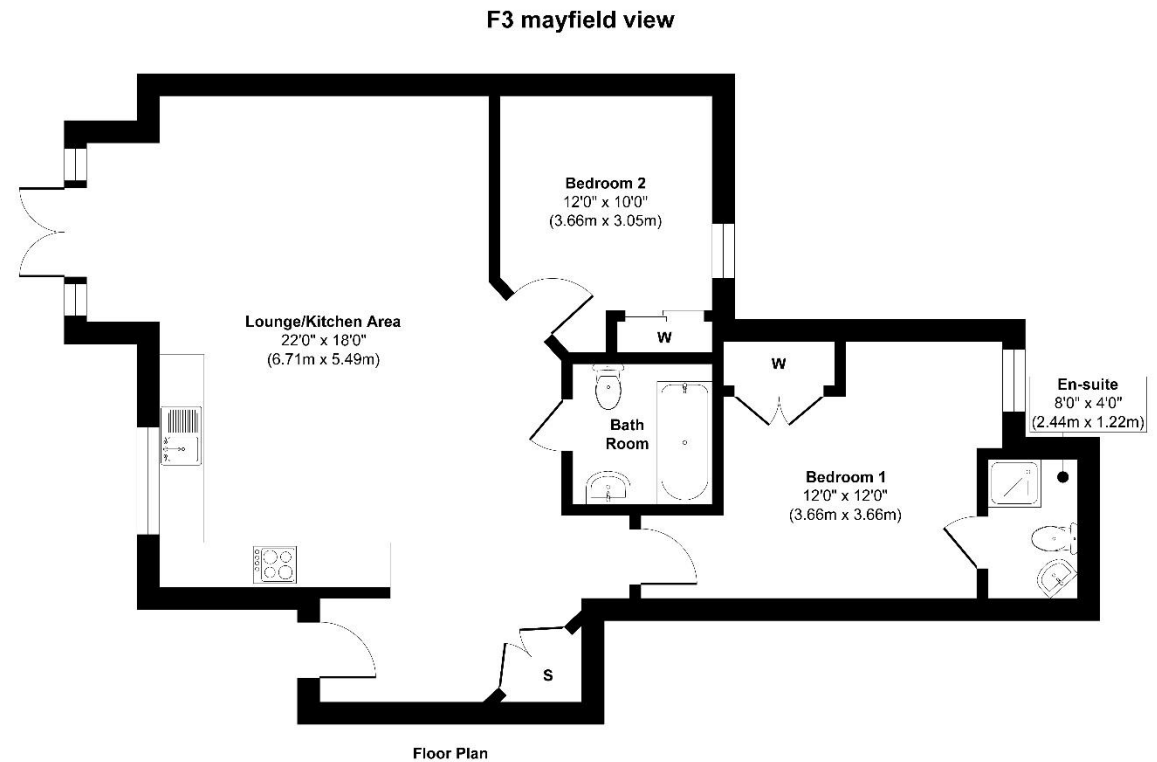

Approx. Gross Internal Floor Area 806 sq. ft / 74.87 sq. m

Illustration for identification purposes only, measurements are approximate, not to scale.
Produced by Elements Property

Agents Note: The sellers of the property have provided the above information to us and we are therefore reliant on them providing the correct information. The floor plan and sizes are to be used as a guide only. Please check room sizes prior to ordering carpets or furniture. If you require confirmation on any particular point for specific purposes please contact our office for further information. If you have other questions about this property, please telephone **01489 789933**

R545 Ravensworth 01670 713330

Lankester House, 1 Freegrounds Road, Hedge End, Southampton SO30 0HG • 01489 789933 • admin@richmondsproperty.co.uk

