



RICHMONDS

Oaktree Gardens, Hedge End, Southampton, SO30 4AP

£435,000

A 3-bedroom, detached bungalow set within a quiet cul-de-sac in the heart of Hedge End village. The property is available with no onward chain and comprises of a spacious entry hall with storage cupboards, a lounge/diner, kitchen/breakfast room, 3 bedrooms and a shower room. Additionally, there is a low maintenance rear garden, off-street parking and a garage. The property is presented in very good order.

Oaktree Gardens is located off the ever-popular Granada Road and is just a short walk to Hedge End village which boasts a range of shops and coffee shops, doctor surgeries, dentists and opticians. The transport links from nearby St. Johns Road make further travel extremely convenient.

Other Information

Tenure: Freehold

Heating: Gas central heating (boiler located in the kitchen)

Windows: UPVC double glazing

Energy Rating: To follow

Sellers Position: No onward chain

Local Information:

Council Tax: D

Local Authority: Eastleigh Borough Council



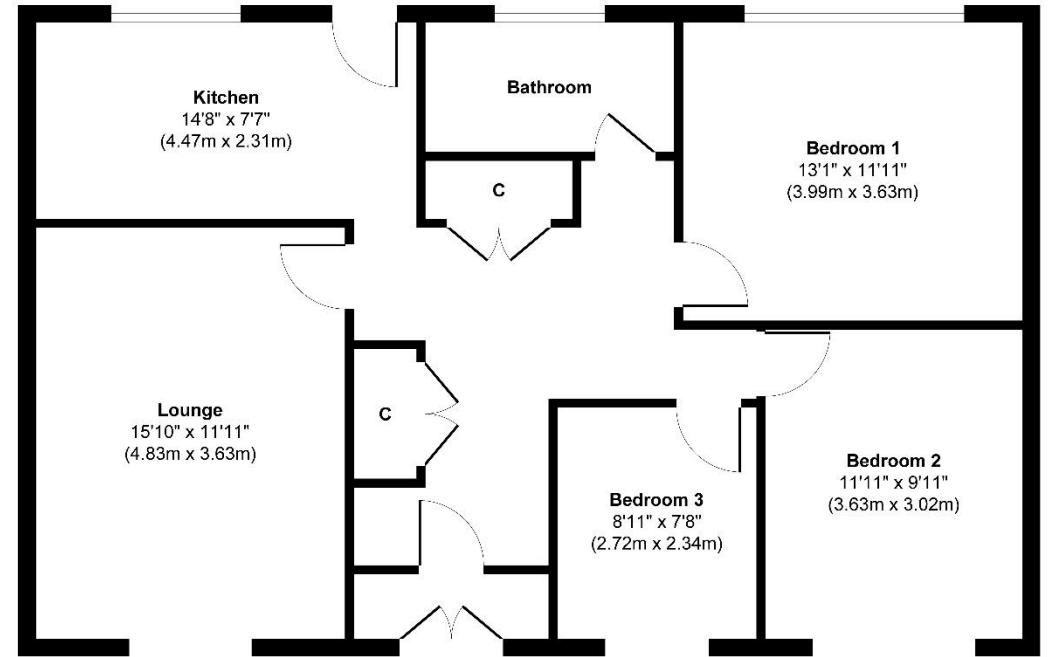

Floor Plan

Approx. Gross Internal Floor Area 902 sq. ft / 83.79 sq. m

Illustration for identification purposes only, measurements are approximate, not to scale.
Produced by Elements Property

Agents Note: The sellers of the property have provided the above information to us and we are therefore reliant on them providing the correct information. The floor plan and sizes are to be used as a guide only. Please check room sizes prior to ordering carpets or furniture. If you require confirmation on any particular point for specific purposes please contact our office for further information. If you have other questions about this property, please telephone **01489 789933**

R545 Ravensworth 01670 713330

Lankester House, 1 Freegrounds Road, Hedge End, Southampton SO30 0HG • 01489 789933 • admin@richmondsproperty.co.uk

