



5 Cherry Tree Cottages High Street, Hook, Goole, DN14 5PH

£165,000

EPC: D

Located in a set back position off the High Street in Hook is this mid terraced cottage. Offering two double bedrooms the property would make a fantastic starter home, investment property or a home for a young family or couple. A viewing is highly recommended to appreciate the property on offer and the location.

- Mature mid terrace cottage
- Two double bedrooms
- Modern fitted dining kitchen
- 4 piece bathroom suite
- Located in set back position from the High Street
- Fantastic starter home
- Ideal investment opportunity
- Enclosed garden
- Viewing highly recommended

ENTRANCE HALL

2'8" x 3'5"

uPVC door provides access into the garden. Stair way leading to the first floor. One central heating radiator.

LOUNGE

12'4" x 14'5"

Under stairs storage cupboard. One central heating radiator.

DINING KITCHEN

11'7" x 15'1"

uPVC door leads to the front of the property. A range of fitted base and wall units with high gloss fronts having laminated worktops and tiled work surrounds. The units incorporate a stainless steel single drainer sink, a four ring ceramic hob with an electric oven under and a cooker hood over. Plumbing for an automatic washing machine. One central heating radiator.

LANDING

2'9" x 13'1"

Cupboard housing the gas central heating boiler.

BEDROOM ONE

12'7" x 11'3"

Over stairs storage cupboard with loft access. One central heating radiator.

BEDROOM TWO

11'6" x 8'11"

One central heating radiator.

BATHROOM

11'0" x 5'11"

A four piece white suite comprising a shower cubicle with a mains fed shower, a bath, wash hand basin and a low flush WC. One central heating radiator.

GARDENS

There is a pathway providing right of access to the front entrance door with a paved area for bin storage, the pathway is shared with the neighbouring properties. (only 4 properties in the block).

To the rear of the property there is a fully enclosed lawned garden with a timber gate and further right of access that leads onto the High Street.

Ground Floor

Approx. 37.0 sq. metres (397.8 sq. feet)

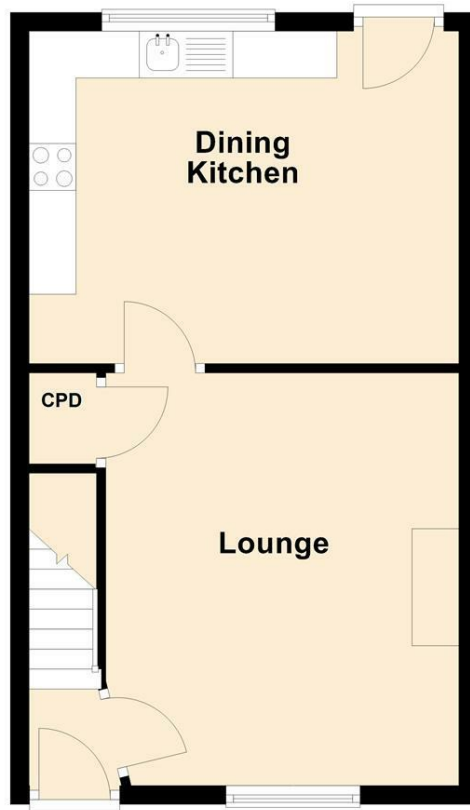

Total area: approx. 73.9 sq. metres (795.7 sq. feet)

First Floor

Approx. 37.0 sq. metres (397.8 sq. feet)

