



12 Malvern Road, Goole, DN14 6HX

£85,000

EPC: D

****VIEWINGS AND OFFERS NOW CLOSED**** This two bedroom end town house is located in a well established residential area. The property requires a full programme of updating works and therefore would be an ideal purchase for an investor. The property has gardens to the front and rear and a viewing is an absolute must to appreciate the potential on offer. No upward chain.

- Two bedroom end town house
- Updating required
- Ideal investment opportunity
- Entrance hall, lounge, kitchen
- Landing, two bedrooms, bathroom
- Double glazed windows
- Gardens to front and rear
- Located in well established residential area
- Viewing recommended to appreciate the potential on offer
- No upward chain

DESCRIPTION

This two bedroom end town house incorporates double glazed windows and offers accommodation comprising;

ENTRANCE HALL

4'7" x 4'3"

Aluminium framed entrance door. Stairs leading to the first floor. Wall mounted heater.

LOUNGE

12'11" x 11'9" max.

Wall mounted gas fire. Coving to the ceiling.

KITCHEN

7'10" x 14'3"

A range of fitted base and wall units with laminated worktops and tiled work surrounds. The units incorporate a cream one and half bowl single drainer sink, a four ring gas hob and an integrated oven. Under stairs storage cupboard. Coving to the ceiling. Aluminium framed door to the side of the property.

LANDING

6'0" x 2'6"

BEDROOM ONE

12'4" x 11'8"

To the front elevation. Fitted wardrobes along one wall. Over stairs storage cupboard. Wall mounted heater.

BEDROOM TWO

8'6" x 8'5"

To the rear elevation. Fitted wardrobes along one wall.

BATHROOM

5'7" x 6'1"

A white suite comprising an enamel bath, a wash hand basin and low flush WC. Tiled walls. Wall mounted electric heater.

GARDENS

To the front of the property there is a lawned garden with a concrete pathway which leads to the front door and extends along the side of the property to the rear garden through a metal side gate.

To the rear of the property there is a fully enclosed garden with mature trees and bushes and there is a timber garden shed located at the bottom of the garden.

Ground Floor

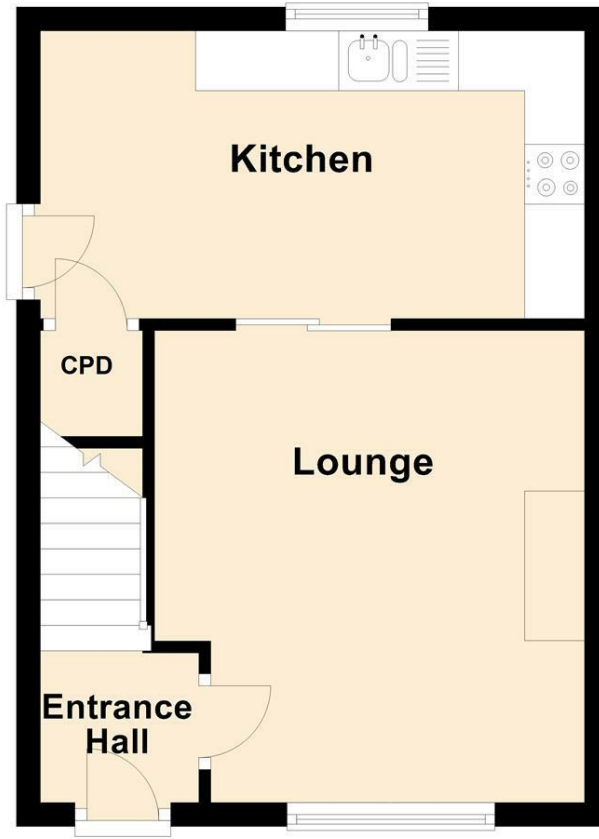

First Floor







