



36 Gordon Street, Goole, DN14 6SG

£85,000

EPC: D

This mature mid terrace house is located within walking distance of the town centre and would make a fantastic starter home or buy to let investment. Offering two bedrooms, two reception rooms, kitchen and bathroom the property offers great potential for the purchaser. Marketed with vacant possession.

- Mature mid terrace house
- Two double bedrooms
- Two reception rooms
- Entrance hall
- Fitted kitchen
- Gas central heating
- Within walking distance of the town centre
- Ideal starter home or investment property
- Enclosed yard and brick built store
- No upward chain!

DESCRIPTION

This two bedroom mature mid terrace house incorporates gas central heating and uPVC double glazing and offers accommodation comprising;

ENTRANCE HALL

2'11" x 14'7"

uPVC entrance door. Stairway leading to the first floor. One central heating radiator.

LOUNGE

9'10" x 11'5"

A tiled hearth. Coving to the ceiling. One central heating radiator.

LIVING ROOM

13'3" x 12'2"

A fire surround with a marble inset and tiled hearth. Under stairs storage cupboard. Coving to the ceiling. One central heating radiator.

KITCHEN

6'11" x 10'5"

A range of fitted base and wall units with laminate fronts having laminated worktops and tiled work surrounds. The units incorporate a stainless steel single drainer sink. Plumbing for an automatic washing machine. Coving to the ceiling. One central heating radiator. uPVC door leads to the rear of the property.

LANDING

2'4" x 2'7"

BEDROOM ONE

12'11" x 11'4"

To the front elevation. A range of fitted bedroom furniture to include wardrobes, drawers, overhead storage, bedside cabinets and display units. Coving to the ceiling. One central heating radiator.

BEDROOM TWO

12'2" x 13'1"

To the rear elevation. Over stairs storage cupboard. One central heating radiator.

BATHROOM

7'2" x 11'0"

A white suite comprising a bath, a vanity wash hand basin with storage under and a low flush WC with a tiled surround. Fitted storage cupboards. Wall mounted gas central heating boiler. Coving to the ceiling. One central heating radiator.

OUTSIDE

To the rear of the property there is an enclosed concrete yard with a timber gate that leads onto the rear service lane. Brick built store.

Ground Floor

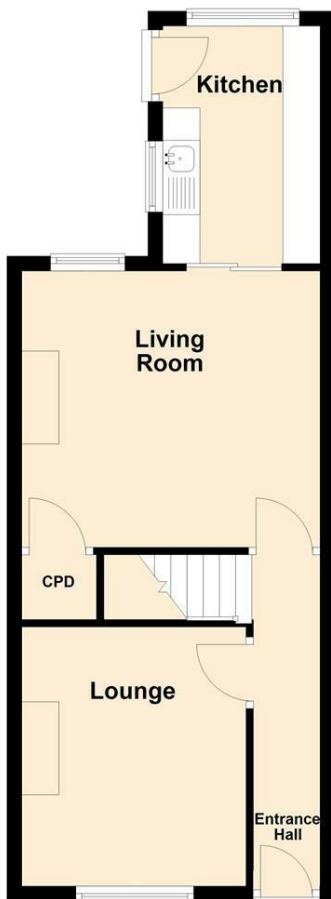

First Floor

