



1 Oxford Street, Gloucester, Gloucestershire, GL1 3EG

£210,000

🛏️ | 3

🛋️ | 2

🛁 | 1

Farr & Farr Sales Lettings 

**1 Oxford Street, Gloucester,
Gloucestershire, GL1 3EG**

£210,000

This characterful property sits in a central location in Gloucester and within easy reach of the city centre. Whilst it requires some modernisation, the property presents an excellent opportunity to create an attractive home or an investment property.

The front door opens into a small entrance hall and through to a dining room which opens into the kitchen. Stairs lead from the dining room to a cellar. Off the entrance hall, the living room has an attractive arched window and French doors to a courtyard garden.

Stairs lead to the first floor landing with two double bedrooms and a third single bedroom. A small bathroom completes the property.

Available with no onward chain, this property presents an exciting opportunity to a prospective buyer.

www.farrandfarr.co.uk

Living Room 10' 10" x 12' 10" (3.3m x 3.91m)

Double glazed arched window to front. French doors to side. Carpet. Radiator.

Kitchen 9' 1" x 12' 10" (2.77m x 3.91m)

Double glazed window to front and side. Range of wall base and drawer units. Stainless steel sink with draining board and mixer tap. Four ring gas hob. Fitted oven. Combi boiler.

Dining Room 10' 2" x 12' 10" (3.1m x 3.91m)

Double glazed arched window to front. Feature fireplace. Radiator. Laminate flooring. Access to cellar.

First Floor Landing

Carpet. Radiator.

Bedroom One 11' 0" x 12' 10" (3.36m x 3.91m)

Two double glazed windows to side. Carpet. Radiator. Cupboard. Feature fireplace.

Bedroom Two 10' 2" x 8' 11" (3.09m x 2.71m)

Double glazed window to front. Vinyl flooring. Radiator. Cupboard. Access to loft.

Bedroom Three 9' 2" x 6' 0" (2.79m x 1.82m)

Double glazed window to front. Vinyl flooring. Radiator.

Bathroom 5' 10" x 4' 10" (1.79m x 1.48m)

WC. Basin. Plunge bath with shower over. Radiator. Vinyl floor. Part tiled walls.

Garden

Courtyard garden. Part brick surround. Laid to stone.



Score	Energy rating	Current	Potential
92+	A		
81-91	B		87 B
69-80	C		
55-68	D	63 D	
39-54	E		
21-38	F		
1-20	G		



GROUND FLOOR
419 sq.ft. (38.9 sq.m.) approx.

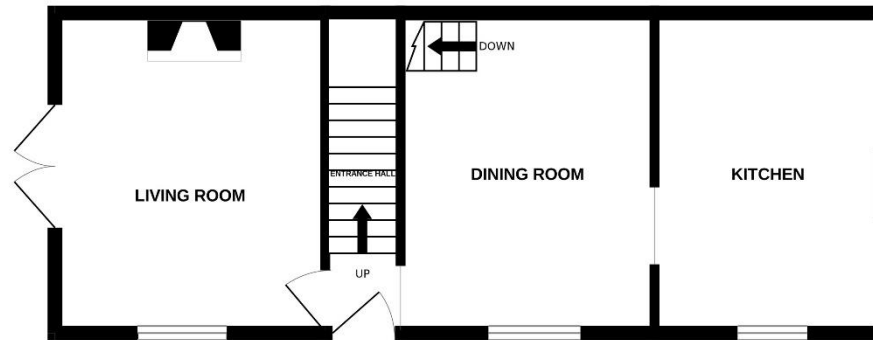

1ST FLOOR
425 sq.ft. (39.5 sq.m.) approx.

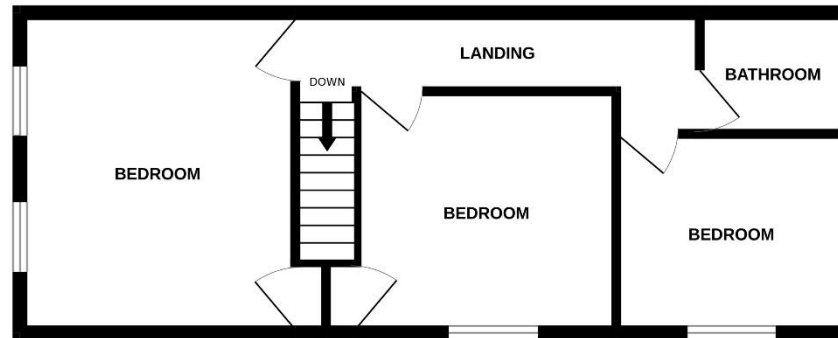

TOTAL FLOOR AREA : 843 sq.ft. (78.4 sq.m.) approx.

Whilst every attempt has been made to ensure the accuracy of the floorplan contained here, measurements of doors, windows, rooms and any other items are approximate and no responsibility is taken for any error, omission or mis-statement. This plan is for illustrative purposes only and should be used as such by any prospective purchaser. The services, systems and appliances shown have not been tested and no guarantee as to their operability or efficiency can be given.
Made with Metropix ©2024

These particulars are set out as a general outline and does not constitute any part of an offer or contract. We have not tested any services, appliances or equipment and no warranty is given or implied that these are in working order. Fixtures, fittings and furnishings are not included unless specifically described. All measurements, distances and areas are approximate and for guidance only. It should not be assumed that the property remains the same as shown in the photographs.

City Centre
2a Worcester Street
Gloucester GL1 3AA
☎ 01452 500025
✉ enquiries@
farrandfarr.co.uk

Hucclecote
50 Hucclecote Road
Gloucester GL3 3RT
☎ 01452 613355
✉ hucclecote@
farrandfarr.co.uk

Longlevens
125 Cheltenham Road
Gloucester GL2 0JQ
☎ 01452 380444
✉ longlevens@
farrandfarr.co.uk

Lettings
40 Oxstalls Way
Gloucester GL2 9JQ
☎ 01452 238298
✉ lettings@
farrandfarr.co.uk