

## Ground Floor

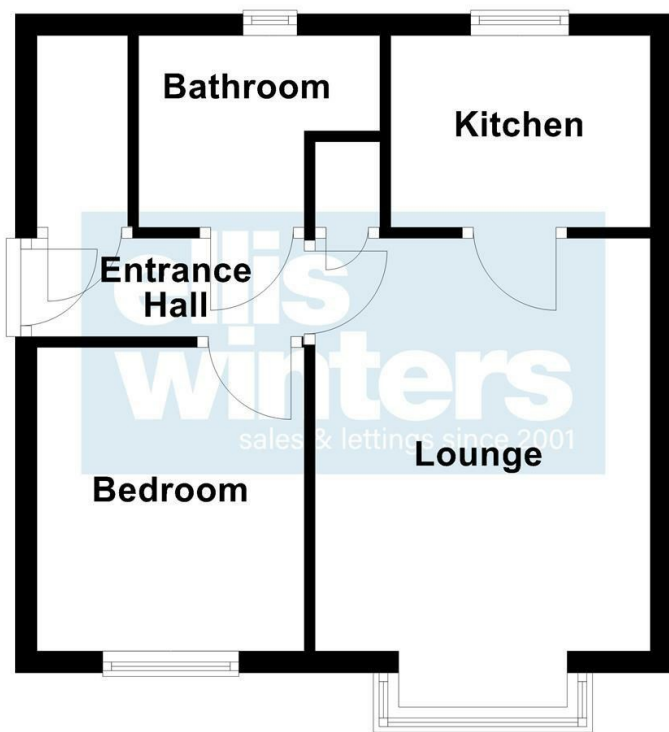

### Ground Floor

Access via a secure entrance door

Entrance Hall

Lounge  
3.80m (12'6") max x 3.08m (10'1")

Kitchen  
2.39m (7'10") x 1.77m (5'9")

Bedroom  
2.79m (9'2") x 2.46m (8'1")

Bathroom

### Further Information

Tenure: Leasehold  
Lease Length: 999 years from 1986,  
961 years remain  
Management Charge: £540 per annum.  
Each owner is invited to be a director  
within Slepe Court management  
company  
Council Tax Band: A  
EPC Rating: D

Agents Note: Whilst every care has been taken to prepare these particulars, they are for guidance purposes only. All measurements are approximate and are for general guidance purposes only and whilst every care has been taken to ensure their accuracy, they should not be relied upon and potential buyers/tenants are advised to recheck the measurements

**ellis winters**  
sales & lettings since 2001

### OFFICE ADDRESS

14 Market Hill  
St Ives  
Cambridgeshire  
PE27 5AL

### OFFICE DETAILS

01480 388888  
infostives@elliswinters.co.uk  
www.elliswinters.co.uk

**ellis winters**  
sales & lettings since 2001



ASKING PRICE

**£137,500**

**EAST STREET**

ST. IVES, PE27 5DY

## PROPERTY SUMMARY

A ground floor apartment, within St Ives town centre, and offered with no onward chain. This superb property has been fully redecorated throughout, features a lounge, a double bedroom, a kitchen with a new cooker, an updated bathroom, and an allocated off-road parking space. This property would make an ideal investment or first-time buy.

1



1



1

