

First Floor

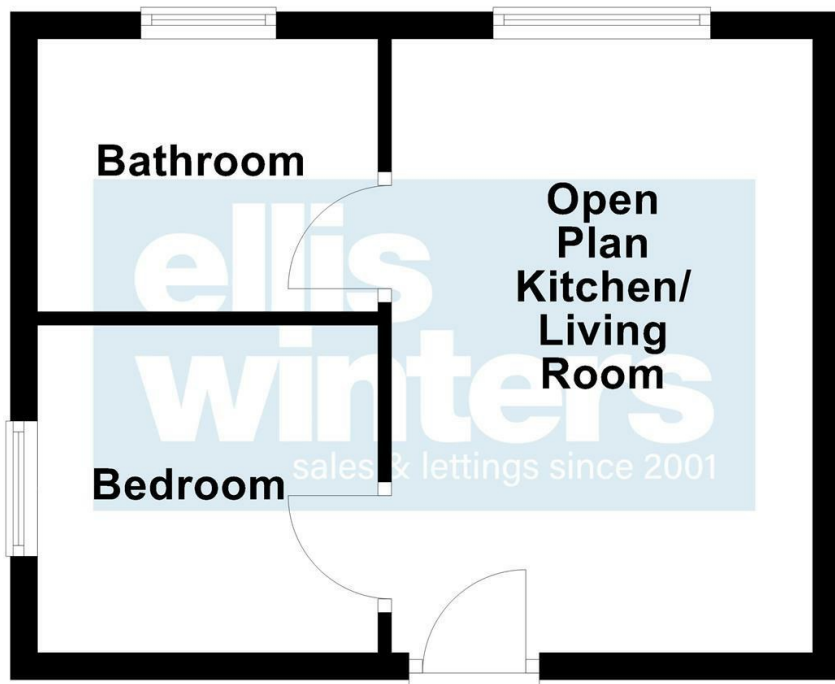

Ground Floor

Communal entrance hall, stairs to the first floor.

First Floor

Open Plan Kitchen/ Living Room
4.53m (14'10") x 3.11m (10'2")

Bedroom
2.51m (8'3") x 2.42m (7'11")

Bathroom
2.51m (8'3") x 2.01m (6'7")

Further Information

Tenure: Leasehold
Lease Length: 957 years remaining
Management Charge: £956 per annum
Council Tax Band: A
EPC Rating: D

Agents Note: Whilst every care has been taken to prepare these particulars, they are for guidance purposes only. All measurements are approximate and are for general guidance purposes only and whilst every care has been taken to ensure their accuracy, they should not be relied upon and potential buyers/tenants are advised to recheck the measurements

ellis winters
sales & lettings since 2001

OFFICE ADDRESS

14 Market Hill
St Ives
Cambridgeshire
PE27 5AL

OFFICE DETAILS

01480 388888
infostives@elliswinters.co.uk
www.elliswinters.co.uk

ellis winters
sales & lettings since 2001



ASKING PRICE

£97,500

WINDSOR GARDENS

HUNTINGDON, PE28 3DZ

PROPERTY SUMMARY

A well-presented, first-floor apartment in a popular well-serviced village location. This property features an open-plan kitchen/living room, a double bedroom, and a bathroom. The property also benefits from double glazing, gas central heating, and resident parking. An ideal first-time buy or investment property, this property comes highly recommended.

1



1



1

