



ASKING PRICE

£425,000

Ramsey Road

St. Ives, PE27 3XL

PROPERTY SUMMARY

A deceptively large chalet style home offered with No Forward Chain and with potential for other uses (stp). The property measures in excess of 2000 SQ-FT and currently offers spacious and versatile accommodation over two floors which includes four bedrooms, two bathrooms, two reception rooms, conservatory, and a kitchen/breakfast room. Outside the property benefits from off road parking and a good sized enclosed rear garden. The property is in need of updating throughout, however, a viewing is essential to fully appreciate this individual home and opportunity.

4



2



2





Ground Floor

Approx. 125.4 sq. metres (1349.4 sq. feet)



First Floor

Approx. 65.2 sq. metres (701.5 sq. feet)

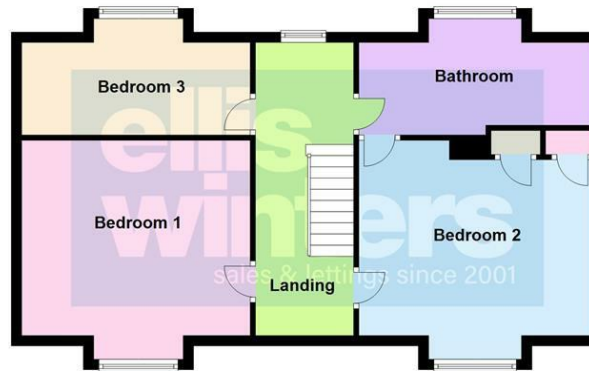

Total area: approx. 190.5 sq. metres (2050.9 sq. feet)

Agents Note: Whilst every care has been taken to prepare these particulars, they are for guidance purposes only. All measurements are approximate and are for general guidance purposes only and whilst every care has been taken to ensure their accuracy, they should not be relied upon and potential buyers/tenants are advised to recheck the measurements

ellis winters
sales & lettings since 2001

OFFICE ADDRESS

14 Market Hill
St Ives
Cambridgeshire
PE27 5AL

OFFICE DETAILS

01480 388888
infostives@elliswinters.co.uk
www.elliswinters.co.uk