



Bloomfield Road
Swanwick ALFRETON

Bloomfield Road Swanwick ALFRETON DE55 1RP

for sale offers over
£385,000



Property Description

Hall & Benson are delighted to bring to the market this fabulous four bedroom detached family home ideally located in the sought after village of Swanwick. Offering spacious living accommodation as well as landscaped gardens, ample off road parking and a double garage with office/workshop space. Viewings are highly advised to appreciate the accommodation on offer.

Briefly comprising, entrance hallway, living room, dining room, kitchen, conservatory and utility room to the ground floor, with master bedroom and en-suite, two further double bedrooms and a single bedroom to the first floor with family bathroom. The 1.5 width garage is double length with a section for workshop/office space and has a generous double entrance driveway to the front, and a beautiful established garden to the rear with a pond.

Entrance Hall

Entering the property via a wood effect composite door with inset glass pane. The hallway is open to the first floor with stairs leading up, having understairs storage with oak door. Oak flooring, wall mounted radiator and ceiling light.

Lounge

13' 5" x 22' 8" (4.09m x 6.91m)

Double, part glazed oak doors lead into a spacious L-Shaped room having a feature fireplace with newly fitted electric fire. With double glazed bay window to front aspect, double glazed sliding door to the rear, carpet

laid to flooring, wall mounted radiator and ceiling lights.

Dining Room

16' 3" x 10' 11" (4.95m x 3.33m)

Having feature brick fireplace and hearth with Huntingdon 30 log effect gas fire. With double glazed bay window to front aspect, carpet laid to flooring, wall mounted radiator and ceiling light.

Kitchen

13' 3" x 10' 4" (4.04m x 3.15m)

Fitted with a bespoke, solid oak kitchen having an large, stainless steel range cooker with 6 ring gas burner, oven and hood, integral fridge.freezer and plumbing space for a dishwasher.

This kitchen is a stunning traditional style with teracotta tile flooring throughout. A double glazed window overlooks the rear aspect and a composite stable door leads to the rear with wall mounted radiator and recessed spotlighting.

Utility Room

Comprising wall and base units with plumbing space underneath for washing machine and space for tumble dryer. There is also a low level wc and hand wash basin as a utility/cloakroom. With double glazed window to rear aspect and ceiling light.

Conservatory

The conservatory leads off the rear of the living room and comprises of a low brick wall with mounted radiator, tiled flooring and fully double glazed windows with patio door to the garden.

Landing

With loft hatch access and doors leading to-

Bedroom One

16' 8" x 10' 10" (5.08m x 3.30m)

A spacious master bedroom with double glazed window to front aspect, carpet laid to flooring, wall mounted radiator and ceiling light.

En Suite

Comprising Walk in shower unit, low level wc and wash basin integrated into a vanity unit. The room also has areas of storage which house the boiler. With two double glazed windows to rear and side aspects, fully tiled walls and flooring, with wall mounted radiator and recessed spotlights.

Bedroom Two

13' 2" x 10' 6" (4.01m x 3.20m)

With bespoke fitted wardrobes in oak to one wall, double glazed window to rear aspect, carpet laid to flooring, wall mounted radiator and ceiling light.

Bedroom Three

11' 10" x 13' 2" (3.61m x 4.01m)

With double glazed window to front aspect, rustic floorboards, wall mounted radiator and ceiling light.

Bedroom Four

9' x 7' 8" (2.74m x 2.34m)

With a gas central heating radiator, UPVC double glazed window and built in shelving and desk.

Family Bathroom

Comprising vanity unit with wash basin, and low level wc, bath and shower overhead. With fully tiled walls and flooring, double glazed window to rear aspect, wall mounted radiator and recessed spot lighting.

Garage

A 1.5 width car garage with up and over electric door, power and lighting, provides space for two cars (lengthways) with the added area to the rear which has been sectioned as a workshop. A composite door leads through to the rear garden.

Above is a loft accessed via a ladder to a boarded storage space with lighting.







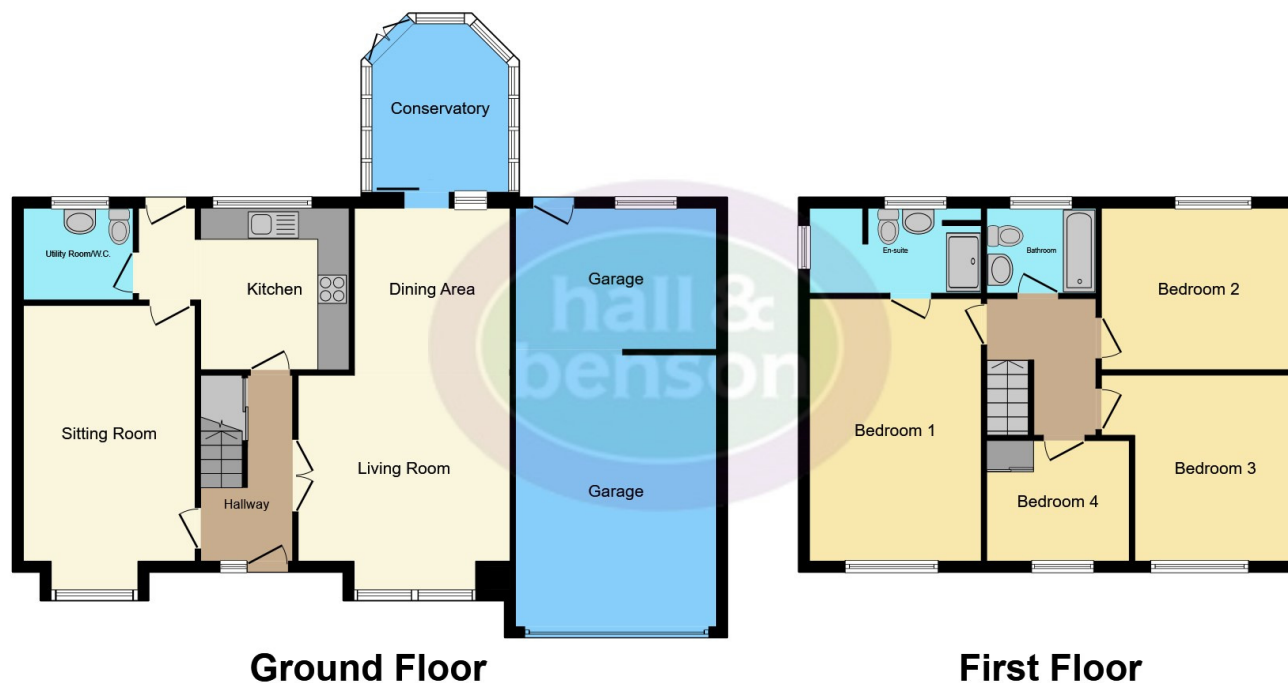

This floor plan is for illustrative purposes only. It is not drawn to scale. Any measurements, floor areas (including any total floor area), openings and orientation are approximate. No details are guaranteed, they cannot be relied upon for any purpose and they do not form part of any agreement. No liability is taken for any error, omission or misstatement. A party must rely upon its own inspection(s). Powered by www.focalagent.com

To view this property please contact Hall & Benson on

T 01773 521771
E alfreton@hallandbenson.co.uk

22A High Street
 ALFRETON DE55 7BN

EPC Rating: D

view this property online hallandbenson.co.uk/Property/ALF103037

Tenure: Freehold



1. MONEY LAUNDERING REGULATIONS Intending purchasers will be asked to produce identification documentation at a later stage and we would ask for your co-operation in order that there will be no delay in agreeing the sale. 2. These particulars do not constitute part or all of an offer or contract. 3. The measurements indicated are supplied for guidance only and as such must be considered incorrect. Potential buyers are advised to recheck measurements before committing to any expense. 4. We have not tested any apparatus, equipment, fixtures, fittings or services and it is in the buyers interest to check the working condition of any appliances.

Hall & Benson is a trading name of Connells Residential which is registered in England and Wales under company number 1489613, Registered Office is Cumbria House, 16-20 Hockliffe Street, Leighton Buzzard, Bedfordshire, LU7 1GN. VAT Registration Number is 500 2481 05.

See all our properties at www.hallandbenson.co.uk | www.rightmove.co.uk | www.zoopla.co.uk

Property Ref: ALF103037 - 0012