



Connells

Queens Road
Ash Canterbury

Queens Road Ash Canterbury CT3 2BG

for sale offers in the region of
£280,000



Property Description

AN IMMACULATELY PRESENTED, THREE BEDROOM TERRACED HOUSE in the sought after village location of Ash.

This home has attractive living accommodation set over three floors.

On the ground floor you will find a lounge, a separate dining room with a staircase up to the first floor, a fitted kitchen and a handy cloakroom with w.c.

To the first floor, this home benefits from two bedrooms and a very stylish modern family bathroom featuring a roll top bath upon chrome legs.

On the top floor, the staircase turns into the spacious master bedroom with storage built into the eaves and again, another tasteful en suite with a walk in shower cubicle.

Externally, this home boasts a deceivingly long garden, which is fairly low maintenance with its block paved ground & beautiful raised flower beds.

Lounge

13' x 9' 8" (3.96m x 2.95m)

Door to the front with obscured window, double glazed window to the front, fire place, radiator, wooden floor, telephone point, television point.

Cloakroom

Suite comprising of low level w.c, wash hand basin, double glazed window to the rear, tiled floor, combi boiler.

Dining Room

13' 2" x 13' (4.01m x 3.96m)

Double glazed window to the rear, fire place, radiator, understairs cupboard, door to kitchen.

Kitchen

10' 9" x 8' 7" (3.28m x 2.62m)

Fitted kitchen with a range of matching wall and base units, stainless steel one and a half bowl sink and drainer, wood effect work surfaces over, splashback tiling, electric oven with gas hob and cookerhood over, space and plumbing for washing machine and dishwasher, fridge/freezer, radiator, tiled flooring, double glazed window to the side, door to garden, door to cloakroom.

Landing

Stairs from ground floor, cupboard, radiator.

Bedroom One

13' 4" x 13' 1" (4.06m x 3.99m)

(Second Floor) Double glazed window to the front, built in wardrobes, radiator, storage cupboard in eaves, loft hatch, inset spotlights to the ceiling.

En Suite To Bedroom One

Modern suite comprising of walk in shower cubicle, wash hand basin with vanity unit, low level w.c, part tiled, heated towel rail, double glazed velux window to the rear, wood effect floor.

Bedroom Two

13' 3" x 10' (4.04m x 3.05m)

(First Floor) Double glazed window to the front, radiator, wooden floor, understairs cupboard, fire place.

Bedroom Three

7' 9" x 5' 6" (2.36m x 1.68m)

(First Floor) Double glazed window to the rear, radiator, fire place, cupboard.

Bathroom

Suite comprising of roll top bath with chrome legs and mixer taps and shower attachment over, wash hand basin, low level w.c, part tiled, radiator, obscured double glazed window to the rear.

To The Outside

Rear Garden

Low maintenance long garden to the rear, block paved, raised flower beds, fenced boundaries.







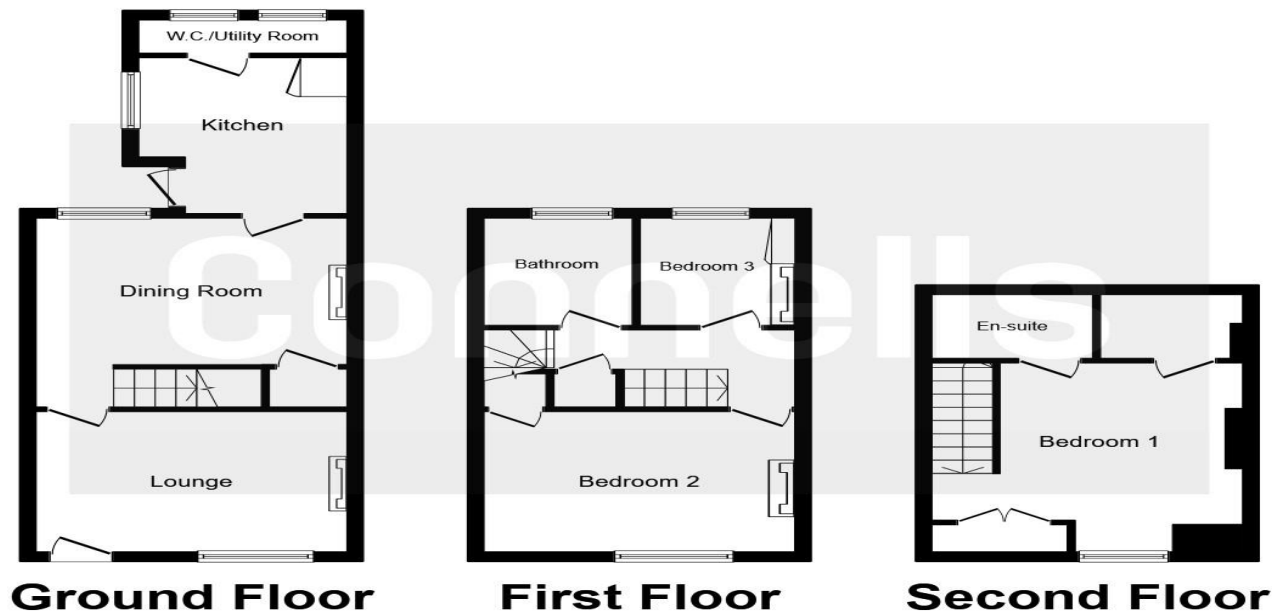

This floor plan is for illustrative purposes only. It is not drawn to scale. Any measurements, floor areas (including any total floor area), openings and orientation are approximate. No details are guaranteed, they cannot be relied upon for any purpose and they do not form part of any agreement. No liability is taken for any error, omission or misstatement. A party must rely upon its own inspection(s). Plan produced for Connells. Powered by www.focalagent.com

To view this property please contact Connells on

T 01227 764 720
E canterbury@connells.co.uk

77 Castle Street
 CANTERBURY CT1 2QD

view this property online connells.co.uk/Property/ref-CBY403924

directions to this property:

Leave Canterbury on the A257 road towards Sandwich and follow the road through the villages of Littlebourne and Wingham. Turn right onto Chequer Lane, then left onto Queens Road.

EPC Rating: E

Tenure: Freehold



1. MONEY LAUNDERING REGULATIONS Intending purchasers will be asked to produce identification documentation at a later stage and we would ask for your co-operation in order that there will be no delay in agreeing the sale. 2. These particulars do not constitute part or all of an offer or contract. 3. The measurements indicated are supplied for guidance only and as such must be considered incorrect. Potential buyers are advised to recheck measurements before committing to any expense. 4. We have not tested any apparatus, equipment, fixtures, fittings or services and it is in the buyers interest to check the working condition of any appliances.

See all our properties at www.connells.co.uk | www.rightmove.co.uk | www.zoopla.co.uk

Property Ref: CBY403924 - 0003