



Not for marketing purposes INTERNAL USE ONLY

Rhondda Vale  
Aylesham Canterbury





### Property Description

Discover this lovely two-bedroom terrace situated in the idyllic village of Aylesham, just a short drive from the historic city of Canterbury. Perfect for first-time buyers, young professionals, or small families, this home offers comfortable living in a friendly community setting.

The property features a welcoming lounge with ample natural light, leading seamlessly into a modern kitchen equipped with integrated appliances and space for dining. Upstairs, you'll find two well-proportioned bedrooms, both offering versatile space for relaxation or workspace. The family bathroom is fitted with contemporary fixtures and a bathtub.

Externally, the property boasts a low-maintenance rear garden, ideal for outdoor entertaining or gardening enthusiasts. On-street parking is readily available, and the location provides easy access to local amenities, schools, and transport links to Canterbury and beyond.

Don't miss the opportunity to make this charming terrace your new home. Contact us today to arrange a viewing!













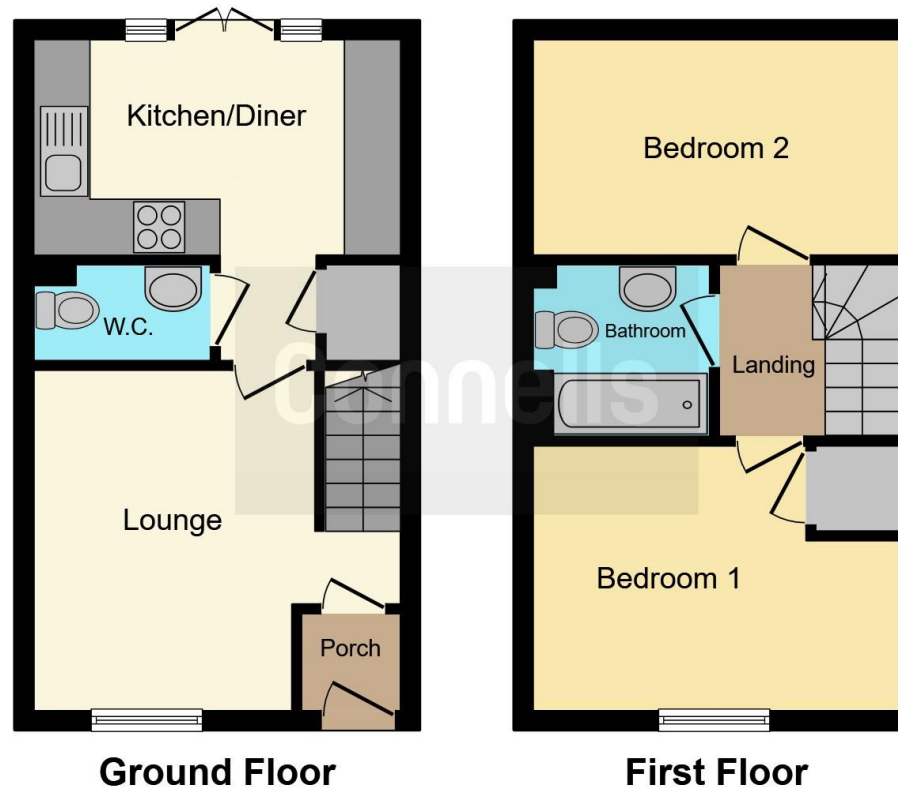

This floor plan is for illustrative purposes only. It is not drawn to scale. Any measurements, floor areas (including any total floor area), openings and orientation are approximate. No details are guaranteed, they cannot be relied upon for any purpose and they do not form part of any agreement. No liability is taken for any error, omission or misstatement. A party must rely upon its own inspection(s). Powered by [www.focalagent.com](http://www.focalagent.com)

To view this property please contact Connells on

**T 01227 764 720**  
**E [canterbury@connells.co.uk](mailto:canterbury@connells.co.uk)**

29-30 Watling Street  
 CANTERBURY CT1 2UD

EPC Rating:  
 Awaited

Tenure: Freehold

**check out more properties at [connells.co.uk](http://connells.co.uk)**



1. MONEY LAUNDERING REGULATIONS Intending purchasers will be asked to produce identification documentation at a later stage and we would ask for your co-operation in order that there will be no delay in agreeing the sale. 2. These particulars do not constitute part or all of an offer or contract. 3. The measurements indicated are supplied for guidance only and as such must be considered incorrect. Potential buyers are advised to recheck measurements before committing to any expense. 4. We have not tested any apparatus, equipment, fixtures, fittings or services and it is in the buyers interest to check the working condition of any appliances.

Connells Residential is registered in England and Wales under company number 1489613, Registered Office is Cumbria House, 16-20 Hockliffe Street, Leighton Buzzard, Bedfordshire, LU7 1GN. VAT Registration Number is 500 2481 05.

**See all our properties at [www.connells.co.uk](http://www.connells.co.uk) | [www.rightmove.co.uk](http://www.rightmove.co.uk) | [www.zoopla.co.uk](http://www.zoopla.co.uk)**

Property Ref: CBY406470 - 0001