



Connells

Zealand Road
Canterbury



Property Description

Offered to the market is this four bedroom semi detached property on the edge of Canterbury within walking distance of the main city centre.

The property itself is made up with a lounge, separate dining room, second reception room, kitchen and family bathroom. Further benefits include a rear garden and a substantial outbuilding.

The property is located in Zealand Road which is in Wincheap. The area is ideal for anyone wanting to be within walking distance to Kent and Canterbury Hospital, both mainline train stations and Canterbury City centre.

There is easy access to the A2 to London.

There is also an excellent primary school near by, as well as a park and playing fields and local amenities within walking distance.

Bedroom Four

7' 1" x 9' 1" (2.16m x 2.77m)

Lounge

11' 3" x 10' 4" (3.43m x 3.15m)

Dining Room

9' 2" x 8' 9" (2.79m x 2.67m)

Second Reception Room

11' 3" x 7' 11" (3.43m x 2.41m)

Bedroom One

11' 4" x 12' 1" (3.45m x 3.68m)

Bedroom Two

11' 6" x 9' 6" (3.51m x 2.90m)

Bedroom Three

11' 8" x 8' 5" (3.56m x 2.57m)









Ground Floor



First Floor

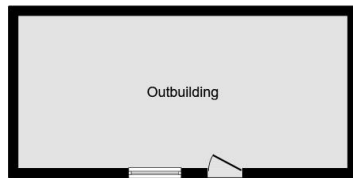

Outbuilding

This floor plan is for illustrative purposes only. It is not drawn to scale. Any measurements, floor areas (including any total floor area), openings and orientation are approximate. No details are guaranteed, they cannot be relied upon for any purpose and they do not form part of any agreement. No liability is taken for any error, omission or misstatement. A party must rely upon its own inspection(s). Powered by www.focalagent.com

To view this property please contact Connells on

T 01227 764 720
E canterbury@connells.co.uk

29-30 Watling Street
CANTERBURY CT1 2UD

EPC Rating: E

Tenure: Freehold

view this property online connells.co.uk/Property/CBY405420



1. MONEY LAUNDERING REGULATIONS Intending purchasers will be asked to produce identification documentation at a later stage and we would ask for your co-operation in order that there will be no delay in agreeing the sale. 2. These particulars do not constitute part or all of an offer or contract. 3. The measurements indicated are supplied for guidance only and as such must be considered incorrect. Potential buyers are advised to recheck measurements before committing to any expense. 4. We have not tested any apparatus, equipment, fixtures, fittings or services and it is in the buyers interest to check the working condition of any appliances.

Connells Residential is registered in England and Wales under company number 1489613, Registered Office is Cumbria House, 16-20 Hockliffe Street, Leighton Buzzard, Bedfordshire, LU7 1GN. VAT Registration Number is 500 2481 05.

See all our properties at www.connells.co.uk | www.rightmove.co.uk | www.zoopla.co.uk

Property Ref: CBY405420 - 0003