



Connells

Donington Park Close
Edenbridge

Donington Park Close Edenbridge TN8 6DW

for sale guide price
£375,000



Property Description

Positioned in a peaceful cul-de-sac setting, this attractive home combines convenience with a relaxed lifestyle. Just moments from Edenbridge's local amenities, schools and transport connections, the property boasts light-filled interiors, sociable living spaces and comfortable bedrooms. The private rear garden provides the perfect space for outdoor dining and children to play, while off-street parking adds further practicality. This property still has NHBC remaining as the site was only built in 2019.

Entrance Hall

Cloakroom

Kitchen

11' 8" x 6' 5" (3.56m x 1.96m)

Living/Dining Room

15' 7" x 13' 8" (4.75m x 4.17m)

Landing

Bedroom 1

13' 9" x 10' 4" (4.19m x 3.15m)

Bathroom

Bedroom 2

13' 8" x 8' 5" (4.17m x 2.57m)

Rear Garden

Parking

1 x Allocated Space and guest parking.







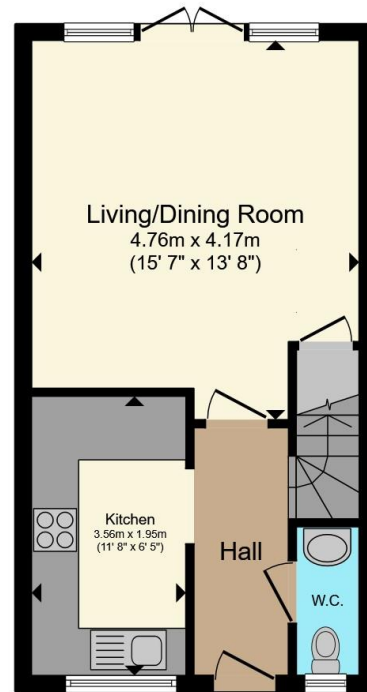

Ground Floor

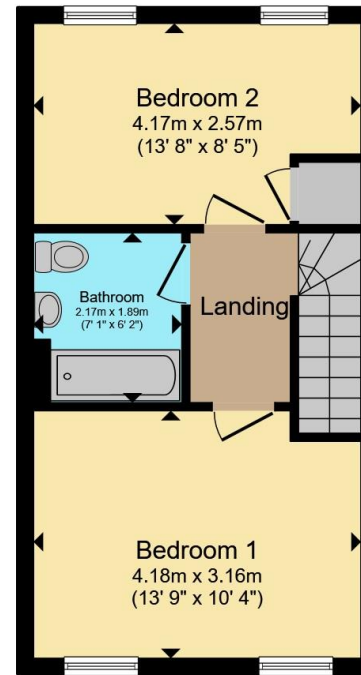

First Floor

Total floor area 67.6 m² (727 sq.ft.) approx

This floor plan is for illustrative purposes only. It is not drawn to scale. Any measurements, floor areas (including any total floor area), openings and orientation are approximate. No details are guaranteed, they cannot be relied upon for any purpose and they do not form part of any agreement. No liability is taken for any error, omission or misstatement. A party must rely upon its own inspection(s). Powered by www.propertybox.io

Connells

To view this property please contact Connells on

T 01342 325 911
E eastgrinstead@connells.co.uk

90 London Road
EAST GRINSTEAD RH19 1EP

EPC Rating: B Council Tax
Band: D

Tenure: Freehold

view this property online connells.co.uk/Property/EGR405483



1. MONEY LAUNDERING REGULATIONS Intending purchasers will be asked to produce identification documentation at a later stage and we would ask for your co-operation in order that there will be no delay in agreeing the sale. 2. These particulars do not constitute part or all of an offer or contract. 3. The measurements indicated are supplied for guidance only and as such must be considered incorrect. Potential buyers are advised to recheck measurements before committing to any expense. 4. We have not tested any apparatus, equipment, fixtures, fittings or services and it is in the buyers interest to check the working condition of any appliances.

Connells Residential is registered in England and Wales under company number 1489613, Registered Office is Cumbria House, 16-20 Hockliffe Street, Leighton Buzzard, Bedfordshire, LU7 1GN. VAT Registration Number is 500 2481 05.

See all our properties at www.connells.co.uk | www.rightmove.co.uk | www.zoopla.co.uk

Property Ref: EGR405483 - 0002