



Connells
FOR SALE

Connells

Oaklands House Ashford Road
Maidstone



Property Description

This spacious one bedroom ground floor apartment is being offered with two allocated parking spaces and located in Maidstone town centre with easy access to local shops, amenities, M20/M25 motorways and mainline train stations with links to London. This one double bedroom apartment boasts a separate fitted kitchen and living room with the bedroom having the added benefit of fitted wardrobes.

Maidstone lies 32 miles south east of London, is the largest town in Kent and also known as the Garden of England. Maidstone is a sought after location being only an hour to London on the fast train, and only 45 miles to Broadstairs which boasts impressive sandy beaches. Maidstone Town centre hosts an excellent range of restaurants: English, French, Greek, Spanish, Turkish, Thai, Indian, Chinese, American and Mexican, as well as many bars and vibrant nightlife. Maidstone is alive with a massive range of events all year round including drama, dance, music, comedy, arts, festivals, sports and concerts. There are a number of quaint villages on the outskirts of Maidstone offering country walks and cute country pubs.



Entrance Hall

Lounge

15' 11" Max x 13' Max (4.85m Max x 3.96m Max)

Kitchen

8' 5" Max x 5' 9" Max (2.57m Max x 1.75m Max)

Bedroom

15' 11" Max x 10' Max (4.85m Max x 3.05m Max)

Bathroom



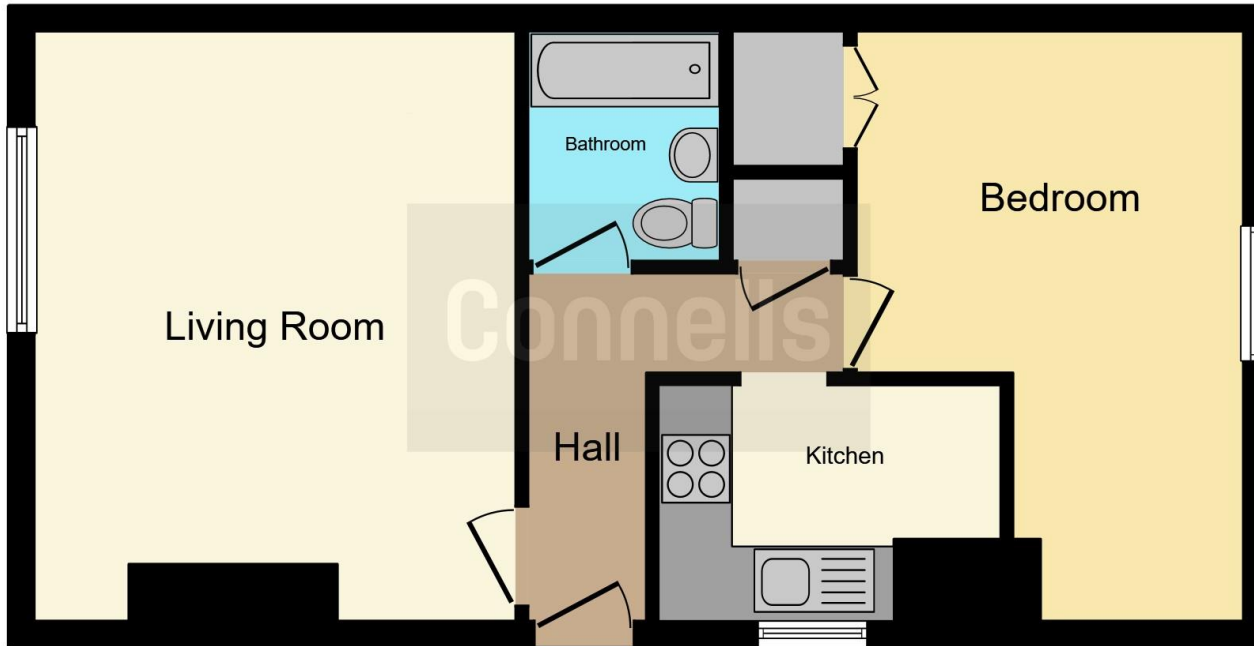

This floor plan is for illustrative purposes only. It is not drawn to scale. Any measurements, floor areas (including any total floor area), openings and orientation are approximate. No details are guaranteed, they cannot be relied upon for any purpose and they do not form part of any agreement. No liability is taken for any error, omission or misstatement. A party must rely upon its own inspection(s). Powered by www.focalagent.com

To view this property please contact Connells on

T 01622 751034
E maidstone@connells.co.uk

30 King Street
 MAIDSTONE ME14 1BS

EPC Rating: D

view this property online connells.co.uk/Property/MAI407280

This is a Leasehold property with details as follows; Term of Lease 999 years from 01 Jun 1998. Should you require further information please contact the branch. Please Note additional fees could be incurred for items such as Leasehold packs.

Tenure: Leasehold



1. MONEY LAUNDERING REGULATIONS Intending purchasers will be asked to produce identification documentation at a later stage and we would ask for your co-operation in order that there will be no delay in agreeing the sale. 2. These particulars do not constitute part or all of an offer or contract. 3. The measurements indicated are supplied for guidance only and as such must be considered incorrect. Potential buyers are advised to recheck measurements before committing to any expense. 4. We have not tested any apparatus, equipment, fixtures, fittings or services and it is in the buyers interest to check the working condition of any appliances.

Connells Residential is registered in England and Wales under company number 1489613, Registered Office is Cumbria House, 16-20 Hockliffe Street, Leighton Buzzard, Bedfordshire, LU7 1GN. VAT Registration Number is 500 2481 05.

See all our properties at www.connells.co.uk | www.rightmove.co.uk | www.zoopla.co.uk

Property Ref: MAI407280 - 0007