



Connells

Westmorland Road
Maidstone



Property Description

This spacious three bedroom mid terraced family home is offered to the market with no onward chain and boasts spacious living accommodation throughout. Ground floor consists of an open plan lounge/diner, fitted kitchen, utility room and conservatory, First floor has been completely refurbished including new carpets and decorated throughout with a modern fitted wet-room recently installed. Externally you have a generous sized rear garden, mainly laid to lawn with decking along with off road driveway parking to the front of the property. Conveniently located close to local schools, shops, mote park with local bus routes located close by.

Maidstone lies 32 miles south east of London, is the largest town in Kent and also known as the Garden of England. Maidstone is a sought after location being only an hour to London on the fast train, and only 45 miles to Broadstairs which boasts impressive sandy beaches.

Maidstone Town centre hosts an excellent range of restaurants: English, French, Greek, Spanish, Turkish, Thai, Indian, Chinese, American and Mexican, as well as many bars and vibrant nightlife. Maidstone is alive with a massive range of events all year round including drama, dance, music, comedy, arts, festivals, sports and concerts. There are a number of quaint villages on the outskirts of Maidstone offering country walks and cute country pubs.



Entrance Hall

Lounge

18' 3" Max x 14' Max (5.56m Max x 4.27m Max)

Kitchen

9' 11" Max x 8' 11" Max (3.02m Max x 2.72m Max)

Utility Room

8' 11" Max x 6' 10" Max (2.72m Max x 2.08m Max)

Conservatory

10' 4" x 7' 7" (3.15m x 2.31m)

Landing

Bedroom One

12' 9" Max x 12' 4" Max (3.89m Max x 3.76m Max)

Bedroom Two

11' 3" Max x 11' 1" Max (3.43m Max x 3.38m Max)

Bedroom Three

11' 1" Max x 8' Max (3.38m Max x 2.44m Max)

Wet Room

Front

Rear Garden







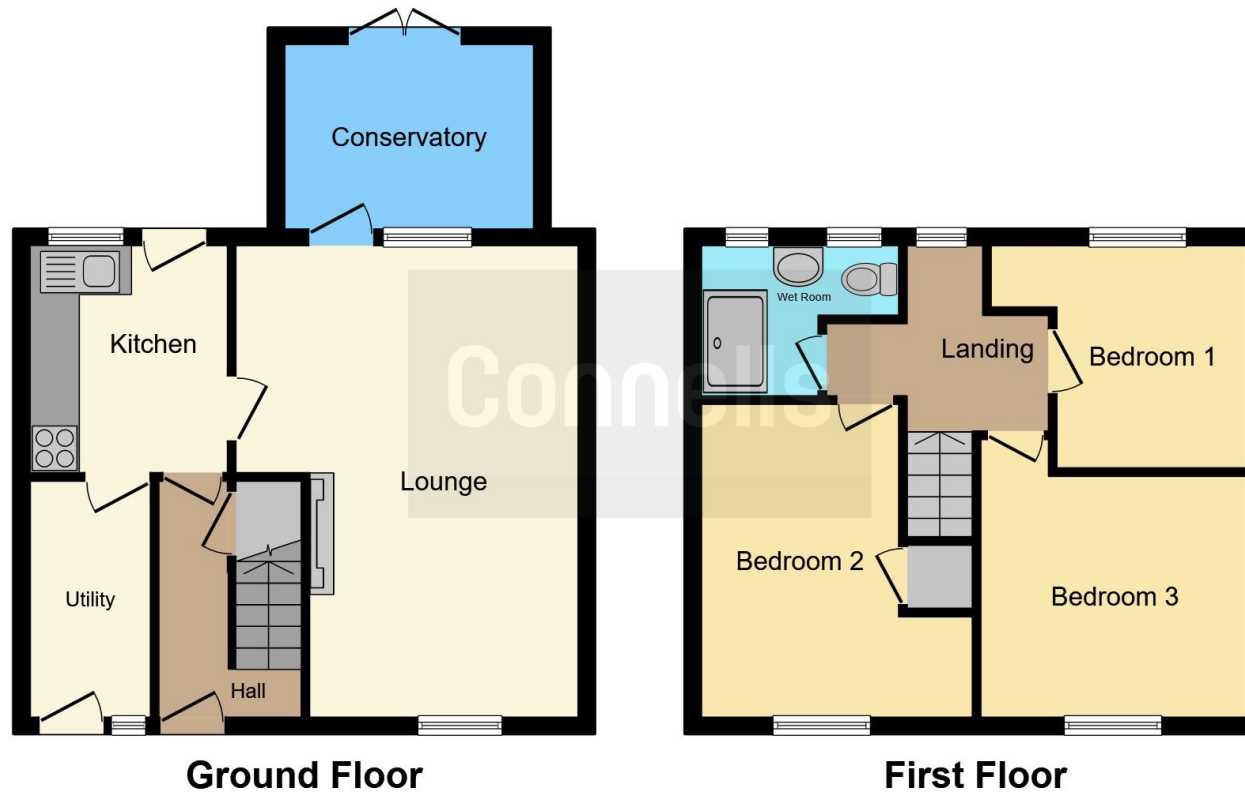

This floor plan is for illustrative purposes only. It is not drawn to scale. Any measurements, floor areas (including any total floor area), openings and orientation are approximate. No details are guaranteed, they cannot be relied upon for any purpose and they do not form part of any agreement. No liability is taken for any error, omission or misstatement. A party must rely upon its own inspection(s). Powered by www.focalagent.com

To view this property please contact Connells on

T 01622 751034
E maidstone@connells.co.uk

30 King Street
 MAIDSTONE ME14 1BS

EPC Rating: D

Tenure: Freehold

view this property online connells.co.uk/Property/MAI407298



1. MONEY LAUNDERING REGULATIONS Intending purchasers will be asked to produce identification documentation at a later stage and we would ask for your co-operation in order that there will be no delay in agreeing the sale. 2. These particulars do not constitute part or all of an offer or contract. 3. The measurements indicated are supplied for guidance only and as such must be considered incorrect. Potential buyers are advised to recheck measurements before committing to any expense. 4. We have not tested any apparatus, equipment, fixtures, fittings or services and it is in the buyers interest to check the working condition of any appliances.

Connells Residential is registered in England and Wales under company number 1489613, Registered Office is Cumbria House, 16-20 Hockliffe Street, Leighton Buzzard, Bedfordshire, LU7 1GN. VAT Registration Number is 500 2481 05.

See all our properties at www.connells.co.uk | www.rightmove.co.uk | www.zoopla.co.uk

Property Ref: MAI407298 - 0003