



Connells

Miller Heights Lower Stone Street
Maidstone



Property Description

Located in Lower Stone Street Miller Heights is a stones throw from Maidstone Town Centre. East and West Train Stations are within a short walk. Easy reach to M20 motorway for journeys to London or the Kent Coast.

Miller Heights benefits from a Concierge Reception Entrance with stairs and lifts to all floors. This third floor apartment has a hallway with doors leading into; open plan kitchen living area. The kitchen is fully fitted with integrated washing machine, fridge/freezer, built in oven, hob and extractor. Two double bedrooms, the main bedroom has built in double mirrored wardrobes Full size bathroom with shower over bath and large heated towel rail.

Maidstone lies 32 miles south east of London, is the largest town in Kent and also known as the Garden of England. Maidstone is a sought after location being only an hour to London on the fast train, and only 45 miles to Broadstairs which boasts impressive sandy beaches.

Maidstone Town centre hosts an excellent range of restaurants: English, French, Greek, Spanish, Turkish, Thai, Indian, Chinese, American and Mexican, as well as many bars and vibrant nightlife. Maidstone is alive with a massive range of events all year round including drama, dance, music, comedy, arts, festivals, sports and concerts. There are a number of quaint villages on the outskirts of Maidstone offering country walks and cute country pubs.



Entrance Hall

Kitchen/living Area

Bedroom One

Bedroom Two

Bathroom



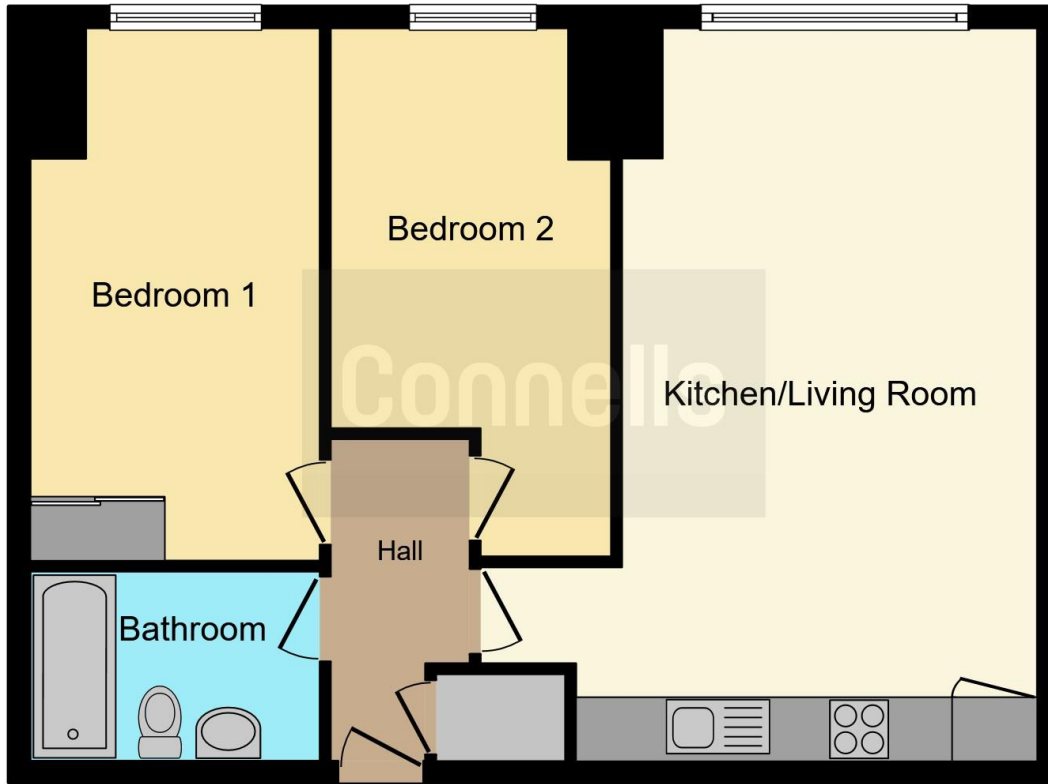

This floorplan is for illustrative purposes only and is not drawn to scale. Measurements, floor-areas, openings and orientations are approximate. They should not be relied upon for any purpose and do not form any part of an agreement. No liability is taken for any error or mis-statement. All parties must rely on their own inspections.

To view this property please contact Connells on

T 01622 751034
E maidstone@connells.co.uk

30 King Street
 MAIDSTONE ME14 1BS

EPC Rating: C

view this property online connells.co.uk/Property/MAI406588

This is a Leasehold property with details as follows; Term of Lease 125 years from 01 Jan 2015. Should you require further information please contact the branch. Please Note additional fees could be incurred for items such as Leasehold packs.



Tenure: Leasehold



1. MONEY LAUNDERING REGULATIONS Intending purchasers will be asked to produce identification documentation at a later stage and we would ask for your co-operation in order that there will be no delay in agreeing the sale. 2. These particulars do not constitute part or all of an offer or contract. 3. The measurements indicated are supplied for guidance only and as such must be considered incorrect. Potential buyers are advised to recheck measurements before committing to any expense. 4. We have not tested any apparatus, equipment, fixtures, fittings or services and it is in the buyers interest to check the working condition of any appliances.

Connells Residential is registered in England and Wales under company number 1489613, Registered Office is Cumbria House, 16-20 Hockliffe Street, Leighton Buzzard, Bedfordshire, LU7 1GN. VAT Registration Number is 500 2481 05.

See all our properties at www.connells.co.uk | www.rightmove.co.uk | www.zoopla.co.uk

Property Ref: MAI406588 - 0007