

for sale

£620,000



South Lea Kingsnorth Ashford TN23 3EH

South Lea is possibly one of the most desirable roads in Ashford. This home is being offered to the market for the first time in a generation and would make the perfect family home. Please contact the sole agent Connells for your chance to view!



South Lea Kingsnorth Ashford TN23 3EH

Ground Floor

Entrance Hallway

Lounge

14' 8" x 13' 9" (4.47m x 4.19m)

Dining Room

11' 1" x 9' 3" (3.38m x 2.82m)

Kitchen

15' x 9' 3" (4.57m x 2.82m)

Utility Room

Study (former Garage)

12' 8" x 8' 2" (3.86m x 2.49m)

Cloak Room

First Floor

Bedroom 1

11' 6" x 10' 6" (3.51m x 3.20m)

En-Suite

6' 7" x 5' 6" (2.01m x 1.68m)

Bedroom 2

11' 6" x 10' 8" (3.51m x 3.25m)

Bedroom 3

12' x 8' 8" (3.66m x 2.64m)

Bedroom 4

11' 5" x 7' 7" (3.48m x 2.31m)

Family Bathroom

7' 1" x 5' 6" (2.16m x 1.68m)

Garage



Outside
Front & Rear Garden





Ground Floor

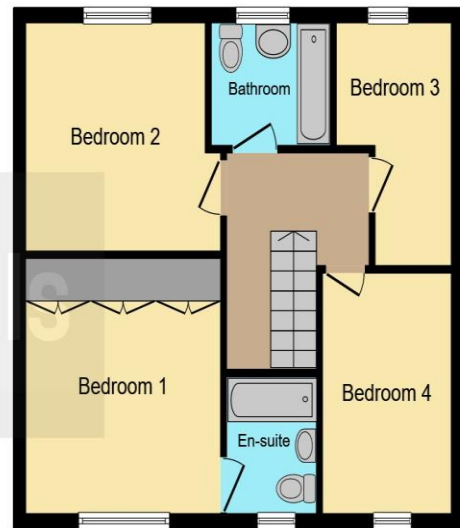

First Floor

This floorplan is for illustrative purposes only and is not drawn to scale. Measurements, floor-areas, openings and orientations are approximate. They should not be relied upon for any purpose and do not form any part of an agreement. No liability is taken for any error or mis-statement. All parties must rely on their own inspections.

To view this property please contact Connells on

T 01233 622206
E ashford@connells.co.uk

77 High Street
 ASHFORD TN24 8SF

Property Ref: ASH407496 - 0004

Tenure: Freehold

EPC Rating: C

view this property online connells.co.uk/Property/ASH407496



1. MONEY LAUNDERING REGULATIONS Intending purchasers will be asked to produce identification documentation at a later stage and we would ask for your co-operation in order that there will be no delay in agreeing the sale. 2. These particulars do not constitute part or all of an offer or contract. 3. The measurements indicated are supplied for guidance only and as such must be considered incorrect. Potential buyers are advised to recheck measurements before committing to any expense. 4. We have not tested any apparatus, equipment, fixtures, fittings or services and it is in the buyers interest to check the working condition of any appliances.

Connells Residential is registered in England and Wales under company number 1489613, Registered Office is Cumbria House, 16-20 Hockliffe Street, Leighton Buzzard, Bedfordshire, LU7 1GN. VAT Registration Number is 500 2481 05.

see all our properties at www.connells.co.uk | www.rightmove.co.uk | www.zoopla.co.uk