

for sale

£32,000



New Beach Hythe Road Dymchurch Romney Marsh TN29 0JX

New Beach Holiday Park is located a stone's throw from the ever popular Dymchurch beach, near Hythe in the Garden Of England, Kent. We are 10 minutes from the M20 motorway and overlooking miles of rolling countryside to the year. Locally we are blessed with multiple cycle routes, dog walking trails.



New Beach Hythe Road Dymchurch Romney Marsh TN29 0JX

Lounge

11' 8" x 13' (3.56m x 3.96m)

Kitchen

6' 2" x 14' (1.88m x 4.27m)

Bedroom 1

8' 2" x 8' 4" (2.49m x 2.54m)

Bedroom 2

8' 3" x 5' 3" (2.51m x 1.60m)

Bathroom

6' 5" x 3' 5" (1.96m x 1.04m)





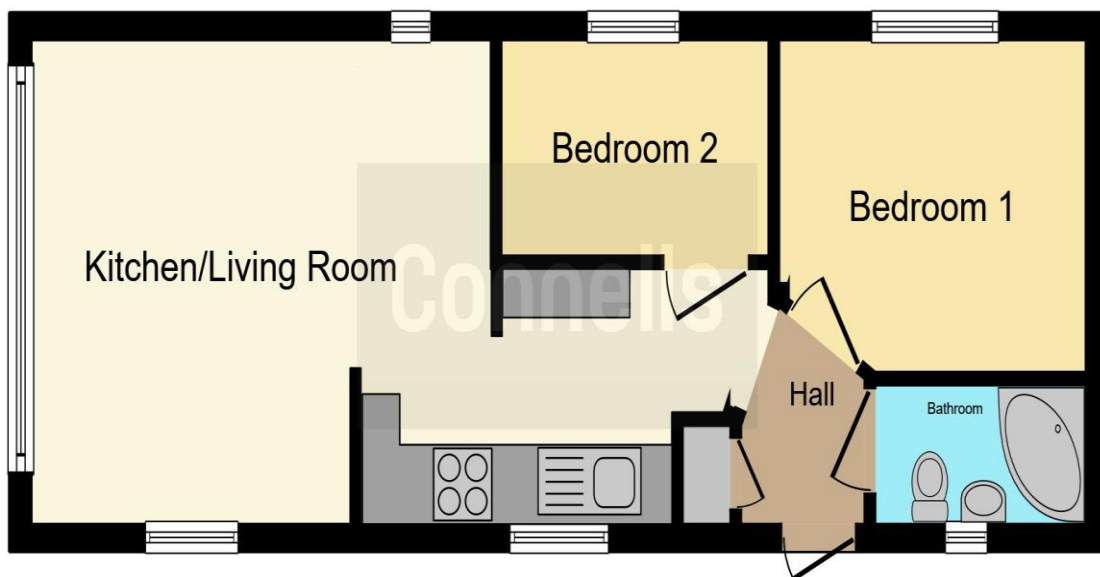

This floorplan is for illustrative purposes only and is not drawn to scale. Measurements, floor-areas, openings and orientations are approximate. They should not be relied upon for any purpose and do not form any part of an agreement. No liability is taken for any error or mis-statement. All parties must rely on their own inspections.

To view this property please contact Connells on

T 01233 622206
E ashford@connells.co.uk

77 High Street
ASHFORD TN24 8SF

Property Ref: ASH407034 - 0003

Tenure:

EPC Rating: Exempt

view this property online connells.co.uk/Property/ASH407034

We are currently awaiting Tenure details. For further information please contact the branch. Please note additional fees could be incurred for items such as leasehold packs.



1. MONEY LAUNDERING REGULATIONS Intending purchasers will be asked to produce identification documentation at a later stage and we would ask for your co-operation in order that there will be no delay in agreeing the sale. 2. These particulars do not constitute part or all of an offer or contract. 3. The measurements indicated are supplied for guidance only and as such must be considered incorrect. Potential buyers are advised to recheck measurements before committing to any expense. 4. We have not tested any apparatus, equipment, fixtures, fittings or services and it is in the buyers interest to check the working condition of any appliances.

Connells Residential is registered in England and Wales under company number 1489613, Registered Office is Cumbria House, 16-20 Hockliffe Street, Leighton Buzzard, Bedfordshire, LU7 1GN. VAT Registration Number is 500 2481 05.

see all our properties at www.connells.co.uk | www.rightmove.co.uk | www.zoopla.co.uk