

FARMER & DYER

RESIDENTIAL SALES & LETTINGS



**SEND ROAD, CAVERSHAM
READING, RG4 8EH**

£215,000

An excellent opportunity to purchase this top floor apartment set in this Victorian conversion and situated an approx. 15 minute walk to Reading mainline station. Includes 15ft living room, 20ft 'L' shaped kitchen/breakfast room, 15ft bedroom, modern bathroom and one allocated residents parking space. This property has a share of the freehold. No onward chain

No.1 Prospect Street, Caversham, Reading, Berkshire RG4 8JB
T 0118 946 1800 W www.farmeranddyer.com
E info@farmeranddyer.com

COMMUNAL ENTRANCE HALL

With decorative tiled floor and stairs to top floor

ENTRANCE HALL

Large storage cupboard

LIVING ROOM

15' (4.57m) x 14' (4.27m)

Rear aspect with radiator and loft storage access

KITCHEN/BREAKFAST ROOM

20' (6.1m) x 13' (3.96m)

'L' shaped room - kitchen fitted with worktops and cupboards, space for fridge, plumbing for washing machine, two side aspect windows

Breakfast area - with feature dormer front window, space for table, radiator,

**BEDROOM**

15' (4.57m) x 14' (4.27m)

15ft bedroom with front aspect window, radiator, built in cupboard including recently fitted gas boiler

**BATHROOM**

Modern three piece suite comprising: shower bath, pedestal wash hand basin, w.c, chrome towel radiator and tiled floor

**OUTSIDE**

There is a residents parking area with one parking space allocated to this apartment. There is a small area of grounds that are maintained under the maintenance agreement.

TENURE

Leasehold

The residents collectively own the freehold of the property

Original lease - 999 years

Lease remaining - 997 years

Maintenance charge - £179 per quarter

Ground rent - N/A

APPROXIMATE MONTHLY RENTAL VALUE

£1,095

COUNCIL TAX

Band B

ENERGY EFFICIENCY & ENVIRONMENTAL IMPACT

Energy Rating D

To view the full EPC for this property, you can access the national database with the following web address: <https://find-energy-certificate.service.gov.uk/energy-certificate/0141-3029-2208-8217-1204>

FLOORPLAN

These floor plans are for guidance purposes only and are not to scale

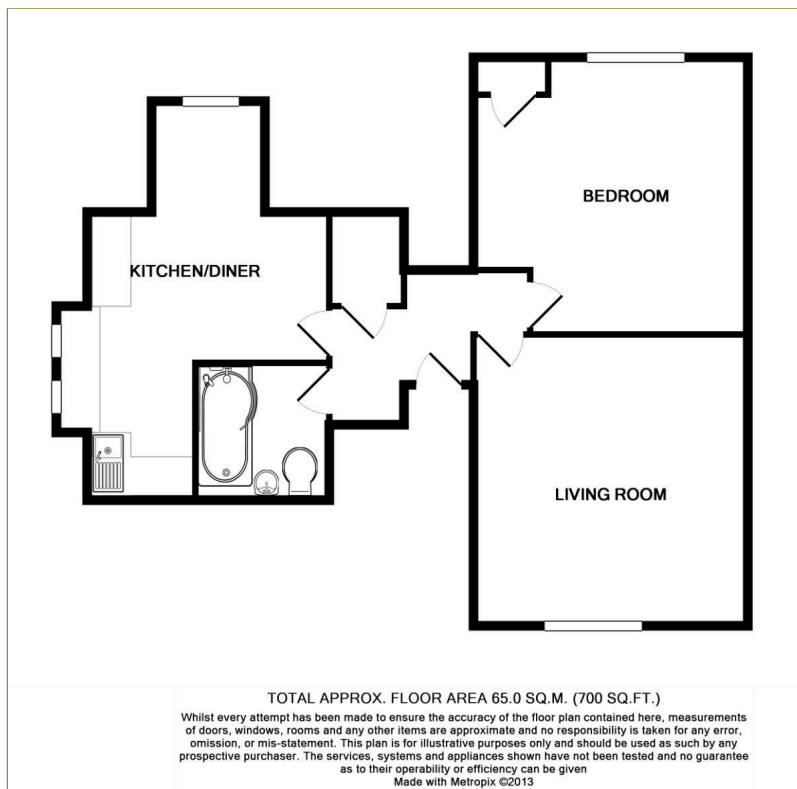

LOCATION

This image is for indicative purposes and cannot be relied upon as wholly correct

