



Charlotte Place, Grays RM20 3JF

welcome to

Charlotte Place, Grays

Situated in a private secluded corner of this popular cul-de-sac, this well presented and much improved two bedroom corner terraced house is bound to appeal. Offering Shaker style kitchen, generous corner plot with rear vehicular access. Double glazed and gas central heating.





Ground Floor

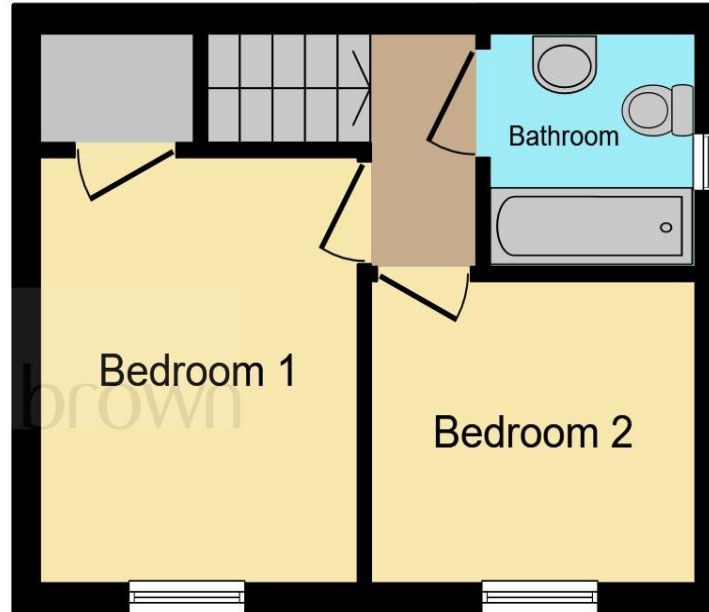

First Floor

Lounge
13' 9" x 11' 8" (4.19m x 3.56m)

Kitchen
13' 9" x 5' 3" (4.19m x 1.60m)

Landing

Bedroom One
10' 6" x 8' 3" (3.20m x 2.51m)

Bedroom Two
8' 8" x 7' 6" (2.64m x 2.29m)

Bathroom/wc

Front Garden

Rear Garden

This floorplan is for illustrative purposes only and is not drawn to scale. Measurements, floor-areas, openings and orientations are approximate. They should not be relied upon for any purpose and do not form any part of an agreement. No liability is taken for any error or mis-statement. All parties must rely on their own inspections.

welcome to

Charlotte Place, Grays

- POPULAR CUL-DE-SAC LOCATION
- LARGE THAN AVERAGE CORNER PLOT
- TWO BEDROOM PROPERTY
- SHAKER STYLE DESIGN KITCHEN
- MODERN BATHROOM SUITE

Tenure: Freehold EPC Rating: C

offers in excess of

£290,000



view this property online williamhbrown.co.uk/Property/GRA103938

Please note the marker reflects the postcode not the actual property



Property Ref:
GRA103938 - 0005

1. MONEY LAUNDERING REGULATIONS Intending purchasers will be asked to produce identification documentation at a later stage and we would ask for your co-operation in order that there is no delay in agreeing the sale. 2. These particulars do not constitute part or all of an offer or contract. 3. The measurements indicated are supplied for guidance only and as such must be considered incorrect. Potential buyers are advised to recheck measurements before committing to any expense. 4. We have not tested any apparatus, equipment, fixtures or services and it is in the buyers interest to check the working condition of any appliances. 5. Where an EPC, or a Home Report (Scotland only) is held for this property, it is available for inspection at the branch by appointment. If you require a printed version of a Home Report, you will need to pay a reasonable production charge reflecting printing and other costs. 6. We are not able to offer an opinion either written or verbal on the content of these reports and this must be obtained from your legal representative. 7. Whilst we take care in preparing these reports, a buyer should ensure that his/her legal representative confirms as soon as possible all matters relating to title including the extent and boundaries of the property and other important matters before exchange of contracts.

William H Brown incorporating Porter Glenny is a trading name of Sequence (UK) Limited which is registered in England and Wales under company number 4268443, Registered Office is Cumbria House, 16-20 Hockliffe Street, Leighton Buzzard, Bedfordshire, LU7 1GN. VAT Registration Number is 500 2481 05.

 **william h brown**
Incorporating
Porter Glenny



01375 374444



grays@williamhbrown.co.uk



1 Orsett Road, GRAYS, Essex, RM17 5DA



williamhbrown.co.uk