



Commercial
Second Floor Suite
1 Baywell House
Tucker Close,
Frome, BA11 5LS

Rent £9,150 plus VAT P/A
Ratable Value £8,500 April 2023 to present.

Located on the southern fringe of the town, opposite the town's railway station this modern purpose office suite offers a open plan working environment to with a kitchenette and WC facilities. Gated allocated parking for two vehicles.

New 5 year Lease Available

Service Charge: £865.00 PA payable quarterly, this covers insurance, external repairs, communal areas.

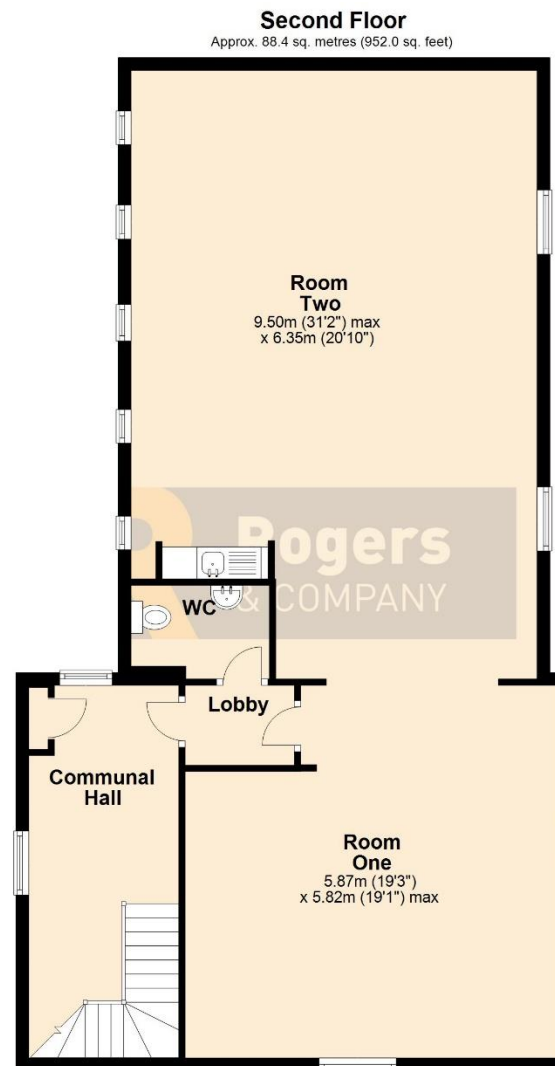
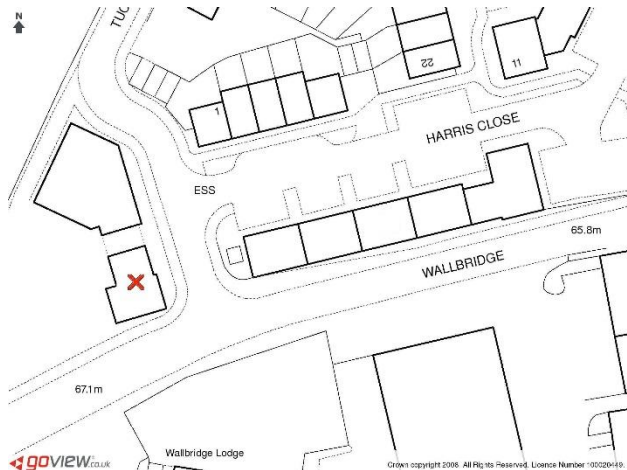

Total area: approx. 88.4 sq. metres (952.0 sq. feet)

This floor plan is a guide only
Plan produced using PlanUp.

IMPORTANT: we would like to inform prospective purchasers that these sales particulars have been prepared as a general guide only. A detailed survey has not been carried out, nor the services, appliances and fittings tested. Room sizes should not be relied upon for furnishing purposes and are approximate. If floor plans are included, they are for guidance only and illustration purposes only and may not be to scale. If there are any important matters likely to affect your decision to buy, please contact us before viewing the property.

24 Bath Street, Frome, Somerset, BA11 1DJ
T 01373 454 335
E info@rogersandcompany.co.uk
rogersandcompany.co.uk

