



**Acorn Close, Enfield, EN2 8LX**



**welcome to**  
**Acorn Close, Enfield**

Barnfields are delighted to offer for sale this three bedroom mid terraced house located in a quiet cul-de-sac location close to Gordon Hill Overground Station (Moorgate Line), good bus routes, Chase Farm Hospital and the new Wren and One Degree Academies.

The property is offered in good condition throughout, benefits from bi-fold doors opening to the garden and is offered on a chain free basis.

Must be viewed to be fully appreciated!



### Entrance Lobby

Double glazed with space for coats, internal door to:-

### Lounge

18' 6" at widest x 14' 9" at widest ( 5.64m at widest x 4.50m at widest )

Wood laminate flooring, floor to ceiling double glazed windows to front, radiator.

### Kitchen

14' 8" x 10' 3" ( 4.47m x 3.12m )

A recently fitted kitchen with a range of light grey gloss wall and base units and white Quartz worktops, undermount sink, attractive herringbone tiled splashbacks, gas hob with extractor above, built-in double oven, built-in washing machine, space for fridge freezer, matching island with breakfast bar overhang, tiled floor, Bi-fold doors opening to the garden.

### First Floor

#### Landing

Fitted carpet, loft hatch opening to loft storage space.

#### Bedroom One

15' 5" x 8' 7" ( 4.70m x 2.62m )

Double glazed windows to front, built-in cupboard, radiator, fitted carpet.

#### Bedroom Two

11' 9" x 9' 6" ( 3.58m x 2.90m )

Double glazed windows to rear, built-in cupboard, radiator, fitted carpet.

#### Bedroom Three

12' 7" x 7' 1" ( 3.84m x 2.16m )

Double glazed windows to front, radiator, fitted carpet.

### Bathroom

Recently fitted suite of panelled bath with shower attachment, hand basin, low level WC with concealed cistern, double glazed window to rear, part tiled walls, chrome heated towel rail, tiled floor.

### Outside

#### Rear Garden

A blank canvas ready for planting with wooden decked area to the front and the rest laid to lawn.



***view this property online*** [barnfields.co.uk/Property/ENF103176](https://barnfields.co.uk/Property/ENF103176)









welcome to

## Acorn Close, Enfield

- Bright & Spacious Through Lounge
- Modern Fitted Kitchen With Bi-Fold Doors To Garden
- Three Good Sized Bedrooms
- Modern Fitted First Floor Bathroom
- Close To Station

Tenure: Freehold EPC Rating: C  
Council Tax Band: E

offers in excess of

**£500,000**



Please note  
the marker  
reflects the  
postcode not  
the actual  
property

check out more properties at [barnfields.co.uk](https://barnfields.co.uk)



Property Ref:  
ENF103176 - 0002

1. MONEY LAUNDERING REGULATIONS Intending purchasers will be asked to produce identification documentation at a later stage and we would ask for your co-operation in order that there is no delay in agreeing the sale. 2. These particulars do not constitute part or all of an offer or contract. 3. The measurements indicated are supplied for guidance only and as such must be considered incorrect. Potential buyers are advised to recheck measurements before committing to any expense. 4. We have not tested any apparatus, equipment, fixtures or services and it is in the buyers interest to check the working condition of any appliances. 5. Where an EPC, or a Home Report (Scotland only) is held for this property, it is available for inspection at the branch by appointment. If you require a printed version of a Home Report, you will need to pay a reasonable production charge reflecting printing and other costs. 6. We are not able to offer an opinion either written or verbal on the content of these reports and this must be obtained from your legal representative. 7. Whilst we take care in preparing these reports, a buyer should ensure that his/her legal representative confirms as soon as possible all matters relating to title including the extent and boundaries of the property and other important matters before exchange of contracts.

Barnfields is a trading name of Sequence (UK) Limited which is registered in England and Wales under company number 4268443, Registered Office is Cumbria House, 16-20 Hockliffe Street, Leighton Buzzard, Bedfordshire, LU7 1GN. VAT Registration Number is 500 2481 05.

## Acorn Close, Enfield, EN2

Approximate Area = 894 sq ft / 83 sq m  
For identification only - Not to scale

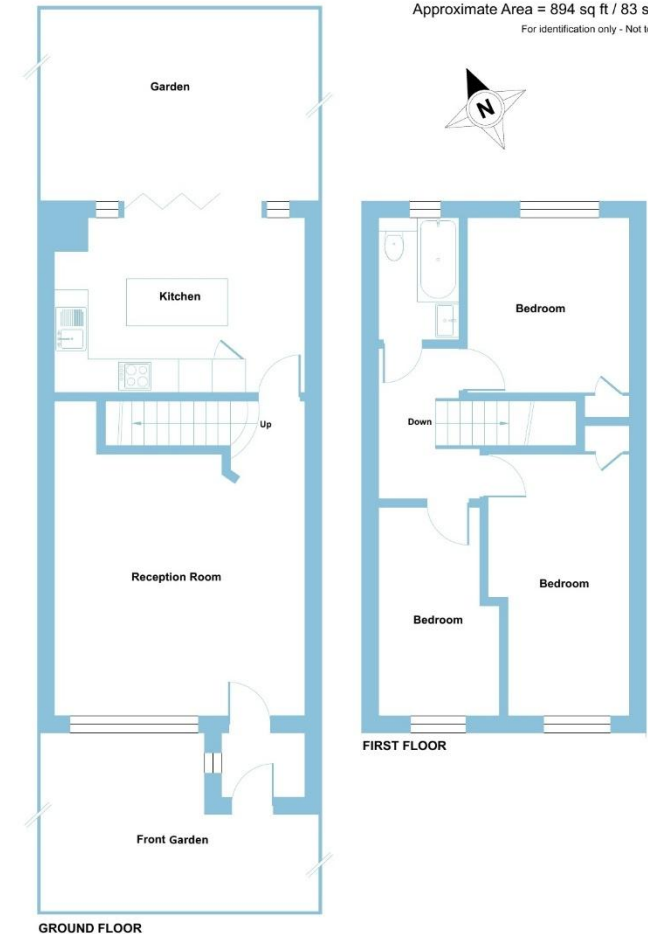

Floor plan produced in accordance with RICS Property Measurement 2nd Edition, incorporating International Property Measurement Standards (IPMS2 Residential). Produced for Barnard Marcus. REF: 1396819. © richcom 2026.



**020 8363 3394**



[info@barnfields.com](mailto:info@barnfields.com)



1a Windmill Hill, Enfield, Middlesex, EN2 6SE



**[barnfields.co.uk](https://barnfields.co.uk)**