



Chase Side, Enfield, EN2 6NQ

welcome to
Chase Side, Enfield

Barnfields are delighted to offer for sale this charming two bedroom character cottage in a most sought after location in the heart of Enfield's conservation area, just a short walk from Enfield Town Shopping Centre, Enfield Town Park, Enfield Chase Station (Moorgate Line) and with views over the open space of Chase Green.

The property has been updated by the vendor and is offered on a chain free basis. Must be viewed!





Front Door

Opens to:-

Through Lounge

20' 4" x 12' 8" (6.20m x 3.86m)

Fitted carpet, sash window to front, cast iron fireplace with stone hearth and wooden surround, understairs storage cupboard, two radiators, double glazed window and door to garden, cupboard housing meters.

Kitchen

11' 7" x 5' 8" (3.53m x 1.73m)

Range of fitted wall and base units with solid wood worktops, ceramic sink and drainer, built-in oven with gas hob above and extractor hood, space for fridge/freezer, plumbing for washing machine, tiled splashbacks, double glazed windows to side, tiled floor, double glazed door to garden, door to:-



Ground Floor Bathroom

Panelled bath with shower over and glass screen, WC with concealed cistern, hand basin with cupboards beneath, fully tiled walls and floor, radiator, double glazed window to side.

First Floor

Via staircase with fitted carpet.



Bedroom One

12' 9" x 10' (3.89m x 3.05m)

Fitted carpet, sash window to front, radiator, vaulted ceiling.

Bedroom Two

9' 11" x 9' 9" (3.02m x 2.97m)

Fitted carpet, sash window to rear, radiator, built-in cupboard housing boiler, vaulted ceiling.



Outside

Rear Garden

Side patio area rest laid to artificial lawn, rear access gate.

Front Garden

With white picket fence and gate.



view this property online barnfields.co.uk/Property/ENF104735





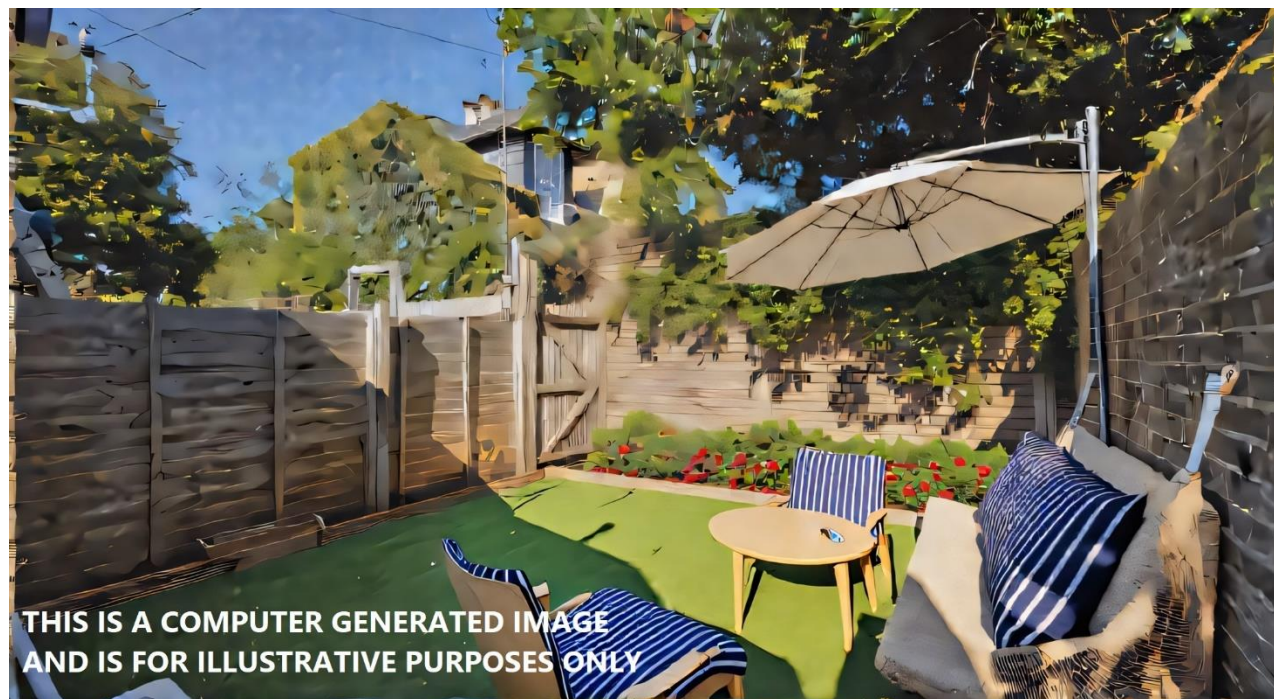

welcome to Chase Side, Enfield

- Two Bedrooms
- Through Lounge
- Modern Fitted Kitchen
- Modern Ground Floor Bathroom
- Rear And Front Gardens

Tenure: Freehold EPC Rating: E
Council Tax Band: D

Offers In Excess Of
£536,000

Please note the marker reflects the
postcode not the actual property



check out more properties at barnfields.co.uk



Property Ref:
ENF104735 - 0004

1. MONEY LAUNDERING REGULATIONS Intending purchasers will be asked to produce identification documentation at a later stage and we would ask for your co-operation in order that there is no delay in agreeing the sale. 2. These particulars do not constitute part or all of an offer or contract. 3. The measurements indicated are supplied for guidance only and as such must be considered incorrect. Potential buyers are advised to recheck measurements before committing to any expense. 4. We have not tested any apparatus, equipment, fixtures or services and it is in the buyers interest to check the working condition of any appliances. 5. Where an EPC, or a Home Report (Scotland only) is held for this property, it is available for inspection at the branch by appointment. If you require a printed version of a Home Report, you will need to pay a reasonable production charge reflecting printing and other costs. 6. We are not able to offer an opinion either written or verbal on the content of these reports and this must be obtained from your legal representative. 7. Whilst we take care in preparing these reports, a buyer should ensure that his/her legal representative confirms as soon as possible all matters relating to title including the extent and boundaries of the property and other important matters before exchange of contracts.

Barnfields is a trading name of Sequence (UK) Limited which is registered in England and Wales under company number 4268443, Registered Office is Cumbria House, 16-20 Hockliffe Street, Leighton Buzzard, Bedfordshire, LU7 1GN. VAT Registration Number is 500 2481 05.

Chase Side, Enfield, EN2

Approximate Area = 628 sq ft / 58.3 sq m
For identification only - Not to scale

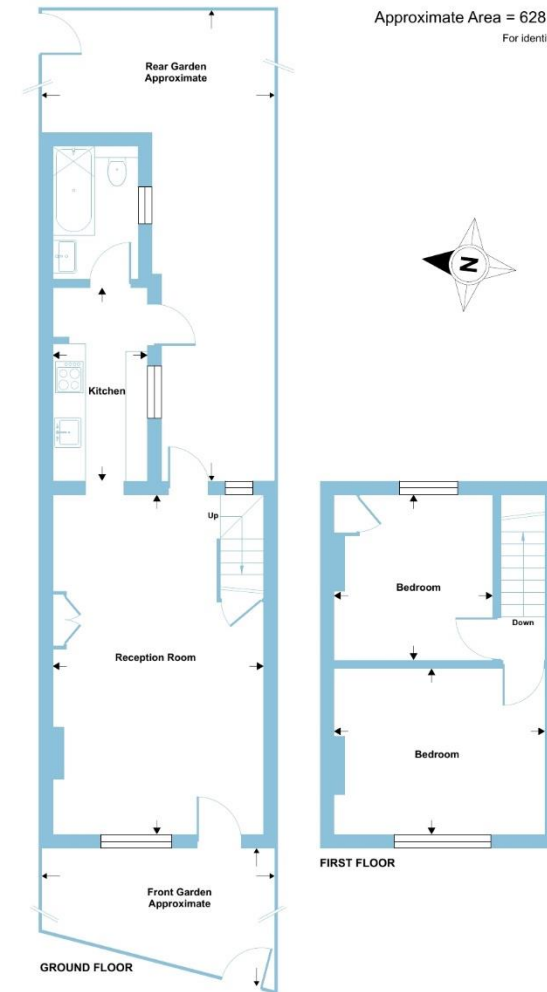

Floor plan produced in accordance with RICS Property Measurement 2nd Edition, Incorporating International Property Measurement Standards (IPMS2 Residential). © nrichcom 2025. Produced for Barnard Marcus. REF: 1327580

barnfields

barnfields



020 8363 3394



info@barnfields.com



1a Windmill Hill, Enfield, Middlesex, EN2 6SE



barnfields.co.uk