



**Kings Chase View, The Ridgeway, Enfield, EN2 8LG**



**welcome to**

## **Kings Chase View, The Ridgeway, Enfield**

A superb garden flat with its own private patio, located just off Enfield Ridgeway, within easy access of Enfield Town multiple shopping centre and rail stations (Moorgate Line).

This very spacious one bedroom apartment is extremely well presented throughout and has many pleasing features.







### **Entrance Lobby**

Fitted carpet, double built-in storage cupboard.

### **L Shaped Entrance Hall**

### **Lounge**

20' x 12' 3" ( 6.10m x 3.73m )

Fitted carpet, entryphone, two radiators, double glazed French windows onto patio and gardens, open planned to kitchen.

### **Kitchen**

9' 9" x 8' 5" ( 2.97m x 2.57m )

Beautifully fitted in modern white units, comprising base units with worktops, matching wall cabinets, inset sink unit, inset ceramic hob, built-in oven, plumbing for washing machine, space for tumble dryers, cupboard housing combination gas central heating boiler.



### **Bedroom**

16' 3" x 10' 5" ( 4.95m x 3.17m )

Fitted carpet, radiator, range of built-in wardrobe cupboards.

### **Modern Shower Room / WC**

Large shower cubicle with rain shower, vanity wash hand basin with cupboards under, low flush WC, vinyl floor, heated towel rail, part tiled walls.



### **Outside**

### **Patio**

Own west facing private patio with wall.

### **Parking**

One allocated parking space at rear.



***view this property online*** [barnfields.co.uk/Property/ENF104671](http://barnfields.co.uk/Property/ENF104671)







welcome to

## Kings Chase View, The Ridgeway, Enfield

- 20' Lounge With Doors Onto Garden
- Allocated Parking Space
- Share Of Freehold
- Modern Shower Room / WC
- Large Double Bedroom

Tenure: Leasehold EPC Rating: C

This is a Leasehold property with details as follows; Term of Lease 999 years from 01 Jan 2013. Should you require further information please contact the branch. Please Note additional fees could be incurred for items such as Leasehold packs.

# £340,000



Please note the marker reflects the postcode not the actual property



## Kings Chase View, The Ridgeway, Enfield, EN2

Approximate Area = 589 sq ft / 54.7 sq m  
For identification only - Not to scale

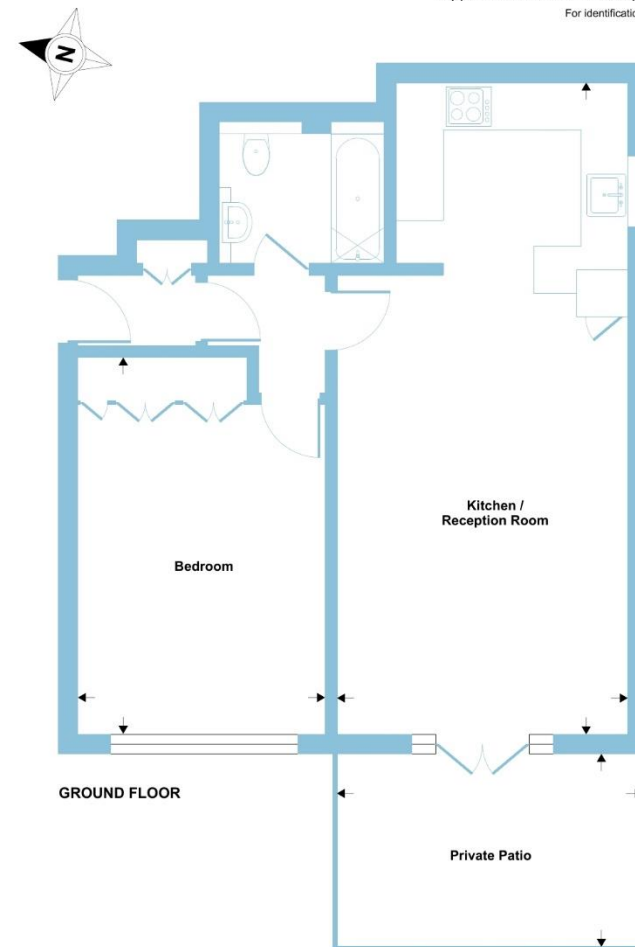

 Certified Property Measurer  
Floor plan produced in accordance with RICS Property Measurement Standards incorporating International Property Measurement Standards (IPMS2 Residential). © rickhcom 2024. Produced for Barnard Marcus. REF: 1190402. 

check out more properties at [barnfields.co.uk](https://www.barnfields.co.uk)



Property Ref:  
ENF104671 - 0003

1. MONEY LAUNDERING REGULATIONS Intending purchasers will be asked to produce identification documentation at a later stage and we would ask for your co-operation in order that there is no delay in agreeing the sale. 2. These particulars do not constitute part or all of an offer or contract. 3. The measurements indicated are supplied for guidance only and as such must be considered incorrect. Potential buyers are advised to recheck measurements before committing to any expense. 4. We have not tested any apparatus, equipment, fixtures or services and it is in the buyers interest to check the working condition of any appliances. 5. Where an EPC, or a Home Report (Scotland only) is held for this property, it is available for inspection at the branch by appointment. If you require a printed version of a Home Report, you will need to pay a reasonable production charge reflecting printing and other costs. 6. We are not able to offer an opinion either written or verbal on the content of these reports and this must be obtained from your legal representative. 7. Whilst we take care in preparing these reports, a buyer should ensure that his/her legal representative confirms as soon as possible all matters relating to title including the extent and boundaries of the property and other important matters before exchange of contracts.

Barnfields is a trading name of Sequence (UK) Limited which is registered in England and Wales under company number 4268443, Registered Office is Cumbria House, 16-20 Hockliffe Street, Leighton Buzzard, Bedfordshire, LU7 1GN. VAT Registration Number is 500 2481 05.





020 8363 3394



info@barnfields.com



1a Windmill Hill, Enfield, Middlesex, EN2 6SE



[barnfields.co.uk](https://www.barnfields.co.uk)