



Gordon Hill, Enfield, EN2 0QP

welcome to
Gordon Hill, Enfield

A rare opportunity to acquire this beautifully appointed three bedroom semi-detached 1920's character house situated in this most desirable and popular residential location, just minutes from shops, restaurants, parks and within close proximity of several well regarded schools (both Primary and Secondary) and within easy access of Gordon Hill Rail Station (Moorgate Line), greenbelt countryside and the M25 Motorway.

The property has been modernised throughout to a high standard and is beautifully presented.



Entrance Hall

Wood effect vinyl floor, double radiator, dado rail, understairs storage/meter cupboard.

Dual Aspect Through Lounge

27' into bay x 12' 9" max (8.23m into bay x 3.89m max)

Wood effect floor, picture rail, two double radiators, open fireplace, attractive bay window to front aspect, French doors to garden.

Kitchen

13' 4" x 7' 10" (4.06m x 2.39m)

Beautifully fitted in a range of matching base, wall and display cupboards (light grey) with Quartz worksurface, breakfast bar and splashback with inset one and half bowl composite sink and drainer, integrated fridge-freezer, oven and grill, hob with fume extractor fan over, coving to ceiling, sunken spotlights to ceiling, casement door to garden.

First Floor

Landing

Fitted carpet, dado rail, access to loft with pull down ladder, window to side.

Bedroom One

12' 10" x 11' 7" (3.91m x 3.53m)

Wood effect floor, double radiator, range of floor to ceiling wardrobe cupboards (one housing gas central heating boiler).

Bedroom Two

11' 5" x 9' 9" to wardrobe fronts (3.48m x 2.97m to wardrobe fronts)

Wood effect floor, double radiator, two double built-in wardrobe cupboards with cupboards over.

Bedroom Three

8' x 8' (2.44m x 2.44m)

Wood effect floor, double radiator.

Bathroom

Beautifully appointed in a modern suite comprising low flush WC, vanity basin with cupboards under, mixer tap over, panelled bath with mixer tap and shower attachment, glass shower screen, heated towel rail, extractor fan, sunken spotlights to ceiling, ceramic tiled floor, fully tiled walls.

Outside

Front Garden

Composite driveway providing off-street parking for at least 2 vehicles.

Rear Garden

Beautifully tended rear garden with mature shrubs, bushes and flowers to side and rear, laid to lawn, paved patio with brick retaining wall, tap, security lights, timber shed 10' 9" x 5' 7" with power and light with attached potting shed, WC and wash hand basin.



view this property online barnfields.co.uk/Property/ENF102359







welcome to

Gordon Hill, Enfield

- Dual Aspect Through Lounge
- Off-Street Parking
- Beautifully Tended Rear Garden
- Three Bedrooms
- Close To Good Schools

Tenure: Freehold EPC Rating: E

Offers In Excess Of

£675,000



Please note the marker reflects the postcode not the actual property

check out more properties at [barnfields.co.uk](https://www.barnfields.co.uk)



Property Ref:
ENF102539 - 0004

1. MONEY LAUNDERING REGULATIONS Intending purchasers will be asked to produce identification documentation at a later stage and we would ask for your co-operation in order that there is no delay in agreeing the sale. 2. These particulars do not constitute part or all of an offer or contract. 3. The measurements indicated are supplied for guidance only and as such must be considered incorrect. Potential buyers are advised to recheck measurements before committing to any expense. 4. We have not tested any apparatus, equipment, fixtures or services and it is in the buyers interest to check the working condition of any appliances. 5. Where an EPC, or a Home Report (Scotland only) is held for this property, it is available for inspection at the branch by appointment. If you require a printed version of a Home Report, you will need to pay a reasonable production charge reflecting printing and other costs. 6. We are not able to offer an opinion either written or verbal on the content of these reports and this must be obtained from your legal representative. 7. Whilst we take care in preparing these reports, a buyer should ensure that his/her legal representative confirms as soon as possible all matters relating to title including the extent and boundaries of the property and other important matters before exchange of contracts.

Barnfields is a trading name of Sequence (UK) Limited which is registered in England and Wales under company number 4268443, Registered Office is Cumbria House, 16-20 Hockliffe Street, Leighton Buzzard, Bedfordshire, LU7 1GN. VAT Registration Number is 500 2481 05.

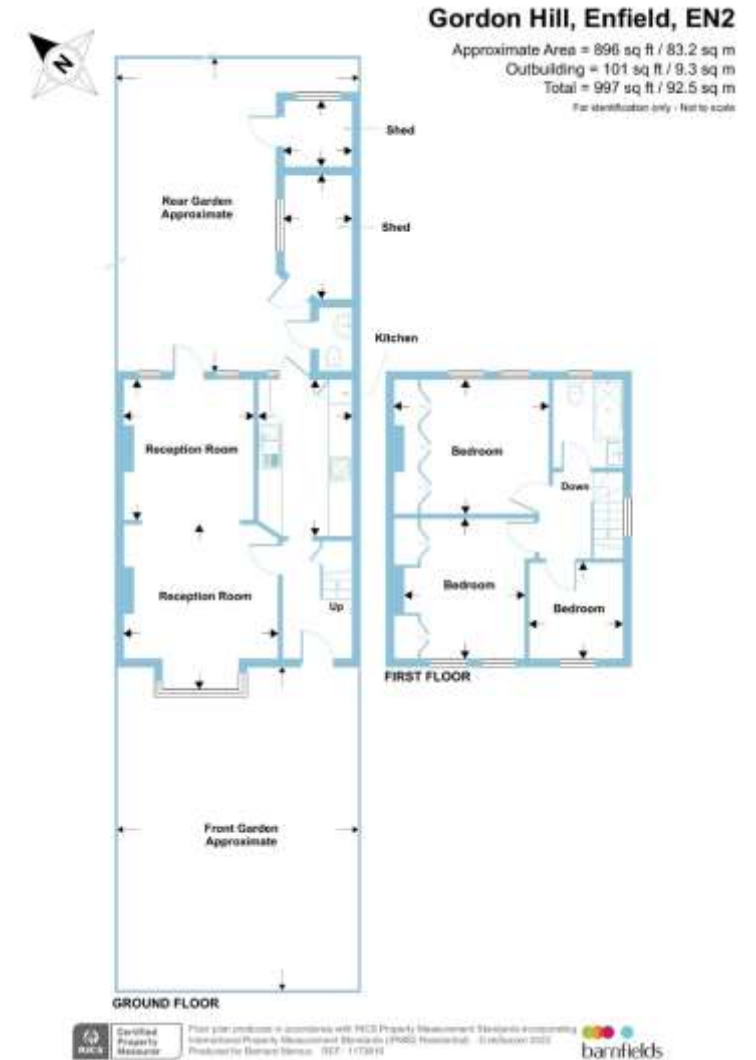

020 8363 3394



info@barnfields.com



1a Windmill Hill, Enfield, Middlesex, EN2 6SE



[barnfields.co.uk](https://www.barnfields.co.uk)