



**Oakwood Crescent, London, N21 1PA**

**welcome to**  
**Oakwood Crescent, London**

Barnfields are pleased to offer for sale this spacious semi-detached family house in a superb location, opposite the popular Eversley Primary School and backing onto and with views over Oakwood Park. Both Oakwood Underground Station (Piccadilly Line) and Winchmore Hill Rail Station (Moorgate Line) are within easy reach, together with other good schools, Trent Park Country Park and both Enfield and Southgate multiple shopping centres.

The well presented accommodation features:-



### **Double Glazed Entrance Porch**

### **Spacious Entrance Hall**

Fitted carpet, radiator.

### **Downstairs Cloakroom / WC**

Low flush WC, bracket wash hand basin, fully tiled walls, wall mounted combination gas central heating boiler.

### **Dining Room**

14' 9" into bay x 12' 6" ( 4.50m into bay x 3.81m )  
Laminate floor, radiator.

### **Lounge**

17' 1" x 11' 2" ( 5.21m x 3.40m )  
Fitted carpet, radiator, fireplace.

### **Kitchen**

14' 1" x 7' 1" ( 4.29m x 2.16m )  
Base units with worktops, wall cabinets, inset gas hob unit with fume extractor hood over, built-in double oven, inset one and half bowl stainless steel sink unit, plumbing for washing machine, integrated dishwasher, radiator, door to garden.

### **First Floor**

### **Spacious Landing**

Fitted carpet, radiator, access to loft via built-in ladder.

### **Bedroom One**

15' 4" into bay x 12' 6" ( 4.67m into bay x 3.81m )  
Fitted carpet, radiator, range of built-in wardrobe cupboards.

### **Bedroom Two**

13' 9" x 11' 2" ( 4.19m x 3.40m )  
Fitted carpet, radiator, views over park.

### **Bedroom Three**

11' 6" x 6' ( 3.51m x 1.83m )  
Fitted carpet, radiator.

### **Spacious Bathroom/ Shower Room**

Panelled bath, separate shower cubicle, vanity wash hand basin with cupboard under, low flush WC, bidet, vinyl floor, fully tiled walls, airing cupboard housing lagged copper cylinder hot water tank.

### **Outside**

### **Front Garden**

Brick paved providing off-street parking and brick paved shared side driveway to garage.

### **Garage**

18' x 8' 2" ( 5.49m x 2.49m )  
Brick built, up and over door, tiled and pitched roof.

### **Rear Garden**

Approximately 90' west facing rear garden, backing onto Oakwood Park, mainly laid to lawn, patio, flower and shrub borders, pedestrian door into garage and potting shed, greenhouse, timber shed.



**view this property online** [barnfields.co.uk/Property/ENF104396](http://barnfields.co.uk/Property/ENF104396)







welcome to

## Oakwood Crescent, London

- No Chain
- Views Over Park
- Spacious Lounge
- Large Dining Room
- Three Good Sized Bedrooms

Tenure: Freehold EPC Rating: D

# £900,000



Please note the marker reflects the postcode not the actual property

check out more properties at [barnfields.co.uk](https://www.barnfields.co.uk)



Property Ref:  
ENF104394 - 0003

1. MONEY LAUNDERING REGULATIONS Intending purchasers will be asked to produce identification documentation at a later stage and we would ask for your co-operation in order that there is no delay in agreeing the sale. 2. These particulars do not constitute part or all of an offer or contract. 3. The measurements indicated are supplied for guidance only and as such must be considered incorrect. Potential buyers are advised to recheck measurements before committing to any expense. 4. We have not tested any apparatus, equipment, fixtures or services and it is in the buyers interest to check the working condition of any appliances. 5. Where an EPC, or a Home Report (Scotland only) is held for this property, it is available for inspection at the branch by appointment. If you require a printed version of a Home Report, you will need to pay a reasonable production charge reflecting printing and other costs. 6. We are not able to offer an opinion either written or verbal on the content of these reports and this must be obtained from your legal representative. 7. Whilst we take care in preparing these reports, a buyer should ensure that his/her legal representative confirms as soon as possible all matters relating to title including the extent and boundaries of the property and other important matters before exchange of contracts.

Barnfields is a trading name of Sequence (UK) Limited which is registered in England and Wales under company number 4268443, Registered Office is Cumbria House, 16-20 Hockliffe Street, Leighton Buzzard, Bedfordshire, LU7 1GN. VAT Registration Number is 500 2481 05.

## Oakwood Crescent, London, N21

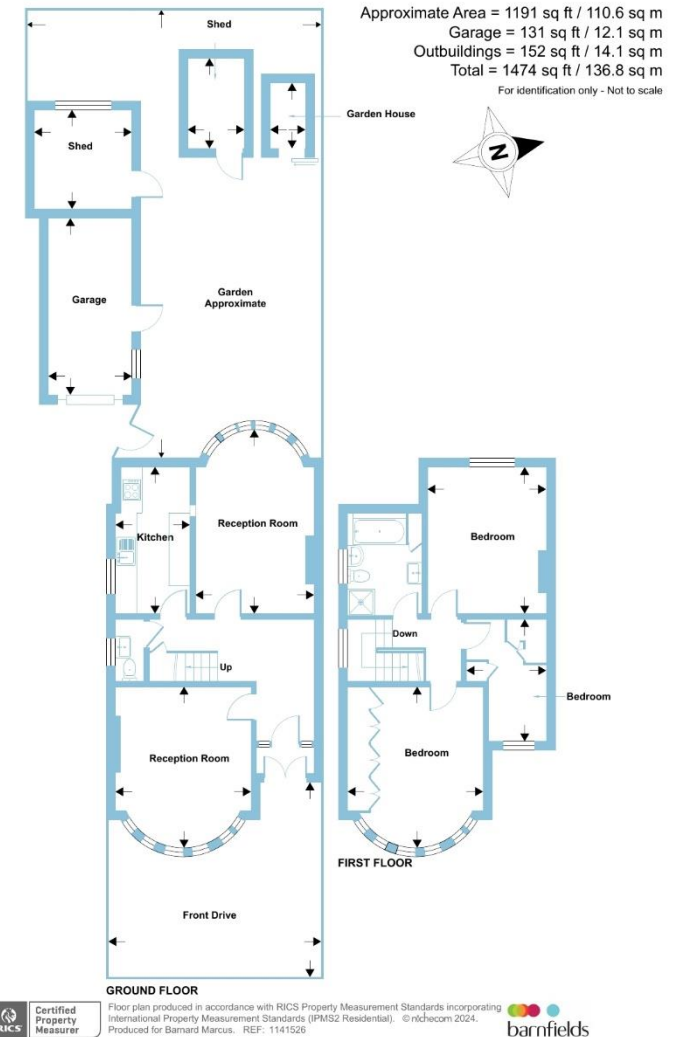

barnfields



020 8363 3394



info@barnfields.com



1a Windmill Hill, Enfield, Middlesex, EN2 6SE



[barnfields.co.uk](https://www.barnfields.co.uk)