



Offers in Excess of
£375,000 Freehold



21 The Spinney
Down End
Fareham
PO16 8QD

- Two Double Bedrooms
- Own Drive and Garage
- South Facing Garden
- Some Modernising Required

Email - portchester@jeffries.co.uk Tel - 023 9243 5000

"Situated in the popular location of The Spinney is this detached 2 double bedroom bungalow requiring internal refurbishment. Located on the southern side providing a sunny rear garden, the property offers two double bedrooms, two reception areas, spacious kitchen, own driveway and garage. With scope for extending and as mentioned in need of improvement, viewing is most certainly advised."

Matt Spacey, Senior Branch Manager, Fareham and Portchester Office

PORCH

Double glazed door to:

HALL

Cupboard, radiator, doors leading to:

LOUNGE

15' 0" x 10' 7" (4.57m x 3.23m) Rear aspect double doors and windows leading to Sun Lounge, fireplace with hearth and gas fire, radiator, opening to:

DINING ROOM

10' 6" x 9' 10" (3.2m x 3m) Rear aspect double glazed window, radiator, door to:

KITCHEN

12' 2" x 9' 0" (3.71m x 2.74m) Side aspect double glazed window, door to utility. Wall and base units, sink and drainer unit, space for range cooker, space for washing machine, wood block work surfaces, tiled surrounds.

UTILITY SPACE

6' 0" x 5' 5" (1.83m x 1.65m) Side aspect double glazed door to garden, cupboard, space for two appliances.

BEDROOM

13' 5" x 12' 2" (4.09m x 3.71m) Front aspect double glazed window, double wardrobe cupboard, radiator.

BEDROOM

13' 11" x 10' 6" (4.24m x 3.2m) Front aspect double glazed window, double wardrobe cupboard, overhead storage and dressing table area, radiator.

BATHROOM

Side aspect double glazed window. Panelled bath with shower over, pedestal hand basin, tiled walls, radiator.

WC

Side aspect window, low flush WC, wall mounted hand basin

GARDEN

South facing rear garden with lawned area, covered patio area, bedding areas, side pedestrian access, personal door to:

FRONT

Lawn area, own printed concrete driveway leading to:

DETACHED GARAGE

Up and over door, power and light.



Free solicitor quotes available on request



AGENTS' NOTE: All measurements shown are approximate and may have been taken with a sonic measure and therefore should be verified. No electrical, mechanical or gas appliances have been tested by a representative of this company. These particulars do not constitute any part of an offer or contract. None of the statements contained in these particulars are to be relied on as statements or representations of fact and any intending purchaser must satisfy himself by inspection or otherwise to the correctness of each of the statements contained in these particulars. The Vendor does not make or give, and neither Jeffries & Partners nor any person in their employment has any authority to make or give, any representation or warranty whatever in relation to this property. Jeffries & Partners Ltd. Registered in England No. 3185348 registered office: 196 Havant Road, Drayton, Portsmouth, PO6 2EH

Visit our 'Graham Jeffries Mortgage Desk'

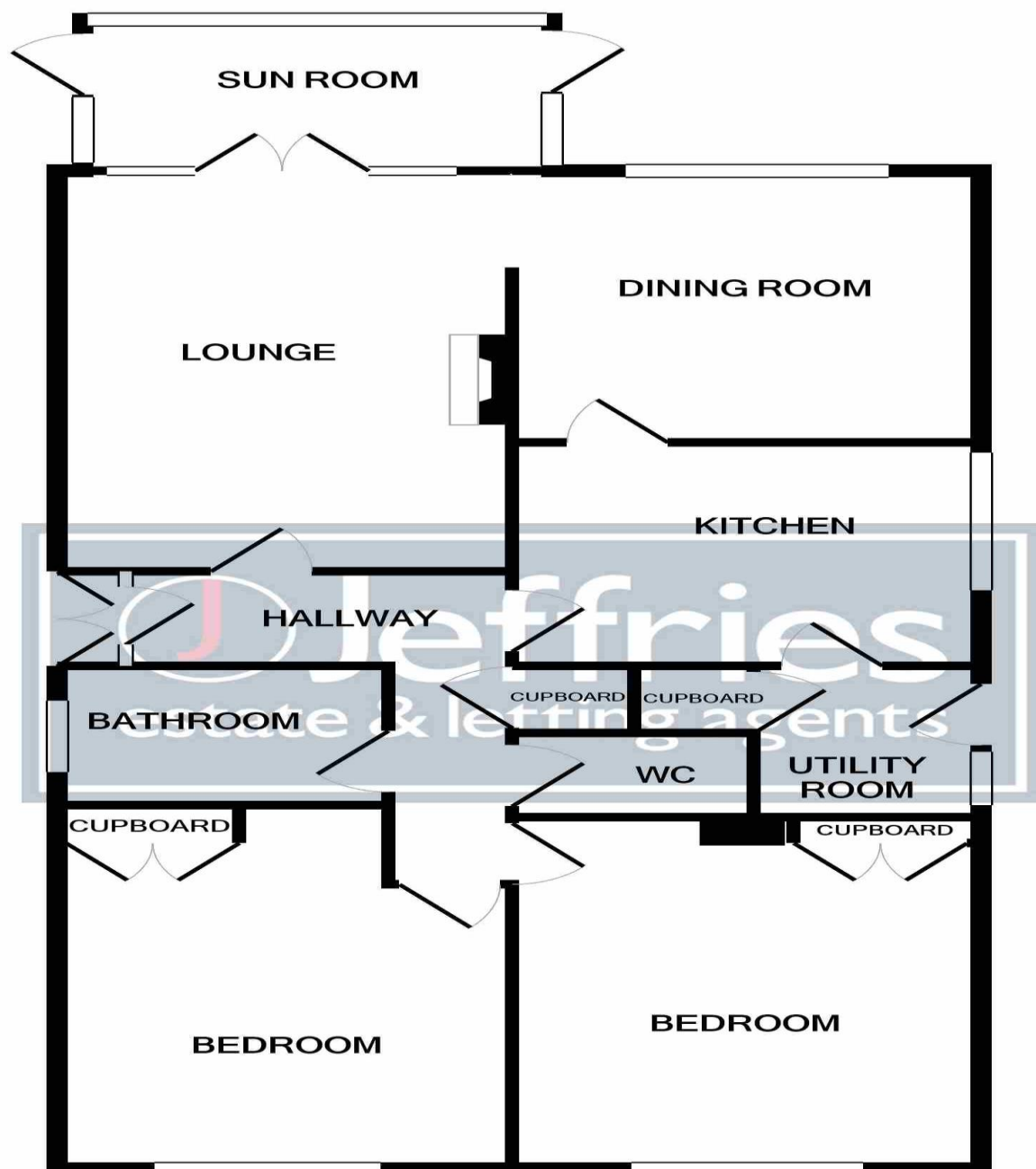

Whilst every attempt has been made to ensure the accuracy of the floor plan contained here, measurements of doors, windows, rooms and any other items are approximate and no responsibility is taken for any error, omission, or mis-statement. This plan is for illustrative purposes only and should be used as such by any prospective purchaser. The services, systems and appliances shown have not been tested and no guarantee as to their operability or efficiency can be given
Made with Metropix ©2020

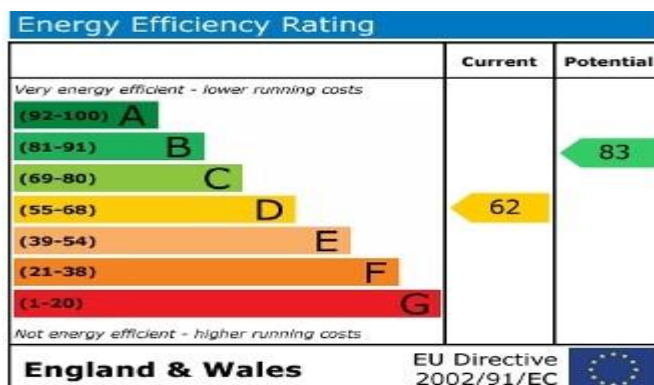

See hundreds of properties on www.zoopla.co.uk