

**£280,000**  
**227 White Hart Lane**  
Portchester, PO16 9AT



## PROPERTY SUMMARY

\*\*\*NO FORWARD CHAIN\*\*\* We are pleased to present to the market this two bedroom semi-detached chalet bungalow, located on the sought after road of White Hart Lane. The property comprises of a sitting room, a shower room, a kitchen, a good size bedroom, a study room/third bedroom, a garden room to the rear as well as an additional bedroom to the first floor. Upstairs, there is potential within the loft space to add a bathroom/ensuite (STPP). The garden is mainly laid to lawn with side access to a garage which can be accessed via a private lane at the rear of the property. Please contact our Portchester Office to book in a viewing!







## **FRONT**

### **ENTRANCE HALL**

### **KITCHEN**

8' 10" x 8' 0" (2.69m x 2.44m)

### **LIVING ROOM**

14' 07" x 10' 06" (4.44m x 3.2m)

### **GARDEN ROOM**

16' 06" x 4' 11" (5.03m x 1.5m)

### **BEDROOM 1**

13' 02" x 10' 05" (4.01m x 3.18m)

### **BEDROOM 2**

11' 11" x 11' 11" (3.63m x 3.63m)

### **BEDROOM 3/STUDY**

8' 05" x 7' 05" (2.57m x 2.26m)

### **SHOWER ROOM**

### **GARAGE**

15' 04" x 8' 02" (4.67m x 2.49m)

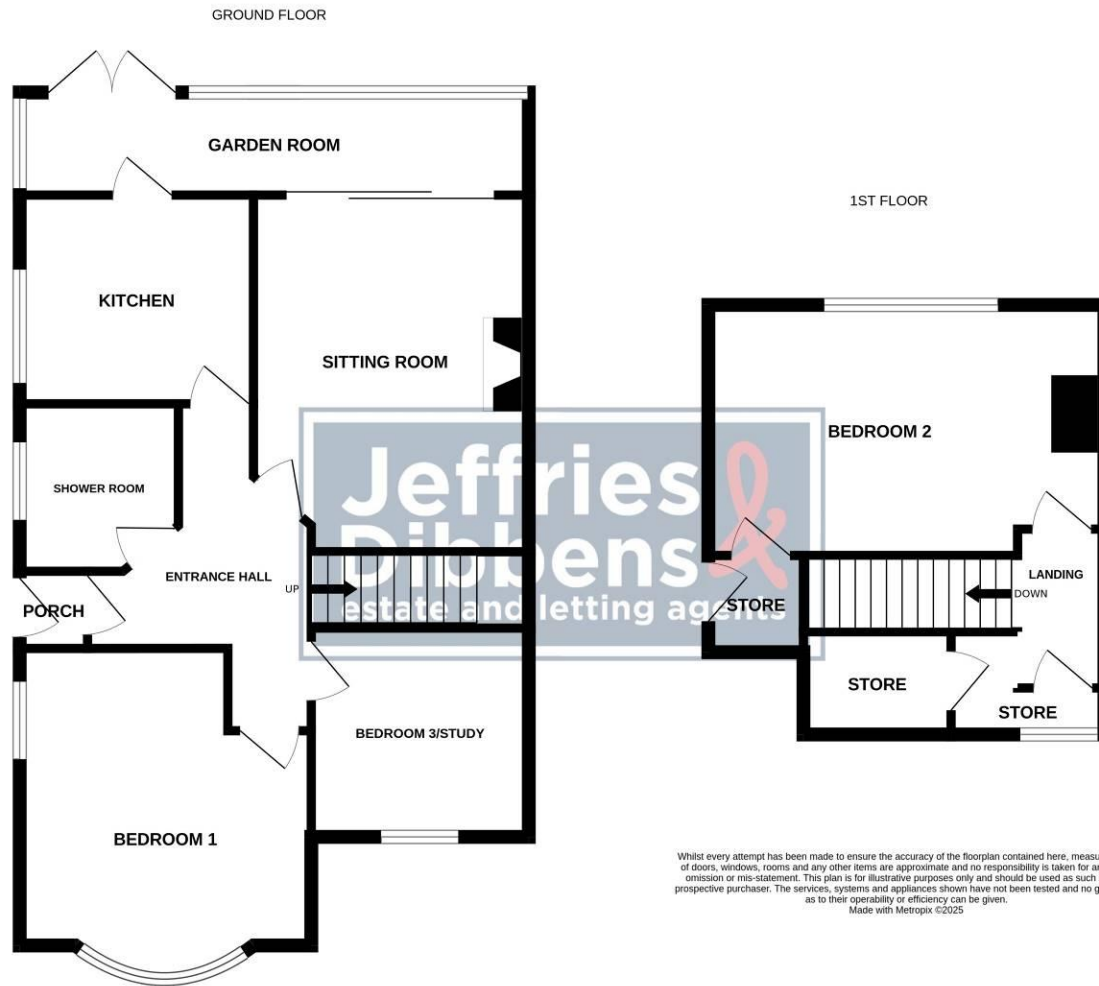

**LOCAL AUTHORITY**  
Fareham Borough Council

**TENURE**  
Freehold

**COUNCIL TAX BAND**  
Band C

**VIEWINGS**  
By prior appointment only

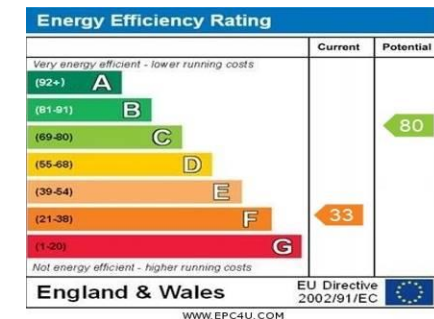

Agents Note: Whilst every care has been taken to prepare these particulars, they are for guidance purposes only. All measurements are approximate and are for general guidance purposes only and whilst every care has been taken to ensure their accuracy, they should not be relied upon and potential buyers/tenants are advised to recheck the measurements.

**Jeffries  
Dibbens**  
estate and letting agents

**OFFICE ADDRESS**  
78 West Street, Portchester,  
Fareham, PO16 9UN

**CONTACT**  
023 9243 5000  
portchester@jeffries.co.uk  
www.jdea.co.uk