



**£450,000**  
**54c Cornaway Lane**  
Fareham, PO16 9DD

## PROPERTY SUMMARY

We're pleased to present to the market one of two individually built bungalows in a private location in Cornaway Lane. The properties flexible accommodation is split over two floors and briefly comprises of three double bedrooms, a modern shower room, a bathroom, a lounge, as well as a spacious kitchen. Externally there is a well maintained sunny rear garden with spaces for activities and dining. There is also off road parking located to the front of the property. To arrange your viewing contact our Portchester Office today!





**FRONT** Off road parking, front door to property, side access to rear garden.

**HALLWAY**

**LOUNGE** 13' 09" x 5' 08" (4.19m x 1.73m)

**KITCHEN** 15' 08" x 9' 06" (4.78m x 2.9m)

**SHOWER ROOM**

**BEDROOM THREE** 12' 05" x 12' 01" (3.78m x 3.68m)

**LANDING**

**BEDROOM ONE** 12' 05" x 10' 05" (3.78m x 3.18m)

**BEDROOM TWO** 18' 0" x 12' 02" (5.49m x 3.71m)

**BATHROOM** 12' 05" x 6' 06" (3.78m x 1.98m)

**REAR GARDEN**



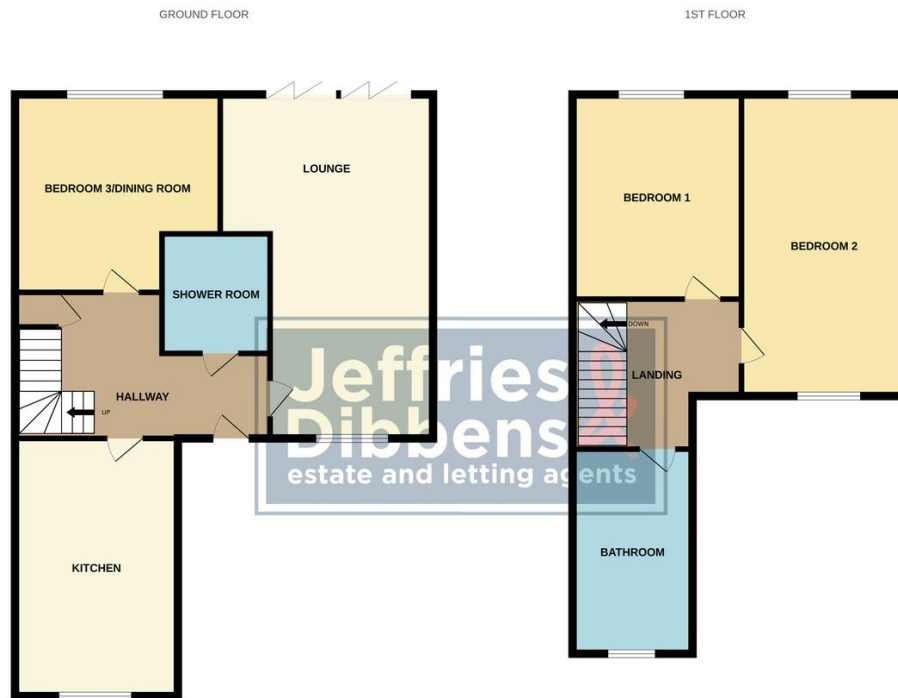

Whilst every attempt has been made to ensure the accuracy of the floorplan contained here, measurements of doors, windows, rooms and any other items are approximate and no responsibility is taken for any error, omission or mis-statement. This plan is for illustrative purposes only and should be used as such by any prospective purchaser. The services, systems and appliances shown have not been tested and no guarantee as to their operability or efficiency can be given.  
Made with Metropix ©2024

**LOCAL AUTHORITY**  
Fareham Borough Council

**TENURE**  
Freehold

**COUNCIL TAX BAND**  
Band D

**VIEWINGS**  
By prior appointment only

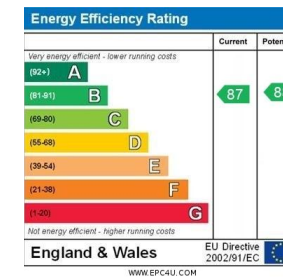

Agents Note: Whilst every care has been taken to prepare these particulars, they are for guidance purposes only. All measurements are approximate and are for general guidance purposes only and whilst every care has been taken to ensure their accuracy, they should not be relied upon and potential buyers/tenants are advised to recheck the measurements



**OFFICE ADDRESS**  
78 West Street, Portchester,  
Fareham, PO16 9UN

**CONTACT**  
023 9243 5000  
portchester@jeffries.co.uk  
www.jdea.co.uk