



**£385,000**  
**6 Seaway Grove**  
Fareham, PO16 9HZ



## PROPERTY SUMMARY

We're pleased to present to the market this well presented semi detached bungalow located on Seaway Grove, Portchester, only a short walk to the shoreline. The property consists of three good size bedrooms, a modern fitted shower room, a spacious 22' lounge/diner, a kitchen and a conservatory. A particular selling point of the property is the low maintenance rear garden with a large Summer House with power and lighting located at the back of the garden. Other benefits include off road parking and gas central heating. To arrange your viewing contact our Portchester Office today!





**FRONT** Off road parking, side access to rear garden.

**HALLWAY**

**BEDROOM ONE** 12' 05 into bay" x 10' 04" (3.78m x 3.15m)

**BEDROOM TWO** 9' 04" x 8' 04" (2.84m x 2.54m)

**BEDROOM THREE** 11' 10" x 6' 10" (3.61m x 2.08m)

**SHOWER ROOM**

**LOUNGE/DINER** 22' 05" x 10' 04" (6.83m x 3.15m)

**KITCHEN** 9' 11" x 9' 07" (3.02m x 2.92m)

**CONSERVATORY** 9' 01" x 7' 09" (2.77m x 2.36m)

**REAR GARDEN**

**SUMMER HOUSE** 18' 10" x 15' 05" (5.74m x 4.7m) Power & Lighting.



GROUND FLOOR

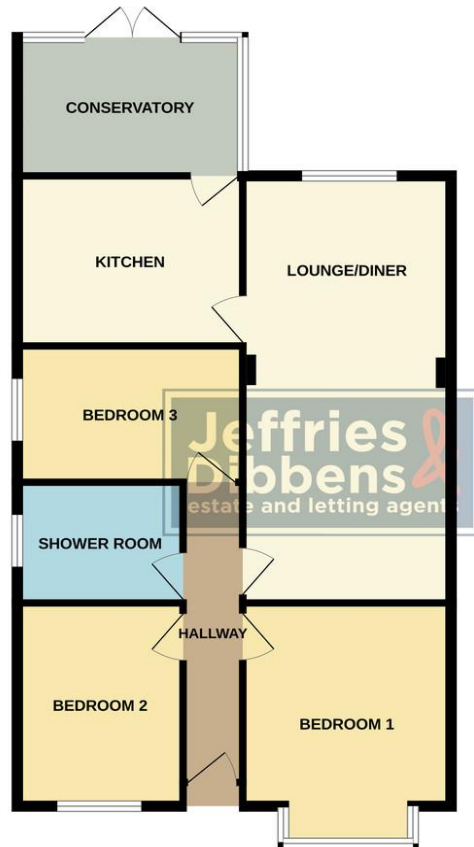

Whilst every attempt has been made to ensure the accuracy of the floorplan contained here, measurements of doors, windows, stairs and any other items are approximate and no responsibility is taken for any error, omission or mis-statement. This plan is for illustrative purposes only and should be used as such by any prospective purchaser. The services, systems and appliances shown have not been tested and no guarantee as to their operability or efficiency can be given.  
Made with Metopolis ©2024

**LOCAL AUTHORITY**  
Fareham Borough Council

**TENURE**  
Freehold

**COUNCIL TAX BAND**  
Band C

**VIEWINGS**  
By prior appointment only

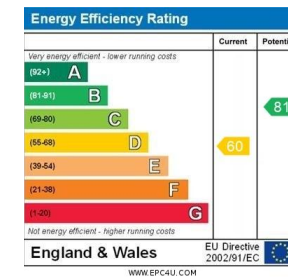

Agents Note: Whilst every care has been taken to prepare these particulars, they are for guidance purposes only. All measurements are approximate and are for general guidance purposes only and whilst every care has been taken to ensure their accuracy, they should not be relied upon and potential buyers/tenants are advised to recheck the measurements

**Jeffries  
Dibbens &**  
estate and letting agents

**OFFICE ADDRESS**  
78 West Street, Portchester,  
Fareham, PO16 9UN

**CONTACT**  
023 9243 5000  
portchester@jeffries.co.uk  
www.jdea.co.uk