



GUIDE PRICE  
**£380,000-£400,000**  
**14 Sandport Grove**  
Portchester, PO16 9EA

## PROPERTY SUMMARY

Guide Price £400,000-£415,000. We're pleased to present to the market this three bedroom detached bungalow in the popular residential location of Sandport Grove, Portchester. The property is offered with no onward chain and consists of three spacious bedrooms, kitchen, bathroom, good size lounge/diner and conservatory. Externally you will find both front and rear gardens, as well as a garage with additional parking. To arrange your viewing contact the Portchester Office today!





**FRONT GARDEN AND DRIVE.**

**PORCH**

**HALLWAY**

**BEDROOM ONE** 14' 02" x 10' 09" (4.32m x 3.28m)

**BEDROOM TWO** 10' 04" x 10' 03" (3.15m x 3.12m)

**BEDROOM THREE** 11' 00" x 8' 10" (3.35m x 2.69m)

**KITCHEN** 10' 11" x 6' 07" (3.33m x 2.01m)

**LEAN TO**

**LOUNGE/DINER** 20' 10" x 10' 11" max (6.35m x 3.33m)

**BATHROOM**

**CONSERVATORY** 13' 06" x 9' 06" (4.11m x 2.9m)

**REAR GARDEN**

**REAR GARAGE AND DRIVEWAY**



GROUND FLOOR

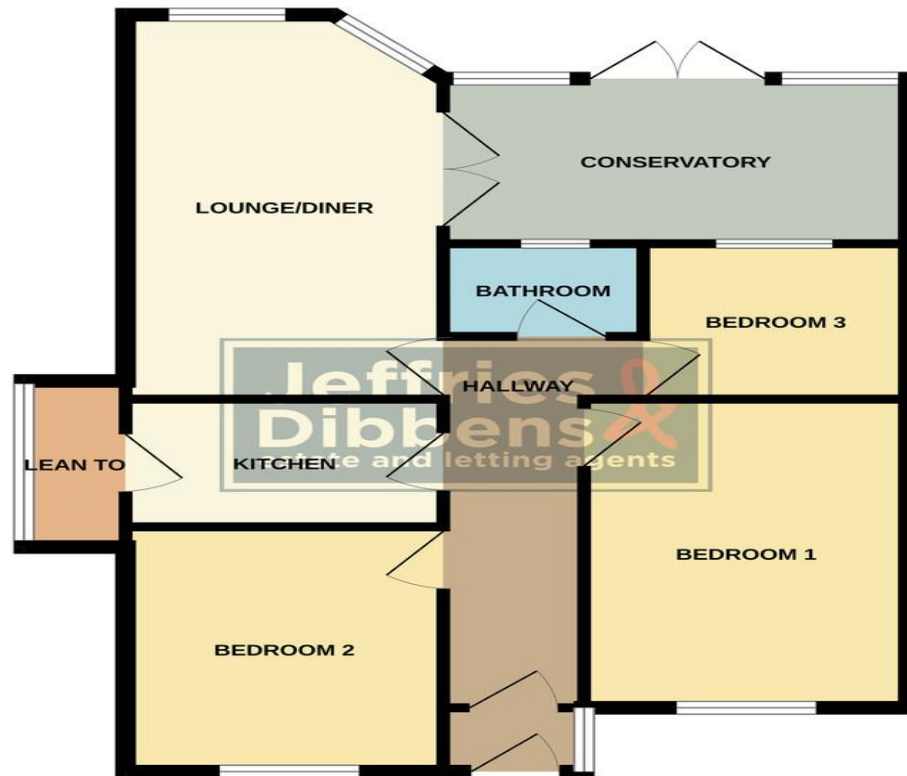

Whilst every attempt has been made to ensure the accuracy of the floorplan contained here, measurements of doors, windows, rooms and any other items are approximate and no responsibility is taken for any error, omission or mis-statement. This plan is for illustrative purposes only and should be used as such by any prospective purchaser. The services, systems and appliances shown have not been tested and no guarantee as to their operability or efficiency can be given.  
Made with Metropix ©2024

**LOCAL AUTHORITY**  
Fareham Borough Council

**TENURE**  
Freehold

**COUNCIL TAX BAND**  
Band D

**VIEWINGS**  
By prior appointment only

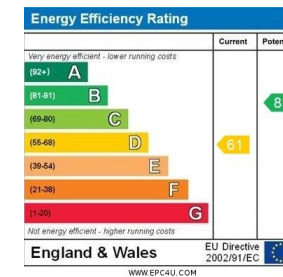

Agents Note: Whilst every care has been taken to prepare these particulars, they are for guidance purposes only. All measurements are approximate and are for general guidance purposes only and whilst every care has been taken to ensure their accuracy, they should not be relied upon and potential buyers/tenants are advised to recheck the measurements



**OFFICE ADDRESS**  
78 West Street, Portchester,  
Fareham, PO16 9UN

**CONTACT**  
023 9243 5000  
portchester@jeffries.co.uk  
www.jdea.co.uk