

£274,400

Oberon Close

Waterlooville, PO7 8LF

PROPERTY SUMMARY

No forward chain! Ideal first time or investment purchase! Tucked away in a quiet cul-de-sac in the very popular Tempest area of Waterlooville, we are delighted to offer for sale this 2 bedroom property. The property boasts 2 well proportioned first floor bedrooms, a bathroom suite, lounge and fitted kitchen. Externally there is allocated park and a well maintained rear garden. Early interest is expected so to avoid disappointment call us as sole agents today!





PORCH Door to:

LOUNGE 18' 10" x 12' 4" (5.74m x 3.76m) Window to front aspect, two radiators, stairs to the first floor, door leading to:

KITCHEN 12' 2" x 8' 0" (3.71m x 2.44m) A range of wall and base units with work surfaces and sink, integral oven with hob and fan over, space for washing machine and tumble dryer, cupboard housing the boiler, radiator, windows and door leading to rear aspect.

LANDING Doors all first floor rooms, access to the loft.

BEDROOM 1 12' 4" x 10' 4" (3.76m x 3.15m) Window to front aspect, radiator.

BEDROOM 2 12' 4" x 8' 1" (3.76m x 2.46m) Window to rear aspect, radiator, cupboard housing the hot water cylinder.

BATHROOM Panel enclosed bath with shower over, wash hand basin, radiator, W.C, extractor fan.

OUTSIDE

FRONT GARDEN Area laid to lawn.

REAR GARDEN Area laid to lawn, patio area, outside tap, shed.

ALLOCATED PARKING Space for one car in a nearby block.

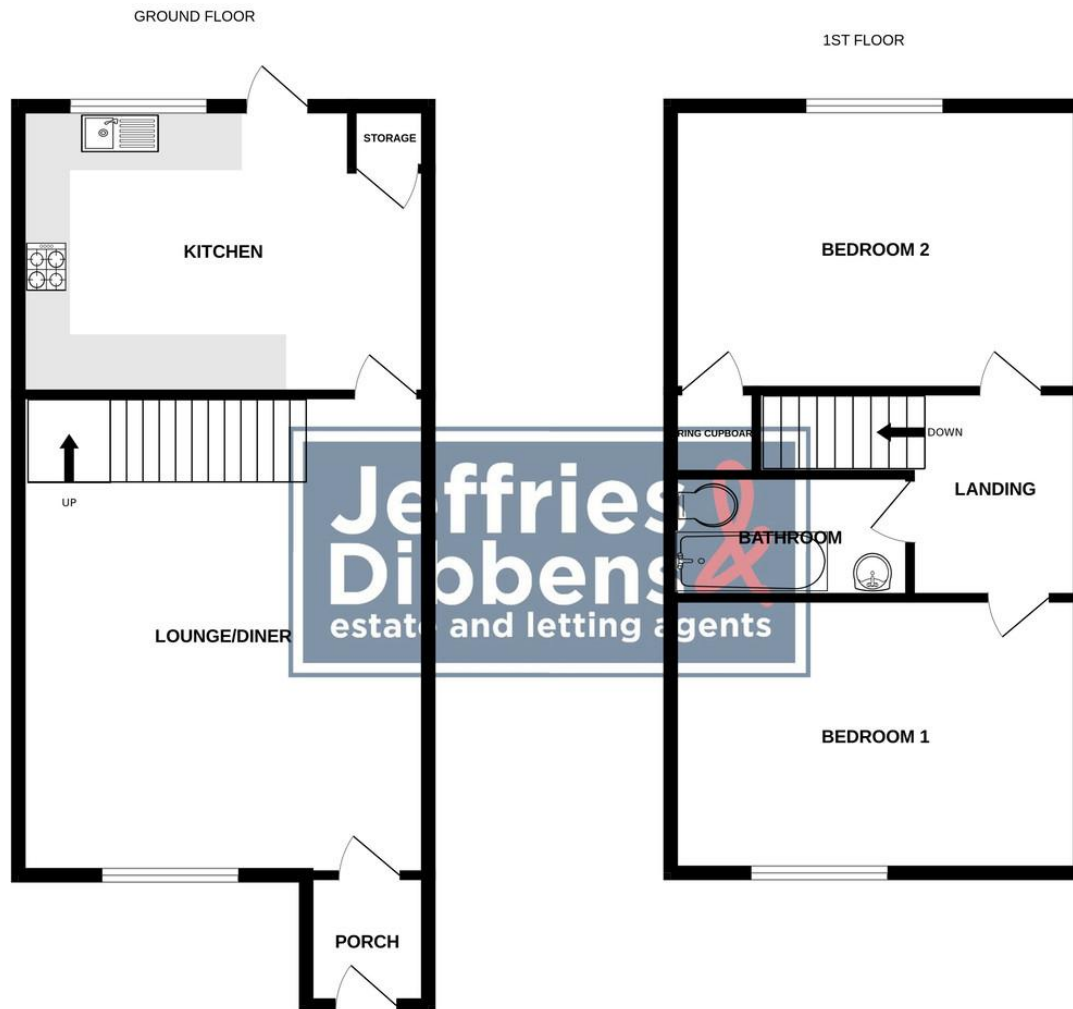

Whilst every attempt has been made to ensure the accuracy of the floorplan contained here, measurements of doors, windows, rooms and any other items are approximate and no responsibility is taken for any error, omission or mis-statement. This plan is for illustrative purposes only and should be used as such by any prospective purchaser. The services, systems and appliances shown have not been tested and no guarantee as to their operability or efficiency can be given.
Made with Metropix ©2025

LOCAL AUTHORITY
Havant Borough Council

TENURE
Freehold

COUNCIL TAX BAND
Band B

VIEWINGS
By prior appointment only

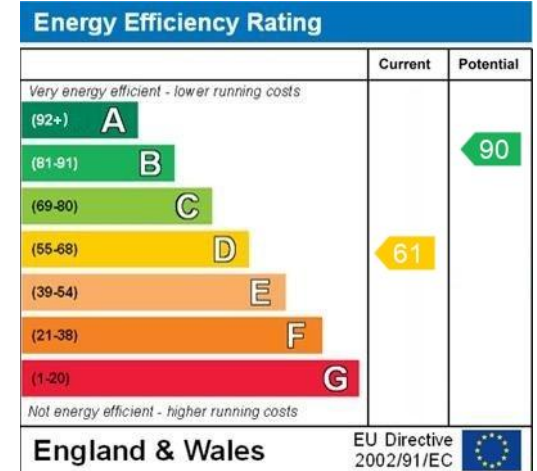

Jeffries Dibbens
estate and letting agents

OFFICE ADDRESS
226 London Road, Waterlooville,
Hampshire, PO7 7HP

CONTACT
023 9223 1100
waterlooville@jeffries.co.uk
www.jdea.co.uk

Agents Note: Whilst every care has been taken to prepare these particulars, they are for guidance purposes only. All measurements are approximate and are for general guidance purposes only and whilst every care has been taken to ensure their accuracy, they should not be relied upon and potential buyers/tenants are advised to recheck the measurements