



Guide Price **£650,000**  
**Clouds Hill, Hambledon Road**  
Denmead, PO7 6LT

## PROPERTY SUMMARY

Located in one of the most popular areas of Denmead and having been completely modernised to a very high standard throughout, we are delighted to offer for sale this extended 4 double bedroom semi detached house on Hambledon Road. 'Clouds Hill' is an exquisite family home boasting wonderful views and is immaculately presented throughout and has to be seen internally to be fully appreciated. The property has 4 double bedrooms arranged over 2 floors, 3 bathroom suites (2 of them en-suite), dressing area, lounge, open plan kitchen/diner and an additional WC. Externally there is a large rear garden, outbuilding/office and considerable off road parking. Offered with no forward chain early interest is expected and viewings can be arranged by contact Jeffries & Dibbens as sole agents.









GROUND FLOOR

1ST FLOOR

2ND FLOOR

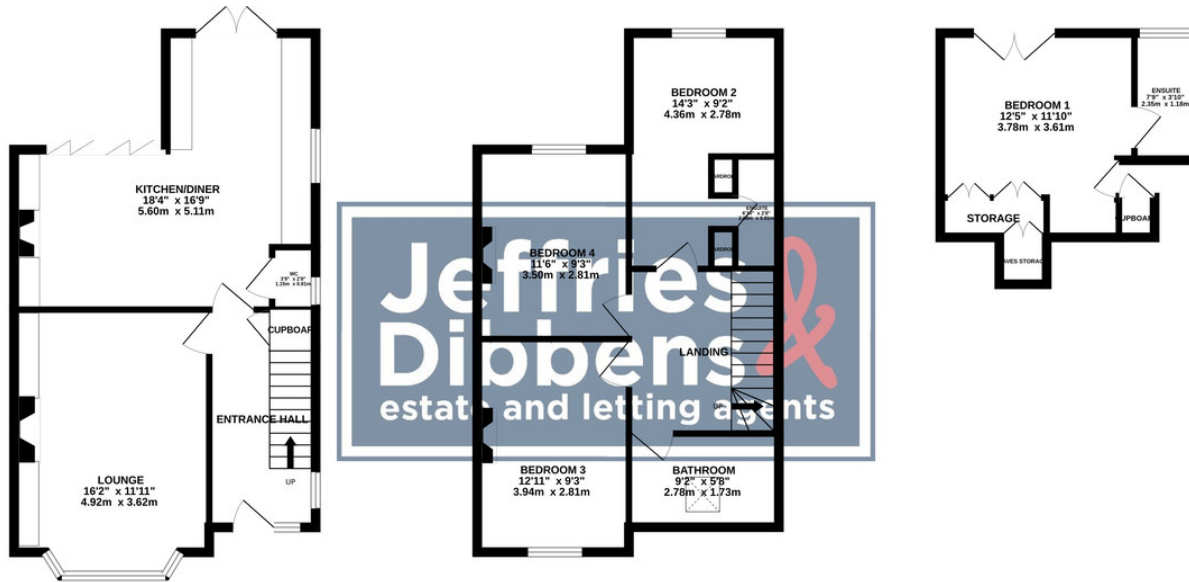

Whilst every attempt has been made to ensure the accuracy of the floorplan contained here, measurements of doors, windows, rooms and any other items are approximate and no responsibility is taken for any error, omission or mis-statement. This plan is for illustrative purposes only and should be used as such by any prospective purchaser. The services, systems and appliances shown have not been tested and no guarantee as to their operability or efficiency can be given.  
 Made with Metropix ©2024

**LOCAL AUTHORITY**  
 Winchester City Council

**TENURE**  
 Freehold

**COUNCIL TAX BAND**  
 Band D

**VIEWINGS**  
 By prior appointment only

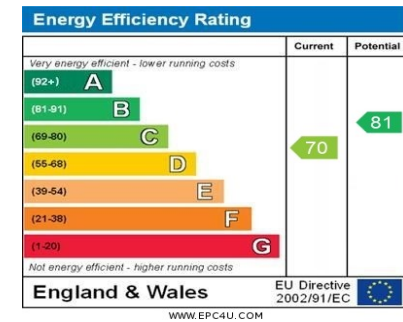

Agents Note: Whilst every care has been taken to prepare these particulars, they are for guidance purposes only. All measurements are approximate and are for general guidance purposes only and whilst every care has been taken to ensure their accuracy, they should not be relied upon and potential buyers/tenants are advised to recheck the measurements



**OFFICE ADDRESS**  
 226 London Road, Waterlooville,  
 Hampshire, PO7 7HP

**CONTACT**  
 023 9223 1100  
 waterlooville@jeffries.co.uk  
 www.jdea.co.uk