



£325,000

19 Chalk Dock Avenue

West Bedhampton, PO9 3FF

PROPERTY SUMMARY

We're pleased to present to the market this two bedroom end of terrace property located on a newly built development in Chalk Dock Avenue. The property consists of a lounge, modern kitchen/breakfast room, downstairs WC as well as two double bedrooms and a family bathroom located to the first floor. Externally there is a south facing rear garden and off road parking for two vehicles. To arrange your viewing contact out Drayton Office today!





FRONT Off road parking, front door to property.

HALLWAY

LOUNGE 12' 8" x 11' 5" (3.86m x 3.48m)

WC

KITCHEN 14' 7" x 9' 4" (4.44m x 2.84m)

LANDING

BEDROOM ONE 11' 06" x 11' 06" (3.51m x 3.51m)

BEDROOM TWO 11' 2" x 8' 3" (3.4m x 2.51m)

BATHROOM

REAR GARDEN

Please note that once the estate is finished we expect there to be an estate charge introduced for the maintenance of the area. Please ask for further details.



GROUND FLOOR

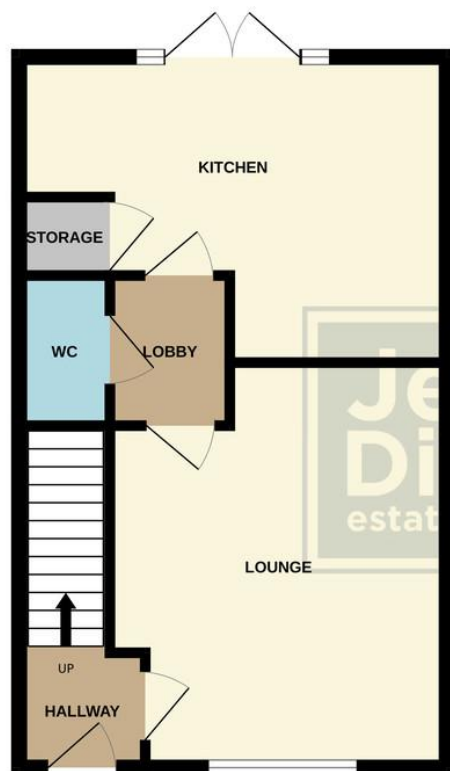

1ST FLOOR

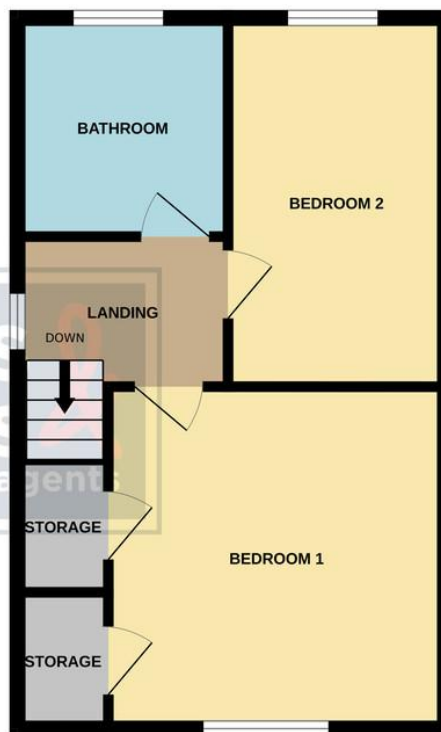

Whilst every attempt has been made to ensure the accuracy of the floorplan contained here, measurements of doors, windows, rooms and any other items are approximate and no responsibility is taken for any error, omission or mis-statement. This plan is for illustrative purposes only and should be used as such by any prospective purchaser. The services, systems and appliances shown have not been tested and no guarantee as to their operability or efficiency can be given.
Made with Metropix ©2025

LOCAL AUTHORITY
Havant Borough Council

TENURE
Freehold

COUNCIL TAX BAND
Band C

VIEWINGS
By prior appointment only

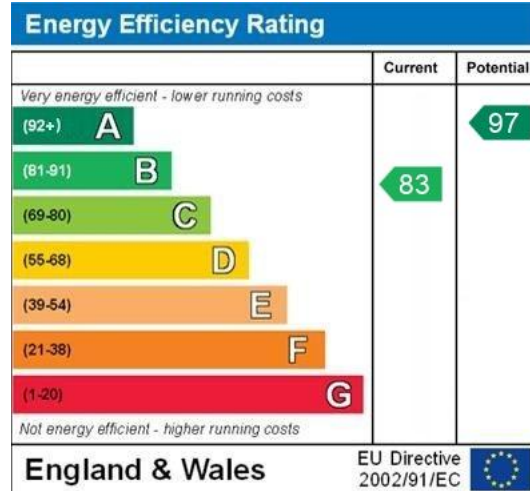

**Jeffries
Dibbens**
estate and letting agents

OFFICE ADDRESS
196 Havant Road, Drayton,
Portsmouth, Hampshire,
PO6 2EH

CONTACT
023 9237 3341
drayton@jeffries.co.uk
www.jdea.co.uk

Agents Note: Whilst every care has been taken to prepare these particulars, they are for guidance purposes only. All measurements are approximate and are for general guidance purposes only and whilst every care has been taken to ensure their accuracy, they should not be relied upon and potential buyers/tenants are advised to recheck the measurements