

£339,995
31 Old College Walk
Portsmouth, PO6 2DB

PROPERTY SUMMARY

Offered with NO FORWARD CHAIN this four bedroom property is situated in the quiet residential location of Old College Walk and within easy access to local amenities, transport links and train station. The properties accommodation is spread over three floors and briefly consists of a kitchen/breakfast room, a lounge, four good size bedrooms of which the master boasts en suite facilities, a family bathroom and a downstairs WC. Other benefits include a low maintenance rear garden and allocated parking. To arrange your viewing contact our Drayton Office today!





ENTRANCE HALL

LOUNGE 13' 7" x 12' 10" (4.14m x 3.91m)

KITCHEN/DINER 17' 6" x 7' 11" (5.33m x 2.41m)

CLOAKROOM/WC

FIRST FLOOR LANDING

BEDROOM TWO 12' 11" x 12' 5" (3.94m x 3.78m)

BEDROOM FOUR 11' x 6' 2" (3.35m x 1.88m)

FAMILY BATHROOM 6' 9" x 6' 3" (2.06m x 1.91m)

SECOND FLOOR LANDING

BEDROOM ONE 15' 3 "max x 12' 10" max (4.65m max x 3.91m max)

EN-SUITE SHOWER ROOM 7' 6" x 4' 7" (2.29m x 1.4m)

BEDROOM THREE 11' 8" x 9' 4" (3.56m x 2.84m)

OUTSIDE

REAR GARDEN

FRONT Allocated parking.



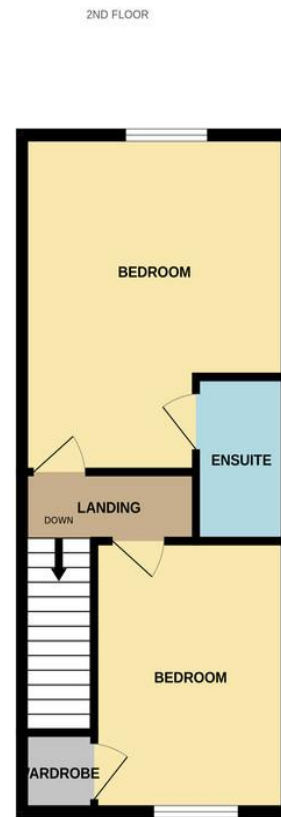
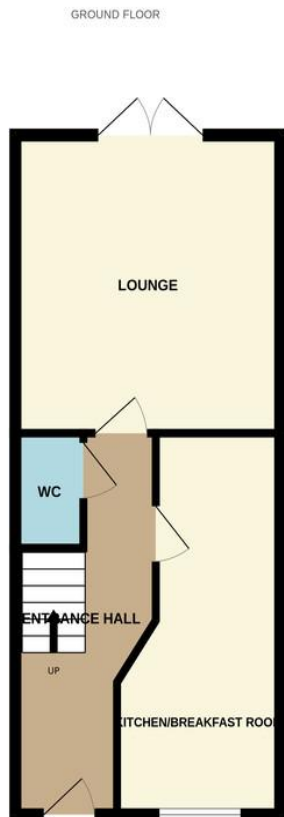

Whilst every attempt has been made to ensure the accuracy of the floorplan contained here, measurements of doors, windows, rooms and any other items are approximate and no responsibility is taken for any error, omission or mis-statement. This plan is for illustrative purposes only and should be used as such by any prospective purchaser. The services, systems and appliances shown have not been tested and no guarantee as to their operability or efficiency can be given.
Made with Metropix ©2025

LOCAL AUTHORITY
Portsmouth City Council

TENURE
Freehold

COUNCIL TAX BAND
Band D

VIEWINGS
By prior appointment only

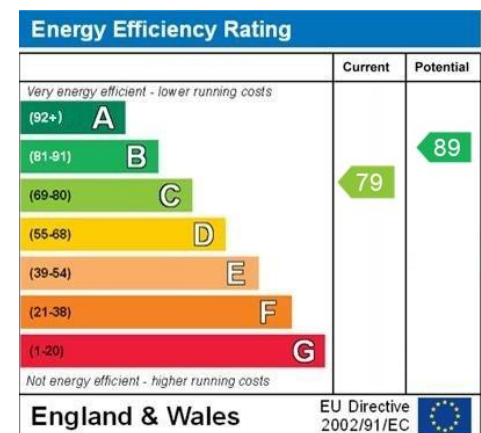

Agents Note: Whilst every care has been taken to prepare these particulars, they are for guidance purposes only. All measurements are approximate and are for general guidance purposes only and whilst every care has been taken to ensure their accuracy, they should not be relied upon and potential buyers/tenants are advised to recheck the measurements

**Jeffries
Dibbens &**
estate and letting agents

OFFICE ADDRESS
196 Havant Road, Drayton,
Portsmouth, Hampshire,
PO6 2EH

CONTACT
023 9237 3341
drayton@jeffries.co.uk
www.jdea.co.uk