

£550,000
24 Sea View Road
Drayton, PO6 1EW

PROPERTY SUMMARY

**** FOUR/FIVE BEDROOM, DETACHED, SOUTH FACING REAR GARDEN, AMPLE OFF ROAD PARKING **** Jeffries and Dibbens are delighted to offer for sale this four bedroom detached chalet bungalow situated in the popular hillslope location of Sea View Road, Drayton. Set within the school catchment for both Solent and Springfield, this home boasts versatile living accommodation including a 22'5 lounge, 22'5 kitchen/diner, two double bedrooms, shower room and utility room to the ground floor with two further double bedrooms, WC and a sitting room with sea views to the first floor. Other benefits include ample off road parking, an approx. 80' south facing rear garden, double glazing and gas central heating. To arrange your accompanied viewing, contact Jeffries and Dibbens (Drayton).





DESCRIPTION ** FOUR/FIVE BEDROOM DETACHED, SOUTH FACING REAR GARDEN, AMPLE OFF ROAD PARKING ** Jeffries and Dibbens are delighted to offer for sale this four/five bedroom detached chalet bungalow situated in the popular hillslope location of Sea View Road, Drayton. Set within the school catchment for both Solent and Springfield, this home boasts versatile living accommodation including a 22'5 lounge, 22'5 kitchen/diner, two double bedrooms, shower room and utility room to the ground floor with two further double bedrooms, WC and a sitting room with sea views to the first floor. Other benefits include ample off road parking, an approx. 80' south facing rear garden, double glazing and gas central heating. To arrange your accompanied viewing, contact Jeffries and Dibbens (Drayton).

ENTRANCE HALL 12' 3" x 9' 4" (3.73m x 2.84m)

BEDROOM 15' 3" x 12' 5" (4.65m x 3.78m)

BEDROOM 15' 3" x 10' 7" (4.65m x 3.23m)

SHOWER ROOM 10' 8" x 5' 6" (3.25m x 1.68m)

UTILITY ROOM 10' 8" x 4' 7" (3.25m x 1.4m)

LOUNGE 22' 5" x 13' 0" (6.83m x 3.96m)

KITCHEN/DINER 22' 5" x 11' 2" (6.83m x 3.4m)

LANDING 10' 3" x 2' 8" (3.12m x 0.81m)

BEDROOM 14' 9" x 11' 8" (4.5m x 3.56m)

WC 5' 9" x 4' 10" (1.75m x 1.47m)

BEDROOM 14' 9" x 13' 1" (4.5m x 3.99m)

SITTING ROOM 15' 10" x 8' 11" (4.83m x 2.72m)

REAR GARDEN Approx. 80' 0" x 37' 0" (24.38m x 11.28m) South facing.

FRONT GARDEN Block paved driveway providing ample off road parking.

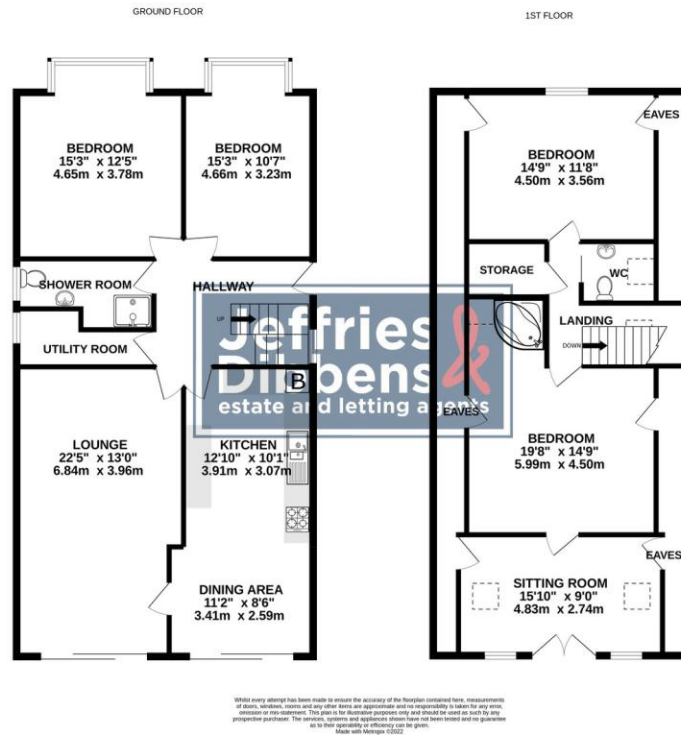

LOCAL AUTHORITY
Portsmouth City Council

TENURE
Freehold

COUNCIL TAX BAND
Band E

VIEWINGS
By prior appointment only

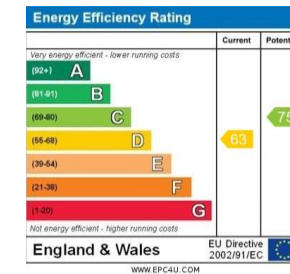

Agents Note: Whilst every care has been taken to prepare these particulars, they are for guidance purposes only. All measurements are approximate and are for general guidance purposes only and whilst every care has been taken to ensure their accuracy, they should not be relied upon and potential buyers/tenants are advised to recheck the measurements.

As part of our legal obligations under the **Money Laundering, Terrorist Financing and Transfer of Funds (Information on the Payer) Regulations 2017**, we are required to conduct an **electronic identity verification check** on all purchasers. Please note that this is **not a credit check** and will **not affect your credit history** in any way. Purchasers are required to make a one off payment of £24 inc VAT to facilitate this requirement.

**Jeffries
Dibbens**
estate and letting agents

OFFICE ADDRESS
196 Havant Road, Drayton,
Portsmouth, Hampshire, PO6
2EH

CONTACT
023 9237 3341
drayton@jeffries.co.uk
www.jdea.co.uk