



**Price**  
**£240,000**  
**Leasehold**

2x  1x  2x 

**Baxter Avenue, Redhill,  
Surrey, RH1**

**OVER 60?**

Secure this property  
for up to **59% less!**

**cubitt & west**  
Helping you move forwards



## Main features

- Ground floor maisonette offering well-proportioned spacious accommodation
- Walking distance to town & stations, allocated parking
- Direct access to garden from lounge
- Open kitchen/dining area

## Accommodation

### GROUND FLOOR

Entrance Hall

Living Room: 12'9 x 12'3 (3.89m x 3.74m)

Dining Area: 12'2 x 6'5 (3.71m x 1.96m)

Kitchen: 8'9 x 8'8 (2.67m x 2.64m)

Bedroom 1: 14'8 x 11'3 (4.47m x 3.43m)

Bedroom 2: 12'5 x 9'6 (3.79m x 2.90m)

Bathroom

### OUTSIDE

Private Garden

Residents Parking

## Ground Floor

Approx. 67.1 sq. metres (721.7 sq. feet)

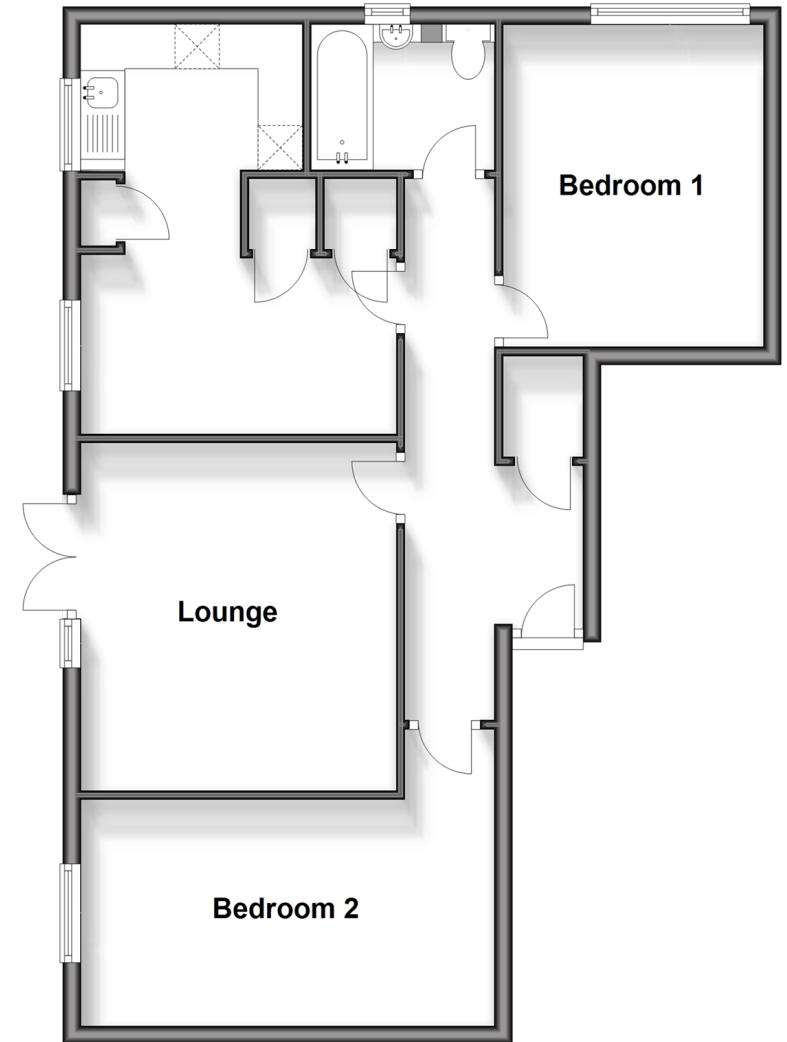

Call Redhill - 01737 778866 ■ [cubittandwest.co.uk](http://cubittandwest.co.uk)

- Legal advice should be taken to verify fixtures/fittings, planning, alterations and/or lease details
- Appliances & services are untested, dimensions are approximate and floor plans are not to scale
- Through a Homewise Home For Life Plan people aged 60+ can secure this property for up to 59% less, by purchasing a Lifetime Lease.



23411342/20241024/JU/JB2