

## Littlebrook Manor Way, Dartford, DA1

£1,250PCM (Deposit: £1,442)

🛏 2 🚿 1 🚗 1



Tax Band: Furnished:  
Not Specified

- Superb 2 bedroom, 2nd floor flat
- Bright reception with large windows
- Ample resident and visitor parking
- Fast rail links into London
- Near parks and green spaces
- Kitchen with natural light
- Covered private balcony
- Short distance to Dartford station
- Close to Dartford town centre
- Good access to A2 and M25

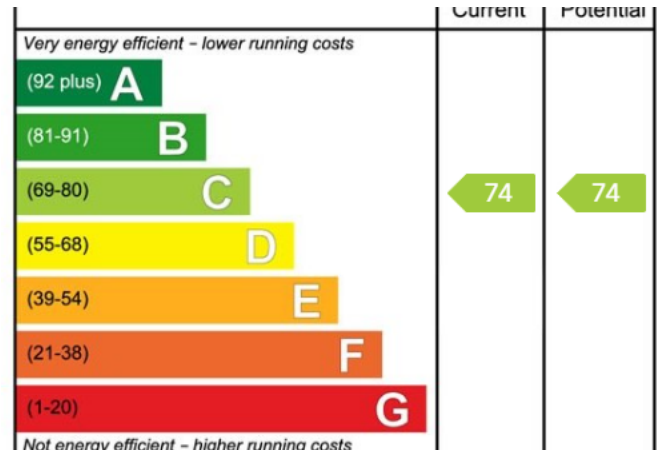

Patterson Court, Dartford, DA1

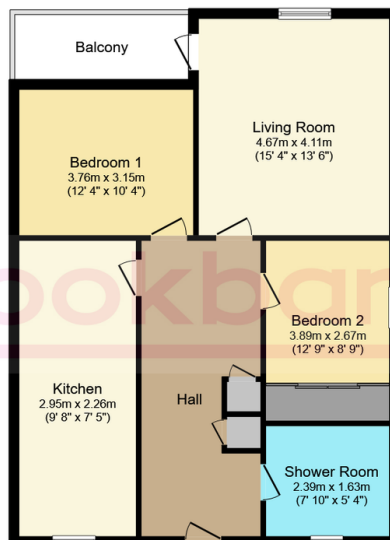

Floor Plan

Floor area 83.0 sq.m. (893 sq.ft.)

Total floor area: 83.0 sq.m. (893 sq.ft.)

This floor plan is for illustrative purposes only. It is not drawn to scale. Any measurements, floor areas (including any total floor area), openings and orientations are approximate. No details are guaranteed, they cannot be relied upon for any purpose and do not form any part of any agreement. No liability is taken for any error, omission or misstatement. A party must rely upon its own inspection(s). Powered by www.Propertybox.io

**Brookbanks**

A neutrally decorated second-floor two-bedroom flat in a purpose-built Dartford development, offering double bedrooms, a bright reception and kitchen, covered balcony, ample parking and strong transport links to London and Kent, close to local amenities, parks and schools.