

Abedare Gardens, South Hampstead, NW6

£3,000PCM (Deposit: £3,400)

🛏️ 2 🚿 2 🛋️ 1



	Current	Potential
Very energy efficient - lower running costs		
(92 plus) A		
(81-91) B		
(69-80) C		
(55-68) D	59	59
(39-54) E		
(21-38) F		
(1-20) G		
Not energy efficient - higher running costs		

Tax Band: F
Furnished:
Not specified

- **Prime Location:** Situated in the prestigious South Hampstead conservation
- **Spacious Living:** Bright and spacious reception room, perfect for relaxation and entertainment
- **Ensuite Bedrooms:** Each bedroom comes with its own modern ensuite bathroom.
- **Additional Guest Toilet:** Convenient separate guest toilet available.
- **Local Amenities:** Near Waitrose supermarket and the vibrant O2 Centre.
- **Period Conversion:** Located on the top floor of a charming period property.
- **Double Bedrooms:** Two generously-sized double bedrooms for comfort and privacy.
- **Contemporary Kitchen:** Fully fitted kitchen with modern appliances.
- **Excellent Transport Links:** Close to Finchley Road tube station (Metropolitan and Circle Lines Zone 2)
- **Available Now:** Part furnished, ready for immediate occupancy.

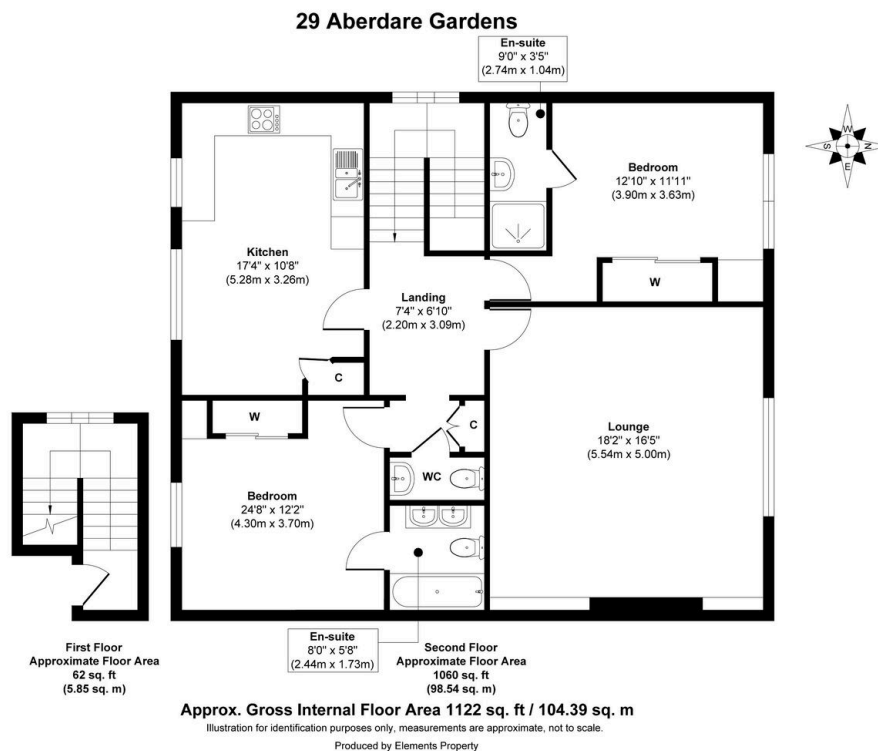

Stunning two double bedroom top-floor apartment in a period conversion located in South Hampstead. This bright and spacious property features a large reception room, modern kitchen, two ensuite bathrooms, and a separate guest toilet. Ideally situated near Finchley Road tube station and local amenities. Available now, part furnished.