



Apt 21 Larchwood, The Crescent

Guide Price £120,000

1 1 1

- First Floor Apartment
- One Double Bedroom with Fitted Furniture
- Central Location Close to Cheadle
- Accessible Shower Room
- Tenure - Leasehold / Council Tax Band - C / EPC - TBC
- Popular Retirement Development
- Residents Lounge & Laundry
- Residents Parking Available to be Rented
- Bright and Airy Lounge / Dining Space







GROUND FLOOR
456 sq.ft. (42.3 sq.m.) approx.

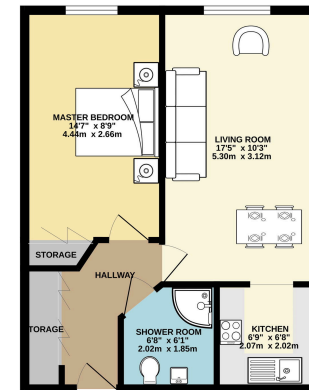

TOTAL FLOOR AREA - 456 sq.ft. (42.3 sq.m.) approx.
While every effort has been made to ensure the accuracy of the floor plan, the measurements of which are given, should be taken as approximate only. The actual measurements of the property may vary slightly from those given. The actual measurements of the property may vary slightly from those given. The actual measurements of the property may vary slightly from those given.

9 Gatley Road, Cheadle, Cheshire SK8 1LY Tel. 0161 428 1488 Fax. 0161 428 1479
Email. mail@andrewdawson.co.uk