



Actonville Avenue, Wythenshawe, Manchester, M22 9AN

£130,000

🛏 2 🚿 2 🛋 1

- Two Bedroom Apartment
- No Onward Vendor Chain
- Stylish Fitted Kitchen
- Three Piece Bathroom Suite
- EPC - C / Tenure - Leasehold / Council Tax Band - B
- Second Floor Position Within the Development
- Ideal Buy to Let Investment or First Time Buy
- Large Master Suite with En Suite
- Gated Development with Allocated Parking



A well proportioned two bedroom apartment OCCUPYING A SECOND FLOOR POSITION situated within a highly regarded GATED DEVELOPMENT within reasonable reach of GATLEY AND WYTHENSHAW CENTRE. The accommodation comprises of an entrance hallway with intercom and storage, a delightful contemporary open plan living area incorporating a superb fitted kitchen and two double bedrooms served by a three piece bathroom and en suite wash room. Allocated Off Road Parking. Offered for sale with no chain.





GROUND FLOOR
507 sq.ft. (47.1 sq.m.) approx.

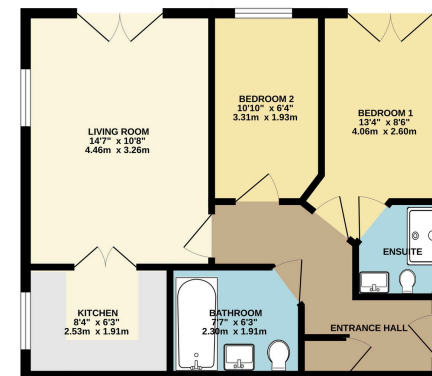

TOTAL FLOOR AREA: 507 sq.ft. (47.1 sq.m.) approx.
These figures are based on the best available information and are not intended to be a guarantee of accuracy. The actual area may vary slightly from the figures shown. The figures are for information only and are not intended to be a guarantee of accuracy. The actual area may vary slightly from the figures shown.

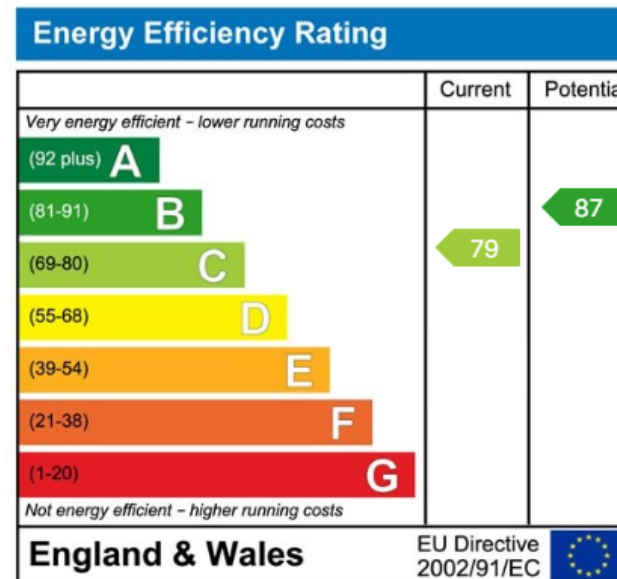

9 Gatley Road, Cheadle, Cheshire SK8 1LY Tel. 0161 428 1488 Fax. 0161 428 1479
 Email. mail@andrewdawson.co.uk