



## Hilton Road, Sharston

Offers In Region Of £269,950

🛏️ 2 🚿 1 🚗 2

- Modern End Mews
- Extensive Off Road Parking
- Two Bedrooms
- Three Piece Family Bathroom
- Modern Kitchen Diner
- Spacious Lounge
- Popular Location
- Close to Gatley Village
- Viewing Essential
- Tenure - Leasehold / EPC - C / Council Tax Band - C



A fantastic MODERN END MEWS offered for sale with NO ONWARD VENDOR CHAIN situated on the popular JONES HOMES ESTATE within easy reach of GATLEY VILLAGE. The accommodation comprises of an entrance porch, a spacious lounge with bay window, a stylish modern dining kitchen with patio doors. The first floor reveals two double bedrooms with space for fitted furniture served by a three piece bathroom suite. Externally, there is a superb lawn garden and a large driveway providing off road parking for a number of vehicles.





GROUND FLOOR  
309 sq ft (28.7 sq m) approx.

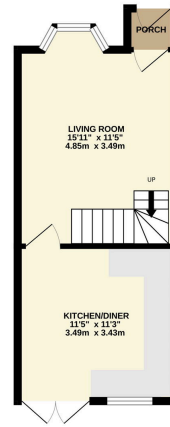

1ST FLOOR  
337 sq ft (31.3 sq m) approx.

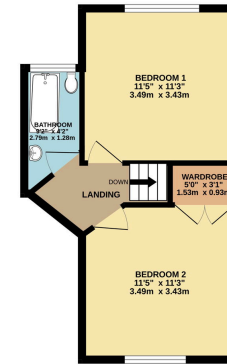

TOTAL FLOOR AREA: 646 sq ft (60.0 sq m) approx.  
 All floor areas are based on the finished floor level. Measurements are taken to the internal face of walls and doors. The area of any external porches, patios, balconies, etc. is not included in the total floor area. The area of any external porches, patios, balconies, etc. is not included in the total floor area. The area of any external porches, patios, balconies, etc. is not included in the total floor area. The area of any external porches, patios, balconies, etc. is not included in the total floor area.

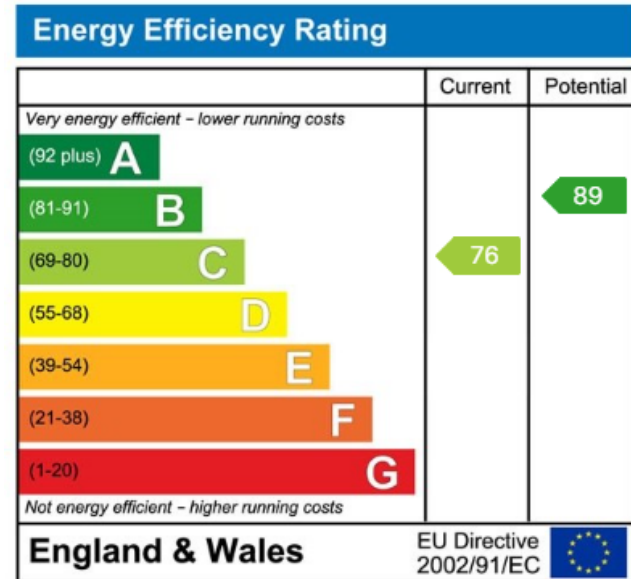

9 Gatley Road, Cheadle, Cheshire SK8 1LY Tel. 0161 428 1488 Fax. 0161 428 1479  
 Email. [mail@andrewdawson.co.uk](mailto:mail@andrewdawson.co.uk)