



Wildwood Close, Great Moor

Guide Price £74,950

🛏️ 2 🪑 1 🚗 1

- Two Bedroom Apartment
- Allocated Parking
- Great Moor Location
- Three Piece Bathroom Suite
- Viewing Essential
- Ground Floor Position
- 50% Shared Ownership
- Close to Woodsmoor Station
- Well Proportioned Throughout
- EPC - TBC / Tenure - Leasehold / Council Tax Band - A





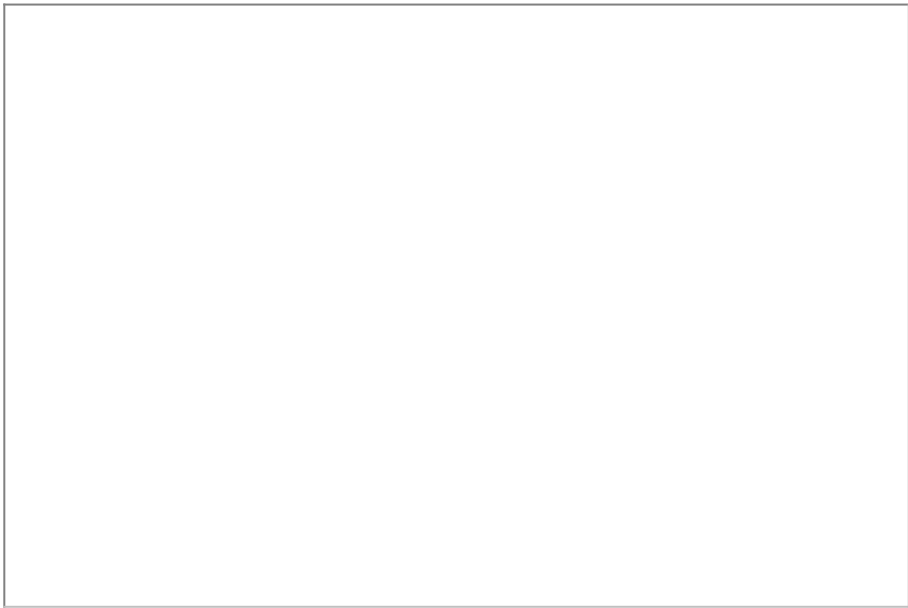

GROUND FLOOR
539 sq.ft. (50.1 sq.m.) approx.

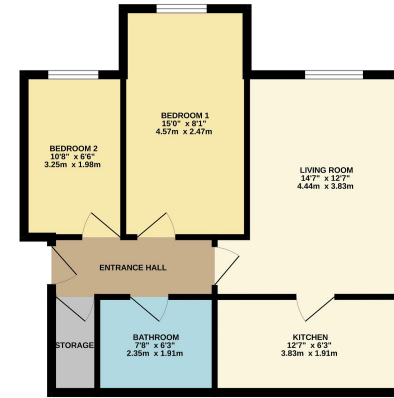

TOTAL FLOOR AREA: 539 sq.ft. (50.1 sq.m.) approx.
While every effort has been made to ensure the accuracy of the above information, measurements are taken from the floor to ceiling and are approximate. The actual area may vary slightly from the above. The architect, engineer and contractor accept no liability for any errors or omissions. The architect, engineer and contractor accept no liability for any errors or omissions. The architect, engineer and contractor accept no liability for any errors or omissions.

