



Andrew J.
Dawson
Independent Estate Agents

Millom Place, Gatley, Cheadle

Offers In Region Of £425,000

🛏 3 🚗 2 🛋 2

- Detached Bungalow
- Excellent Large Garden Plot
- Gatley Location
- Three Bedrooms
- Master Suite with Shower Room
- Conservatory Overlooking Gardens
- Stylish Kitchen
- Open Plan Lounge Diner
- Off Road Parking
- Garage



VIDEO TOUR AVAILABLE - A superb DETACHED BUNGALOW with a LARGER THAN AVERAGE GARDEN PLOT, situated on a QUIET CUL DE SAC located within a SHORT WALK OF GATLEY VILLAGE CENTRE. The accommodation comprises of an entrance hallway opening through to an open plan lounge diner, stylish fitted kitchen, beautiful conservatory, centrally positioned hallway with storage cupboards & three double bedrooms served by a stylish family bathroom suite and an en suite shower room. Externally, there is a driveway leading to a garage offering secure off road parking. To the rear is a great manicured garden with stone flagged patio areas and a large lawn garden beyond.





GROUND FLOOR
1228 sq.ft. (114.1 sq.m.) approx.

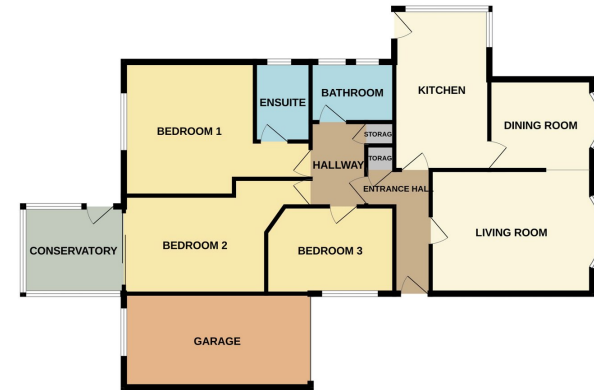

TOTAL FLOOR AREA : 1228 sq.ft. (114.1 sq.m.) approx.
While every attempt has been made to ensure the accuracy of the floorplan contained here, measurements of floor, ceiling, rooms and any other items are approximate and no responsibility is taken for any error, omission or misstatement. The plan is for illustrative purposes only and should be used as a guide by the prospective purchaser. The architect, designer or quantity surveyor does not warrant, warrant and no guarantee is made with reference to the plan.

