



Grasmere Road, Gatley

Offers In Region Of £360,000

 3  1  3

- DETACHED BUNGALOW.
- LARGE SIDE EXTENSION.
- DETACHED GARAGE.
- SUPERB LOCATION CLOSE TO CHEADLE AND GATLEY.
- WELCOMING ENTRANCE HALLWAY.
- THREE BEDROOMS.
- CONSERVATORY.
- EXCELLENT ROOM PROPORTIONS THROUGHOUT.
- LANDSCAPED LAWN REAR GARDEN.
- OFFERED FOR SALE WITH NO CHAIN.



A charming THREE BEDROOM DETACHED BUNGALOW, situated on the highly sought after Lakes Estate within easy reach of BOTH CHEADLE AND GATLEY VILLAGES. The accommodation comprises of a entrance hallway opening to the kitchen and large lounge, dining room, conservatory, three double bedrooms served by a three piece family bathroom suite. Externally, there is a superb landscaped garden with detached garage. Offered for sale with no onward chain.



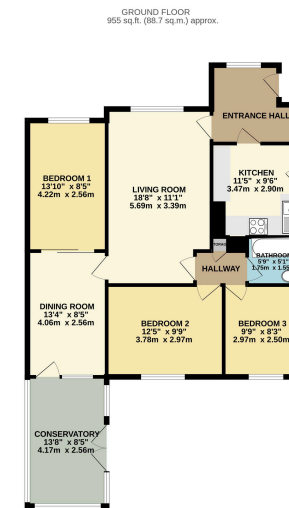

TOTAL FLOOR AREA: 955 sq.ft. (88.7 sq.m.) approx.
While every effort has been made to ensure the accuracy of the floorplan contained herein, representations, warranties, covenants or any other form of legal liability are not made by the agent or the advertiser for any errors, omissions or inaccuracies in the floorplan. The floorplan is provided for information only and should not be relied upon for any legal or financial purposes.

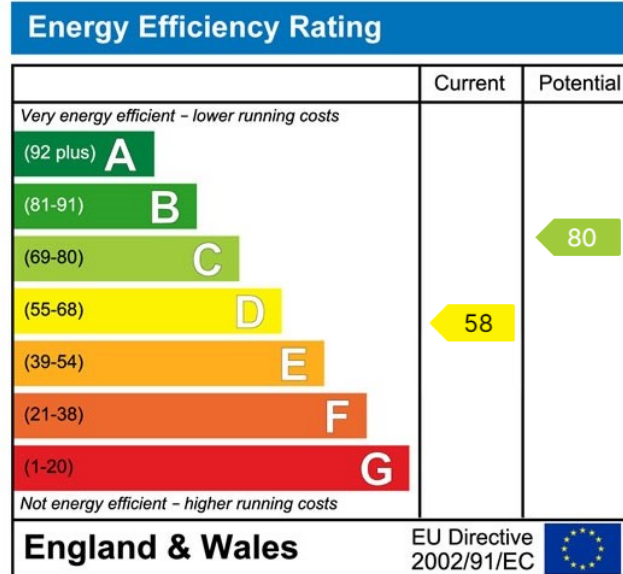

9 Gatley Road, Cheadle, Cheshire SK8 1LY Tel. 0161 428 1488 Fax. 0161 428 1479
Email. mail@andrewdawson.co.uk